

01 Proposed Section @ 1:25 (1:50 @ A3)
2101

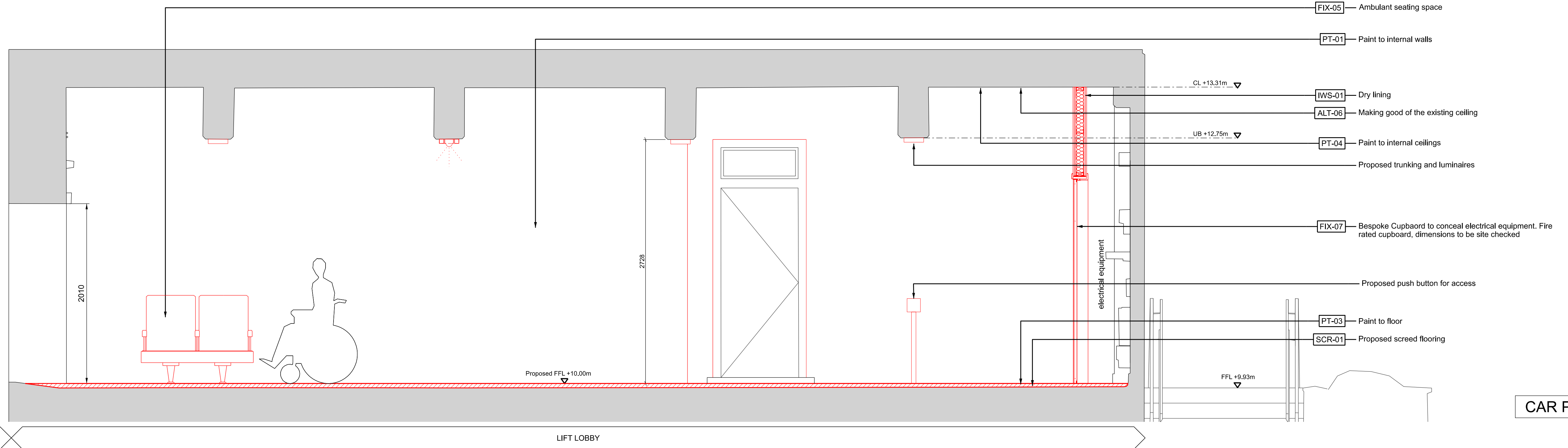

02 Proposed Section @ 1:25 (1:50 @ A3)
2101

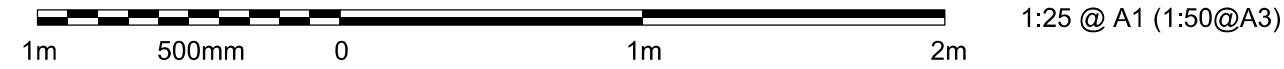

- General Notes:**
- Do not scale from drawing;
 - All dimensions in millimeters unless noted otherwise;
 - All drawings are to be read in colour;
 - Please refer to outline Specification.
 - All dimensions and levels based on existing survey information. All dimensions and levels to be validated at Contractor's Detailed design stage and prior to Construction;
 - All setting out to be confirmed by Contractor for approval by SWR Design Manager for co-ordination with specialist suppliers. The Contractor is to notify the design team of any discrepancies.
 - Drawing shows design intent and indicative detail for Planning Submission only. Further development required by Design Team and Contractor.
 - Refer to project risk register. SHE boxes have been excluded from this issue.
 - Fire strategy subject to further detail design. Assumptions have been made for this submission but designs will incorporate detailed strategy at later stage.
 - Telecoms (CCTV, PA etc.) strategy subject to further detail design. Further detail will be incorporated at a later stage.

Legend:

Level on plan	+
Existing	—
Proposed Works	—
Demolition Works	---
Station Ownership Boundary as per NR Title Plan	—

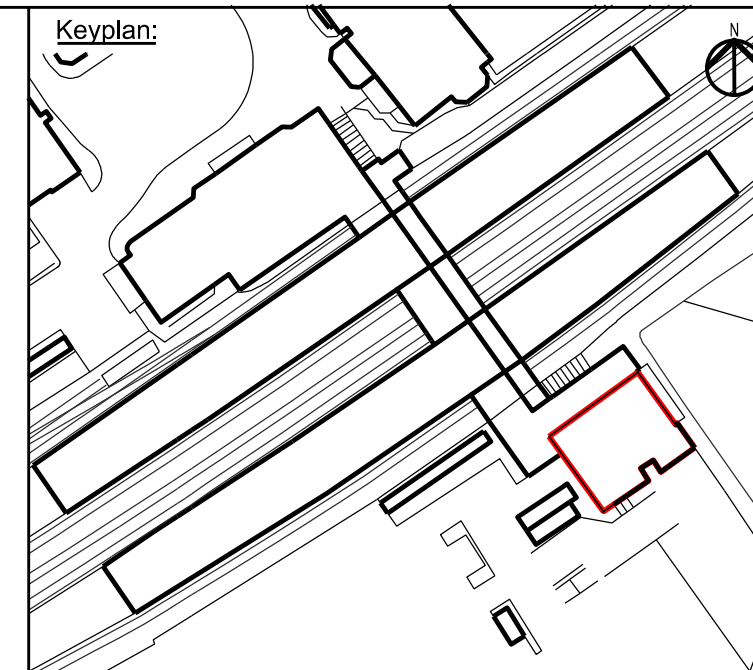

Architect:
WestonWilliamson+Partners
 12 Valentine Place
 London
 SE1 8QH
 Tel +44(0) 20 7401 8877
 www.westonwilliamson.com

Project:
 Mid-Tier South Western Railways Projects
Title:
 Surbiton Station
 Proposed Sections A-A & B-B

Scale:	Date:	Drawn:	Checked:	Approved:
1:50 @ A1	20/03/24	SSIL	JBB	RR
Status: Planning Submission				
Drawing Number: 1019-WWP-SUR-00-SE-A-2101				Revision: B02