

STATION ENTRANCE

Dotted line represents canopy above

MH

MH

Tactile paving

FFL +9.95m

FFL +9.95m

STATION CARS  
(NO ACCESS)

CCTV

MH

Accessible route from Station Entrance

Future comprehensive works to route around building proposed in separate future application by others.

Boundary between pedestrian path and road

Existing TVM relocated from First Floor Concourse

DOWNSIDE BOOKING HALL (DISUSED)

01  
2001

BOOTH

MH

DRT-02 Proposed internal door

Road sign

Retaining wall

IWS-06 Internal partition wall to conceal original timber and glazed wall assemblage

Proposed push to open button

HF-04 Entrance Matwell

Proposed push to open button

TRACK SIDE

STEPS TO PLATFORMS

DOWNSIDE BOOKING OFFICE (DISUSED)

01  
2002

FFL +10.07m

FFL +9.88m

FFL +9.90m

Proposed entrance door to match existing east elevation entrance door

FIX-06 Proposed canopy above entrance

Existing stair to be relocated as part of future comprehensive works to route around building proposed by others.

FIX-07 Bespoke Cupboard to conceal electrical equipment

PT-03 Paint to floor

SCR-01 Proposed new screed flooring with anti slip paint finish

Existing Tactile paving

Internal door DRT-02

BACK OF HOUSE (DISUSED)

01  
2003

FFL +10.06m

FFL +10.00m

FFL +9.93m

CAR PARK

Proposed internal ramp to ensure accessible access for BOH areas

Ambulant seating space FIX-05

Internal partition wall IWS-01

Cubic Wide Aisle Gate (WAG) Ticket Gate FIX-08

Existing SWR ticket gate to be reused

Proposed partition wall to be centred on beam above

LIFT

LIFT LOBBY

FFL +10.00m

FFL +10.01m

electrical equipment

electrical equipment

01  
4015

FFL +10.00m

01  
4030

FFL +9.67m

FFL +8.62m

ALT-04 Making good of the existing windows

PT-02 Paint to joinery and window frames

01 Proposed Ground Floor Plan @ 1:50 (1:100 @ A3)

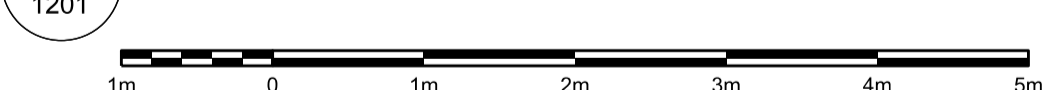

1:50 @ A1 (1:100 @ A3)

Legend:

- Level on plan
- Existing
- Proposed Works
- Demolition Works
- Station Ownership Boundary as per NR Title Plan

General Notes:

- Do not scale from drawing;
- All dimensions in millimeters unless noted otherwise;
- All drawings are to be read in colour;
- Please refer to outline Specification.
- All dimensions and levels based on existing survey information. All dimensions and levels to be validated at Contractor's Detailed design stage and prior to Construction;
- All setting out to be confirmed by Contractor for approval by SWR Design Manager for co-ordination with specialist suppliers. The Contractor is to notify the design team of any discrepancies.
- Drawing shows design intent and indicative detail for Planning Submission only. Further development required by Design Team and Contractor.
- Refer to project risk register. SHE boxes have been excluded from this issue.
- Fire strategy subject to further detail design. Assumptions have been made for this submission but designs will incorporate detailed strategy at later stage.
- Telecoms (CCTV, PA etc.) strategy subject to further detail design. Further detail will be incorporated at a later stage.

Keyplan:

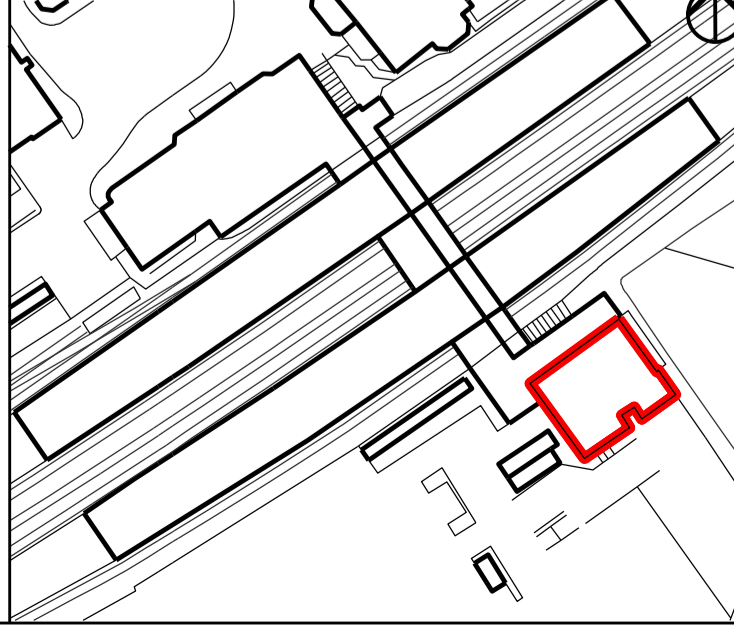

Architect:

WestonWilliamson+Partners

12 Valentine Place  
London  
SE1 8QH  
Tel +44(0) 20 7401 8877  
www.westonwilliamson.com

Rev	Date	Description	Drawn	Check	Approv
B02	20/03/2024	Updated based on initial Planning comments	SSIL	JBB	RR
B01	08/03/2024	Planning Submission	SSIL	JBB	RR

Project:				
Mid-Tier South Western Railways Projects				
Title: Surbiton Station Proposed Ground Floor Plan				
Scale: 1:50 @ A1	Date: 20/03/24	Drawn: SSIL	Checked: JBB	Approved: RR
Status: Planning Submission				
Drawing Number: 1019-WWP-SUR-00-GA-A-1201				Revision: B02