

01
3002 Proposed Downside South East/Side Elevation @ 1:50 (1:100 @ A3)

1m 0 1m 2m 3m 4m 5m 1:50 @ A1 (1:100@A3)

Legend:

◆	Level on plan
—	Existing
—	Proposed Works
- - -	Demolition Works
—	Station Ownership Boundary as per NR Title Plan

General Notes:

- Do not scale from drawing;
- All dimensions in millimeters unless noted otherwise;
- All drawings are to be read in colour;
- Please refer to outline Specification.
- All dimensions and levels based on existing survey information. All dimensions and levels to be validated at Contractor's Detailed design stage and prior to Construction;
- All setting out to be confirmed by Contractor for approval by SWR Design Manager for co-ordination with specialist suppliers. The Contractor is to notify the design team of any discrepancies.
- Drawing shows design intent and indicative detail for Planning Submission only. Further development required by Design Team and Contractor.
- Refer to project risk register. SHE boxes have been excluded from this issue.
- Fire strategy subject to further detail design. Assumptions have been made for this submission but designs will incorporate detailed strategy at later stage.
- Telecoms (CCTV, PA etc.) strategy subject to further detail design. Further detail will be incorporated at a later stage.

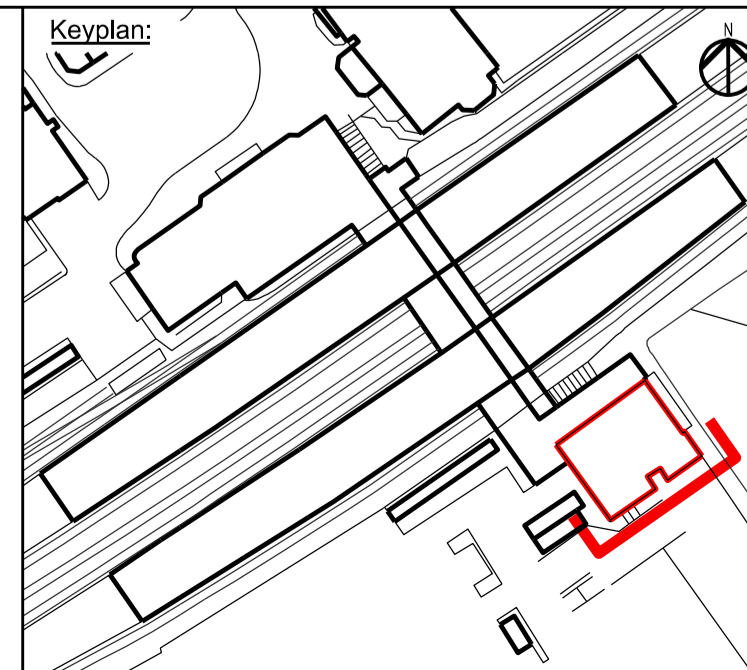

Architect:
WestonWilliamson+Partners
12 Valentine Place
London
SE1 8QH
Tel +44(0) 20 7401 8877
www.westonwilliamson.com

Rev	Date	Description	Drawn	Check	Approv
B02	20/03/2024	Updated based on initial Planning comments	SSIL	JBB	RR
B01	08/03/2024	Planning Submission	SSIL	JBB	RR

Project: Mid-Tier South Western Railways Projects				
Title: Surbiton Station Proposed Downside South East/Side Elevation				
Scale: 1:50 @ A1	Date: 20/03/24	Drawn: SSIL	Checked: JBB	Approved: RR
Status: Planning Submission				
Drawing Number: 1019-WWP-SUR-00-GA-A-3002				Revision: B02