

STATION ENTRANCE

MH

Dotted line shows outline of canopy above

MH

MH

CCTV

MH

FFL +9.95m

STATION CARS  
(NO ACCESS)

FFL +9.95m

DOWNSIDE BOOKING HALL (DISUSED)

BOOTH

BOOTH

MH

MH

MH

TRACK SIDE

STEPS TO PLATFORMS

DOWNSIDE BOOKING OFFICE (DISUSED)

FFL +10.07m

FFL +10.06m

FFL +10.06m

FFL +9.97m

FFL +9.91m

Boundary between pedestrian path and road

Road sign

Retaining wall

Yellow double line

Removal of the existing canopy above

DEM-10 Removal of the existing BOH door

Door frame to be removed and opening widened

Existing Tactile paving

ALT-01 Making good of the internal walls

ALT-02 Making good of the existing floor

ALT-04 Making good of the existing windows

Existing Tactile paving

BACK OF HOUSE (DISUSED)

11900

FFL +9.95m

LIFT

FFL +10.01m

6300

FFL +9.87m

FFL +8.62m

CAR PARK

Existing Beams above

01 Demolition Ground Floor Plan @ 1:50 (1:100 @ A3)

1101

1:50 @ A1 (1:100@A3)

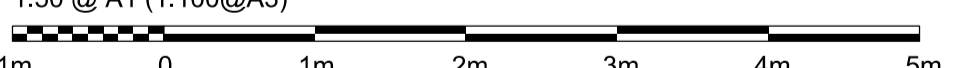

**Legend:**

- Level on plan
- Existing
- Proposed Works
- Demolition Works
- Station Ownership Boundary as per NR Title Plan

**General Notes:**

- Do not scale from drawing;
- All dimensions in millimeters unless noted otherwise;
- All drawings are to be read in colour;
- Please refer to outline Specification.
- All dimensions and levels based on existing survey information. All dimensions and levels to be validated at Contractor's Detailed design stage and prior to Construction;
- All setting out to be confirmed by Contractor for approval by SWR Design Manager for co-ordination with specialist suppliers. The Contractor is to notify the design team of any discrepancies.
- Drawing shows design intent and indicative detail for Planning Submission only. Further development required by Design Team and Contractor.
- Refer to project risk register. SHE boxes have been excluded from this issue.
- Fire strategy subject to further detail design. Assumptions have been made for this submission but designs will incorporate detailed strategy at later stage.
- Telecoms (CCTV, PA etc.) strategy subject to further detail design. Further detail will be incorporated at a later stage.

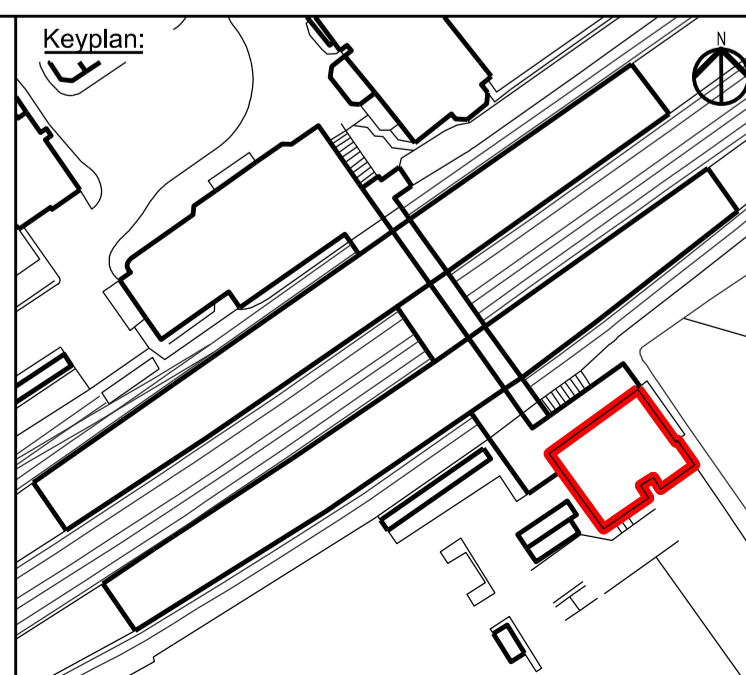

**Architect:**  
**WestonWilliamson+Partners**  
 12 Valentine Place  
 London  
 SE1 8QH  
 Tel +44(0) 20 7401 8877  
 www.westonwilliamson.com

Rev	Date	Description	Drawn	Check	Approv
B02	20/03/2024	Updated based on initial Planning comments	SSIL	JBB	RR
B01	08/03/2024	Planning Submission	SSIL	JBB	RR

Project:				
Mid-Tier South Western Railways Projects				
Title:				
Surbiton Station Demolition Ground Floor Plan				
Scale:	Date:	Drawn:	Checked:	Approved:
1:50 @ A1	20/03/24	SSIL	JBB	RR
Status:				
Planning Submission				
Drawing Number:				Revision:
1019-WWP-SUR-00-GA-A-1101				B02