

General Notes:

1. Any discrepancies between the information given by the planner, and that provided by others, must be referred to the planner before the affected works proceed.
2. Construction Stage Only: Dimensions must not be scaled from the planner's drawings unless during the planning stage by the council.
3. All dimensions are in millimetres unless noted otherwise.
4. Contractor to check ALL dimensions and report and discrepancies asap.
5. All setting out for main structural elements are subject to confirmation by site measurement before construction proceeds.
6. All works and materials used are to fully comply with ALL standards required by the relevant trade associations, British Standard Codes of Practice, Manufacturer's Specifications (BBA Certification, etc).
7. Where applicable, all warranties/insurances should be provided to the end client.
8. All works are to be carried out in full accordance with any Structural Engineer's calculations, details and instructions as and where applicable.

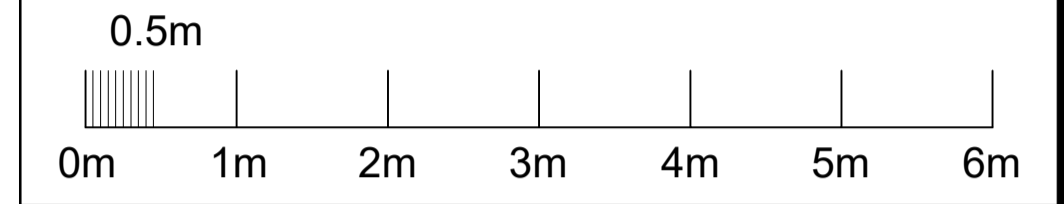

Scale Bar (1:50)

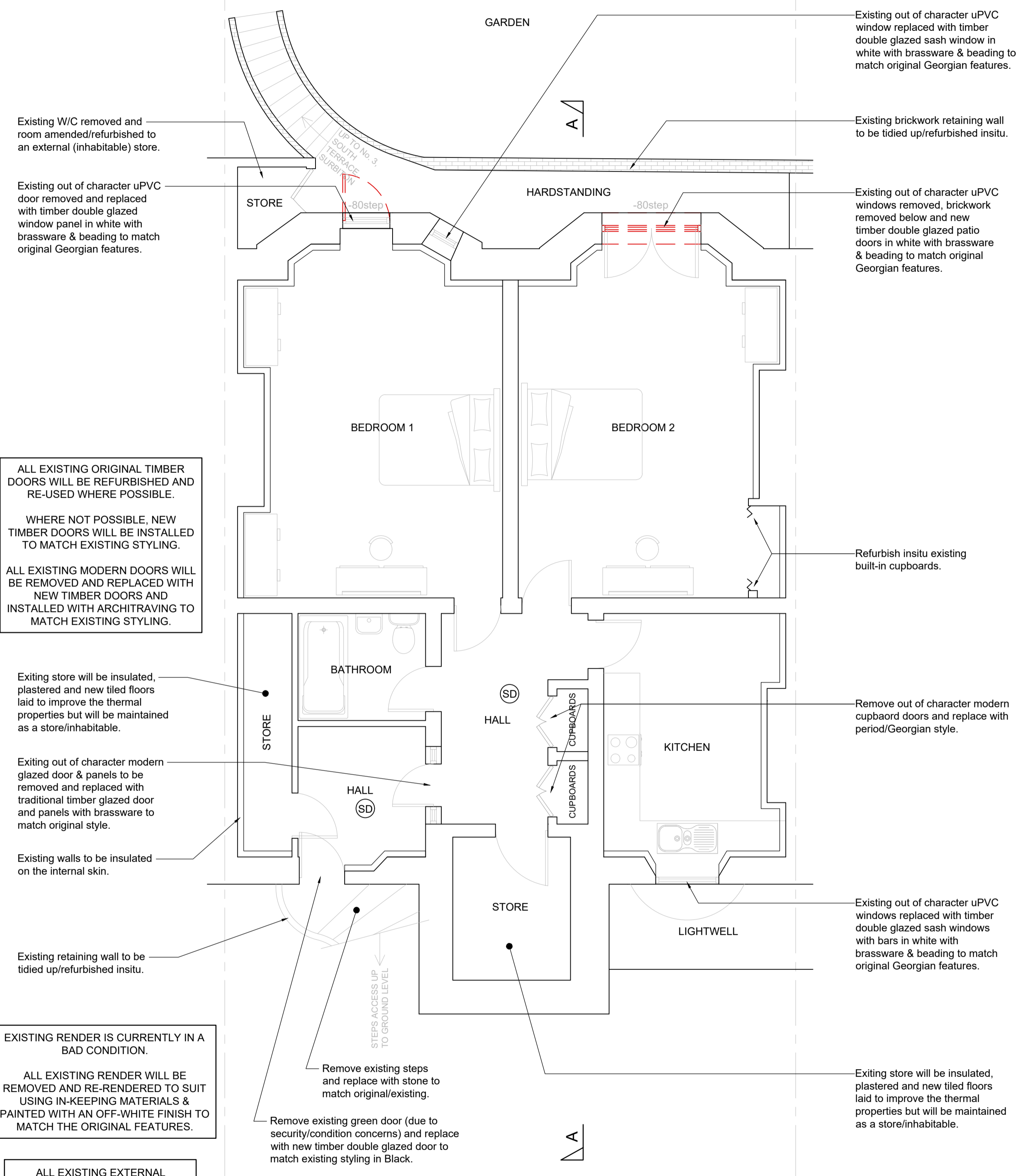

ALL EXISTING ORIGINAL TIMBER DOORS WILL BE REFURBISHED AND RE-USED WHERE POSSIBLE.

WHERE NOT POSSIBLE, NEW TIMBER DOORS WILL BE INSTALLED TO MATCH EXISTING STYLING.

ALL EXISTING MODERN DOORS WILL BE REMOVED AND REPLACED WITH NEW TIMBER DOORS AND INSTALLED WITH ARCHITRAVING TO MATCH EXISTING STYLING.

EXISTING RENDER IS CURRENTLY IN A BAD CONDITION.

ALL EXISTING RENDER WILL BE REMOVED AND RE-RENDERED TO SUIT USING IN-KEEPING MATERIALS & PAINTED WITH AN OFF-WHITE FINISH TO MATCH THE ORIGINAL FEATURES.

ALL EXISTING EXTERNAL FRONT/REAR ELEVATION STONE FEATURES WILL BE MAINTAINED.

**PROPOSED LOWER GROUND FLOOR LAYOUT**  
**1:50@A1**

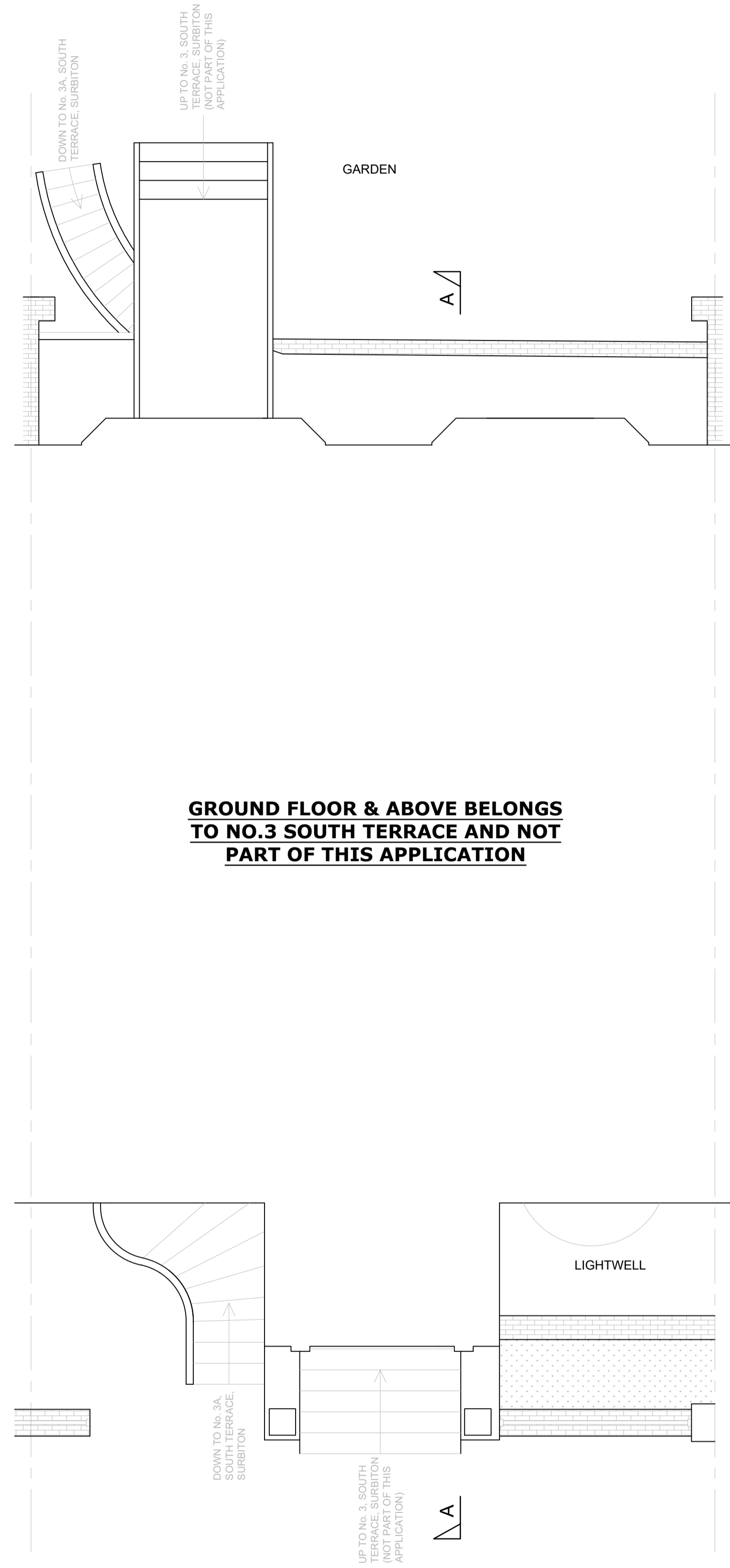

**PROPOSED GROUND FLOOR LAYOUT**  
**1:50@A1**

P1	A	28.03.24	ISSUED FOR PLANNING/ LISTED BUILDING CONSENT	BP	AES
REV	STATUS	DATE	DESCRIPTION	BY	CHK



LONDON . ESSEX . SURREY . SUFFOLK . KENT

ARCHITECTURAL SERVICES

Colchester Office 01206 259 360 / 07708 446 575  
London Office 0204 534 5593 / 07738 439 500  
Email: office@morganeng.co.uk  
Web: www.morganeng.co.uk

Client:  
**CLAREMONT DESIGN BUILD**

Project:  
**3A SOUTH TERRACE, SURBITON**

Drawing Title:  
**PROPOSED LAYOUTS**

Drawn by: BP	Checked by: AES	Date: MARCH 2024	Scale at A1: AS SHOWN
-----------------	--------------------	---------------------	--------------------------

Issue Status:  
**FOR APPROVAL**

Ref: <b>2402-16-A-05</b>	Rev: <b>P1</b>
-----------------------------	-------------------