

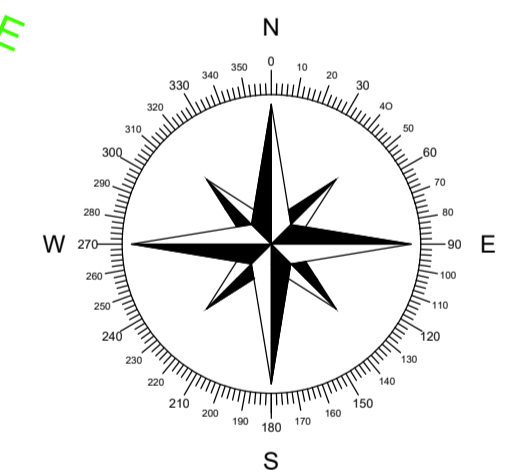

SEE "ADDITIONAL AREA" BELOW VIEWPORT FOR FURTHER DETAILS

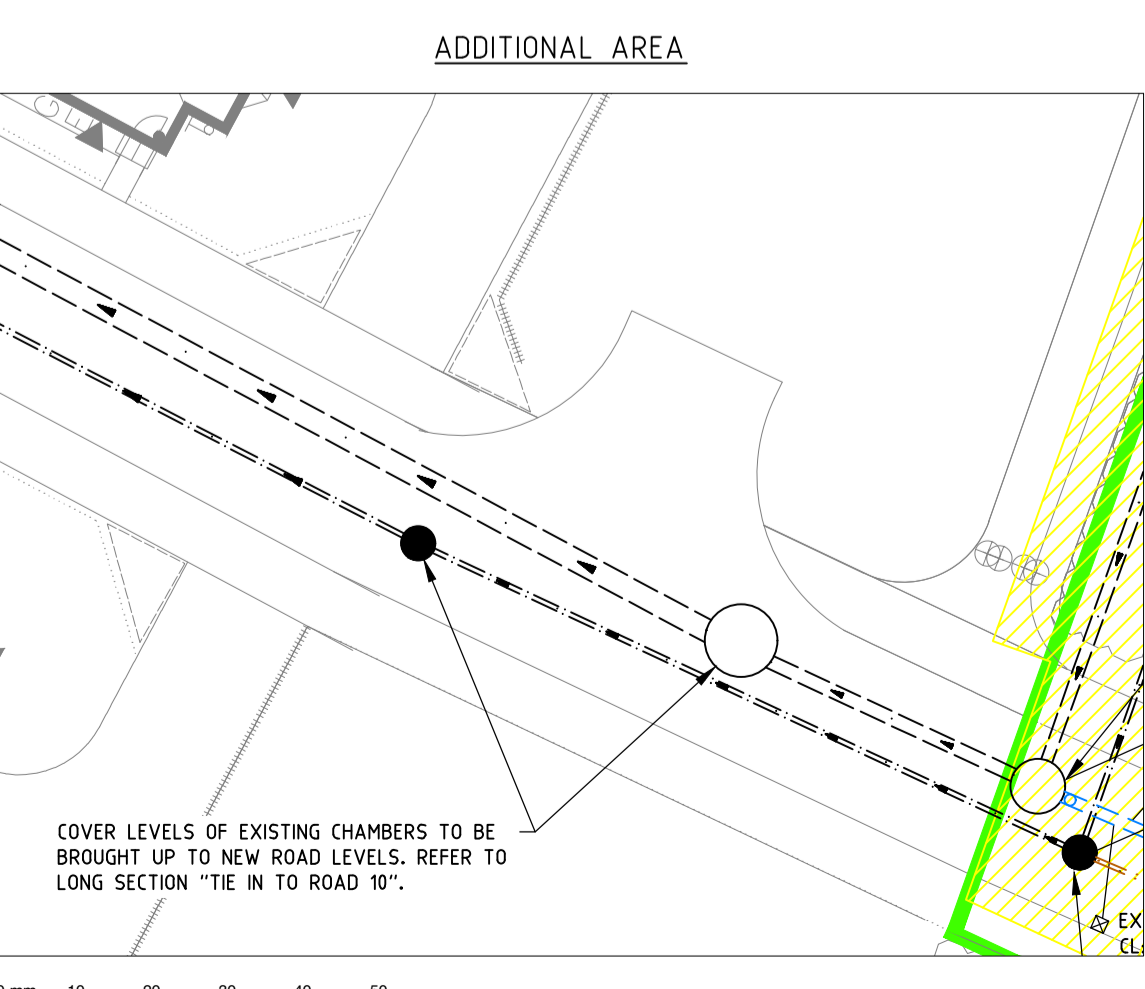
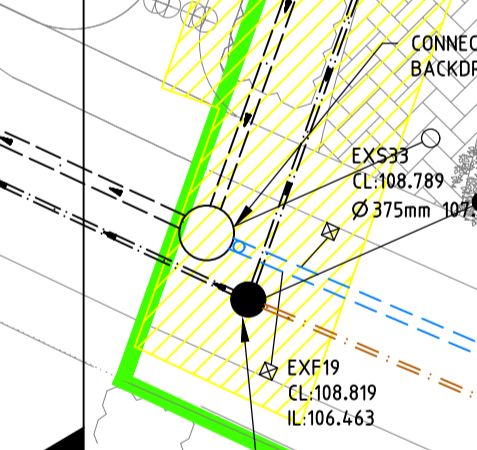

**NOTES:**

- ALL SEWERS ARE DESIGNED IN ACCORDANCE WITH SEWERS FOR ADOPTION 6TH EDITION AND UNITED UTILITIES GUIDELINES AND STANDARD DETAILS.
- ALL CO-ORDINATES AND LEVELS SHOWN ARE RELATIVE TO THE TOPOGRAPHIC SURVEY, RSK DRAWING NUMBER 29294191-T-01 DATED 25.03.2014.
- IT IS THE RESPONSIBILITY OF THE CONTRACTOR TO ENSURE THE LINE AND LOCATION OF ANY EXISTING SEWERS, AS WELL AS ANY EXISTING GROUND AND INVERT LEVELS SHOWN ON THE DRAWING ARE CORRECT PRIOR TO THE COMMENCEMENT OF ANY WORKS. ANY DISCREPANCIES MUST BE MUST BE REPORTED IMMEDIATELY.
- PRIOR TO THE COMMENCEMENT OF ANY ON SITE WORKS THE CONTRACTOR MUST CONTACT THE STATUTORY UNDERTAKER AND BE IN POSSESSION OF THE LATEST DRAWINGS SHOWING THEIR APPARATUS.
- IT IS THE RESPONSIBILITY OF THE CONTRACTOR TO ALLOW FOR THE SUPERVISION OF THE CONSTRUCTION WORKS BY UNITED UTILITIES AND/ OR THE HIGHWAYS AUTHORITY. THE CONTRACTOR WILL NOTIFY THE SUPERVISING OFFICER GIVING NOTICE WHICH WILL BE IN ACCORDANCE WITH THE AUTHORITIES REQUIREMENTS.
- THE PROPOSED SEWERS WILL BE CLAY PIPE WORK AND SHALL BE EXTRA STRENGTH TO BS EN 295:1991 PART 1.
- ANY PVC PIPE WORK WILL BE IN ACCORDANCE WITH BS EN 1916:2002.
- ALL MANHOLES AND CHAMBERS SHALL BE IN ACCORDANCE WITH BS EN 1917:2002.
- ANY SEWER FOR ADOPTION WITH COVER TO SOFFIT GREATER THAN 1.2m IN ROADS AND 0.9m IN FIELDS SHALL HAVE GRANULAR CLASS 5 BED AND SURROUND.
- ANY SEWER FOR ADOPTION WITH A COVER OF LESS THAN 1.2m TO PIPE SOFFIT IN ROADS OR 0.9m TO PIPE SOFFIT IN FIELDS WILL HAVE A MINIMUM 150mm GEN 3 CONCRETE BED AND SURROUND WITH FLEXIBILITY MAINTAINED WITH FLEXCELL EXPANSION JOINT FILLER OR SIMILAR APPROVED AT EACH PIPE JOINT.
- PRIVATE DRAINAGE CONNECTIONS TO THE SEWER WILL BE 150MM DIAMETER AND LAID TO THE SPECIFIED INVERT.
- THE INVERT LEVELS SPECIFIED AT THE DRAG OUT CHAMBER ARE INCOMING LEVELS.
- WHEREVER POSSIBLE PRIVATE DRAINAGE RUNS WILL REMAIN WITHIN THE CURTILAGE OF THE DWELLING FOR WHICH THEY SERVE.
- THE CONNECTION TO THE ADOPTABLE SEWER SHALL BE MANUFACTURED JUNCTION PIPES A SADDLE CONNECTION IS NOT PERMITTED UNLESS IT IS CLEARLY SPECIFIED.
- CONNECTIONS TO THE EXISTING SEWER WILL BE IN ACCORDANCE WITH SECTION 104 APPROVAL GRANTED BY UNITED UTILITIES.

**KEY:**

- PROPOSED SW SEWER
- PROPOSED FW SEWER
- EXISTING SW SEWER
- EXISTING FW SEWER
- PROPOSED SW DRAGOUT
- PROPOSED FW DRAGOUT
- PROPOSED GULLY
- EXISTING DRAINAGE EASEMENT

**LAYOUT LOCATION**  
NOT TO SCALE

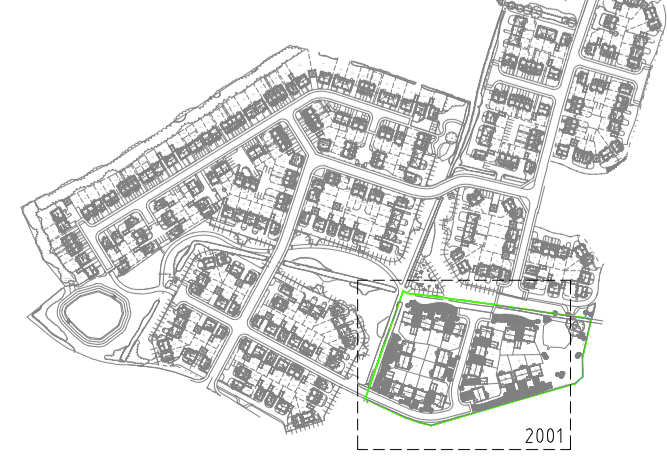

<p>P03 07.02.24 Updated to latest site layout H.S. R.A.          P02 15.01.23 Updated to latest site layout J.C. R.A.          P01 07.11.23 PRELIMINARY - Issued for Information H.S. R.A.</p>			
Rev	Date	Description	By
<p><b>EDGE CONSULTING ENGINEERS</b> Manchester, UK          3rd Floor, Cornovon Court,          12 Blackfriars Street,          Manchester, M3 8BQ,          United Kingdom          T: +44 (0) 161 834 1938          E: manchester@edgece.com          www.edgece.com</p>			
<p>The concepts + information contained in this document are the copyright of EDGE Consulting Engineers. Use or copying of this document in whole or in part without the written permission of EDGE Consulting Engineers constitutes an infringement of copyright.  <b>DO NOT SCALE DRAWINGS. IF IN DOUBT, ASK!</b></p>			
<p>Project Name:  <b>LEE HALL WESTHOUGHTON</b></p>			
<p>Client:  <b>CHARLES CHURCH</b></p>			
Designed	Drawn	Checked	Scale @ A1
H.S.	H.S.	R.A.	1:250
<p>Drawing Title:  <b>DRAINAGE LAYOUT</b></p>			
<p>Project No:  <b>19358</b></p>			
<p>Drawing No. <b>19358-EDGE-CC-XX-DR-C-2001</b> P03</p>			
<p style="text-align: right;"><b>PRELIMINARY</b> NOT FOR CONSTRUCTION</p>			