

03 Cycle Rack Detail
70-01 Scale: 1:20

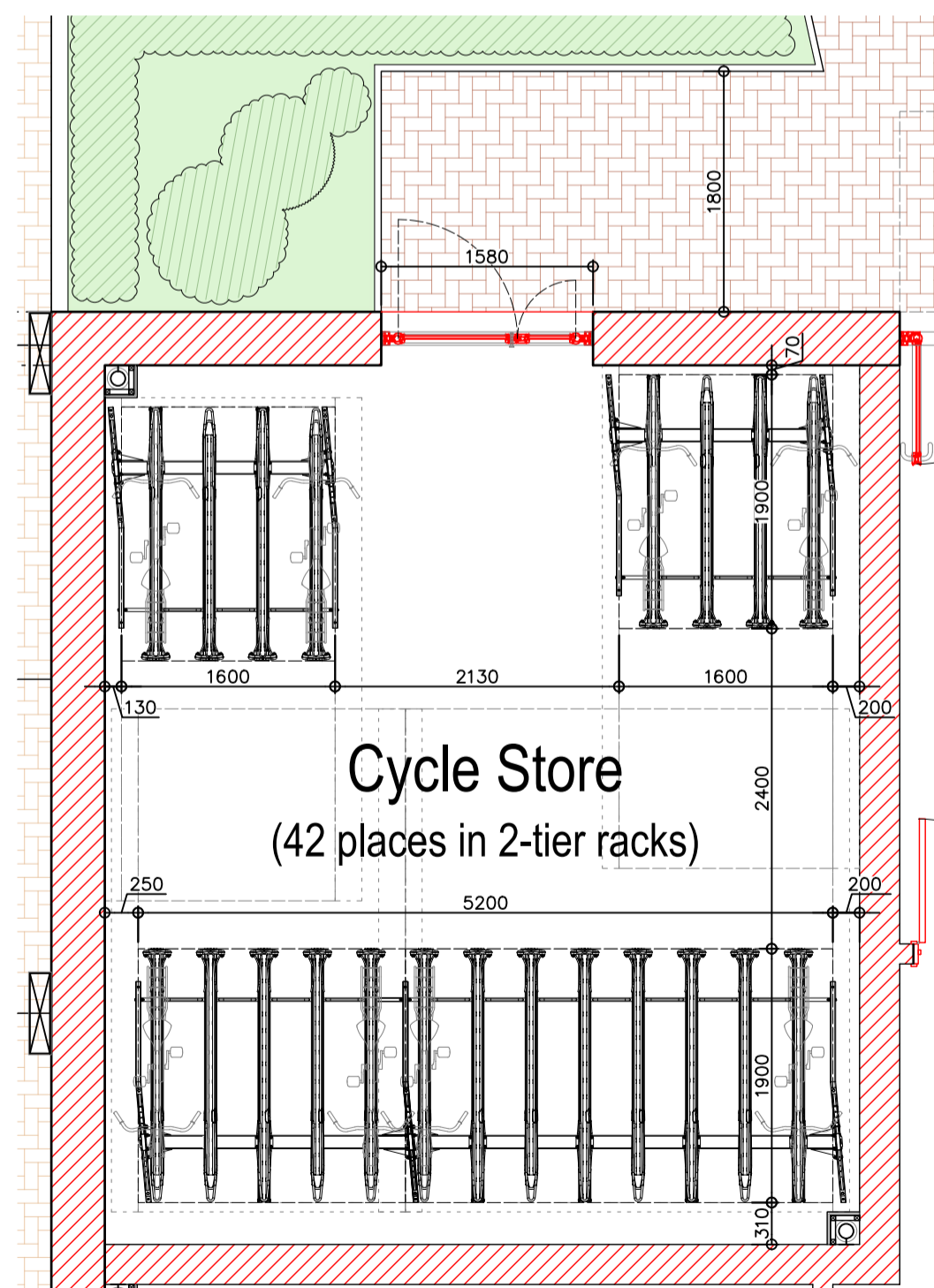

02 Phase 2 Cycle Store
70-01 Scale: 1:50

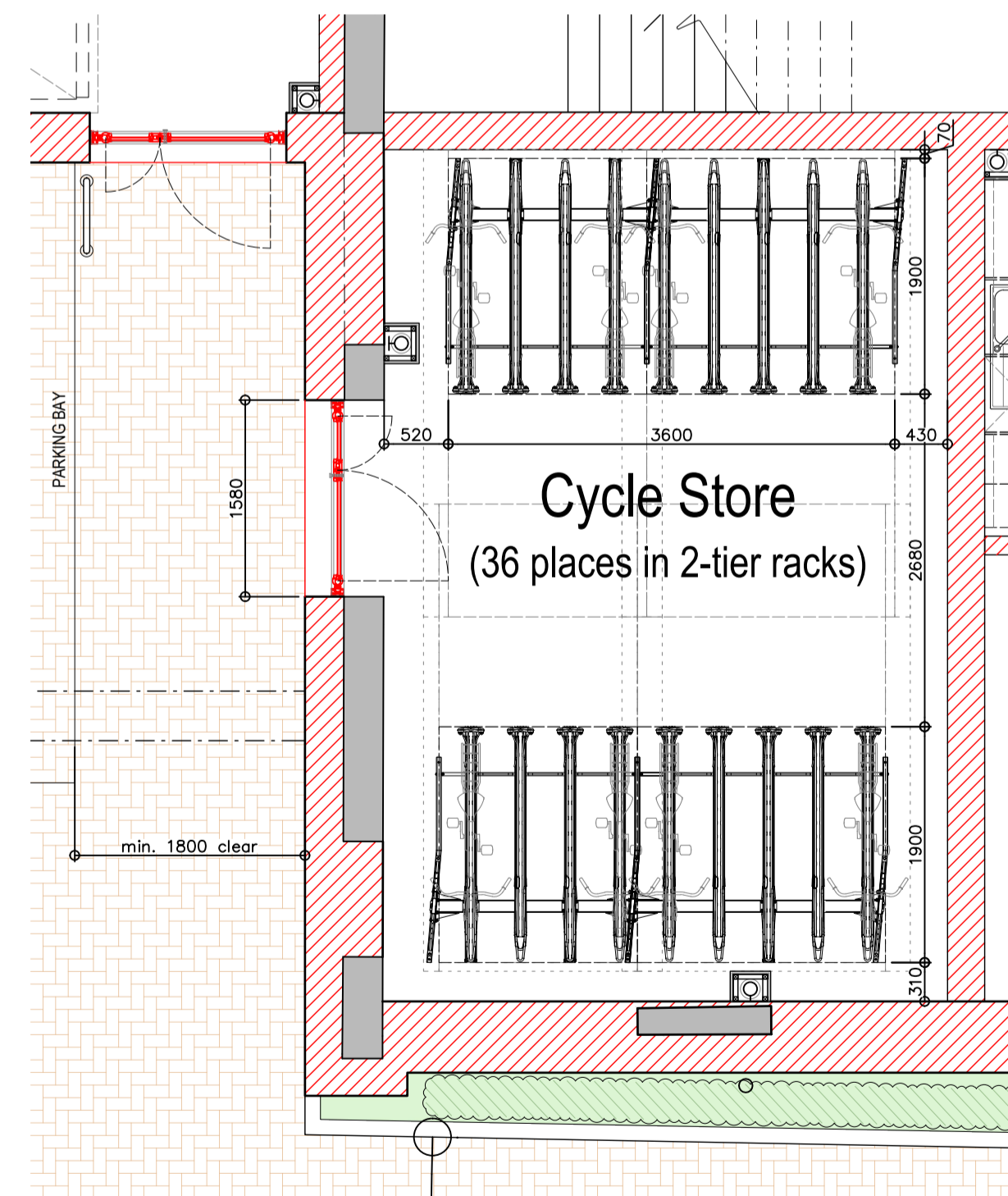

01 Phase 1 Cycle Storage
70-01 Scale: 1:50

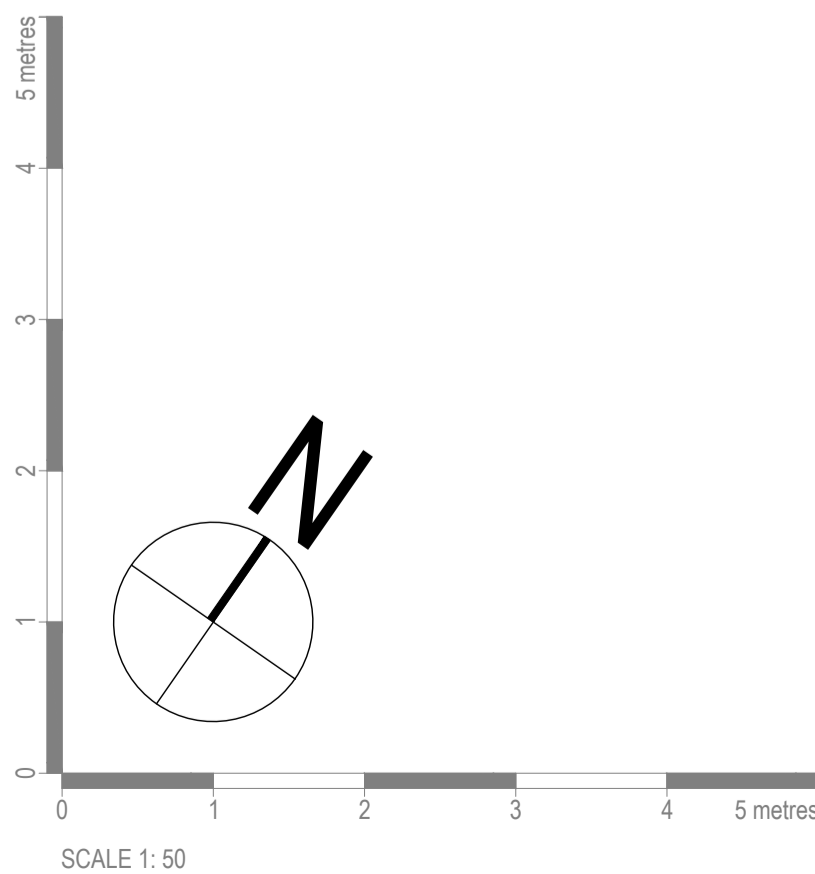

NOTES

- Alterations to existing buildings are based on informed assumption only, taken from available information, and pending a structural survey including opening up of existing walls, floors and ceilings to determine true site conditions.

Date	Rev	Descriptions	Drawn	Checked
22-03-2024	A	First issue. Issued for outline planning consent.	RB	MH

barefoot & gilles

Third Floor, Eldon House
2 Eldon Street, London, EC2M 7LS
Tel: 020 7422 7800

Nine Hills Road,
Cambridge, CB2 1GE
Tel: 01223 653068

2 Cromwell Court, 16 St. Peters Street
Ipswich, Suffolk IP1 1XG
Tel: 01473 257474

design@barefootgilles.com www.barefootgilles.com

Project Clacton College Site
Clacton-on-Sea CO15 6JQ

Client Marble Arch Group Limited

Drawing Cycle Store Layouts

Scale & Format 1:50 @A1 11-03-2024

BGA Drawing No. 2248-DE-70-01

BIM Model File N/A

Drawing Status PLANNING

PROJECT NO.	STATUS	TYPE	DWG NO.
example 1234	SK = Sketch DE = Planning PI = Production Information	15- Site / External Plans 20- Floor / Roof Plans 30- Elevations 40- Sections 50- Details 60- Schedules 70- Room Layouts	example 01

DISCLAIMER
This drawing was prepared for the Client, Project & Site stated below and for the purposes set out in the Project Particulars. Barefoot & Gilles Limited accepts no responsibility whatsoever should the drawing be used by any other person, on any other site or for any other purpose than those stated. This drawing is to be read in conjunction with all relevant drawings and specifications.

WORK TO FIGURED DIMENSIONS ONLY. ALL MEASUREMENTS ARE TO BE CHECKED ON SITE AND ANY DISCREPANCIES REPORTED TO BAREFOOT & GILLES LIMITED.