

CHURCH ROAD

Existing metal railing fence (nom.1600h).

NOTES  
• Alterations to existing buildings are based on informed assumption only, taken from available information, and pending a structural survey including opening up of existing walls, floors and ceilings to determine true site conditions.

Key To Existing Landscape Materials:  
Existing grass landscaped area.  
Existing asphalt hardstanding.  
Existing concrete paving.  
Existing tree / shrub.

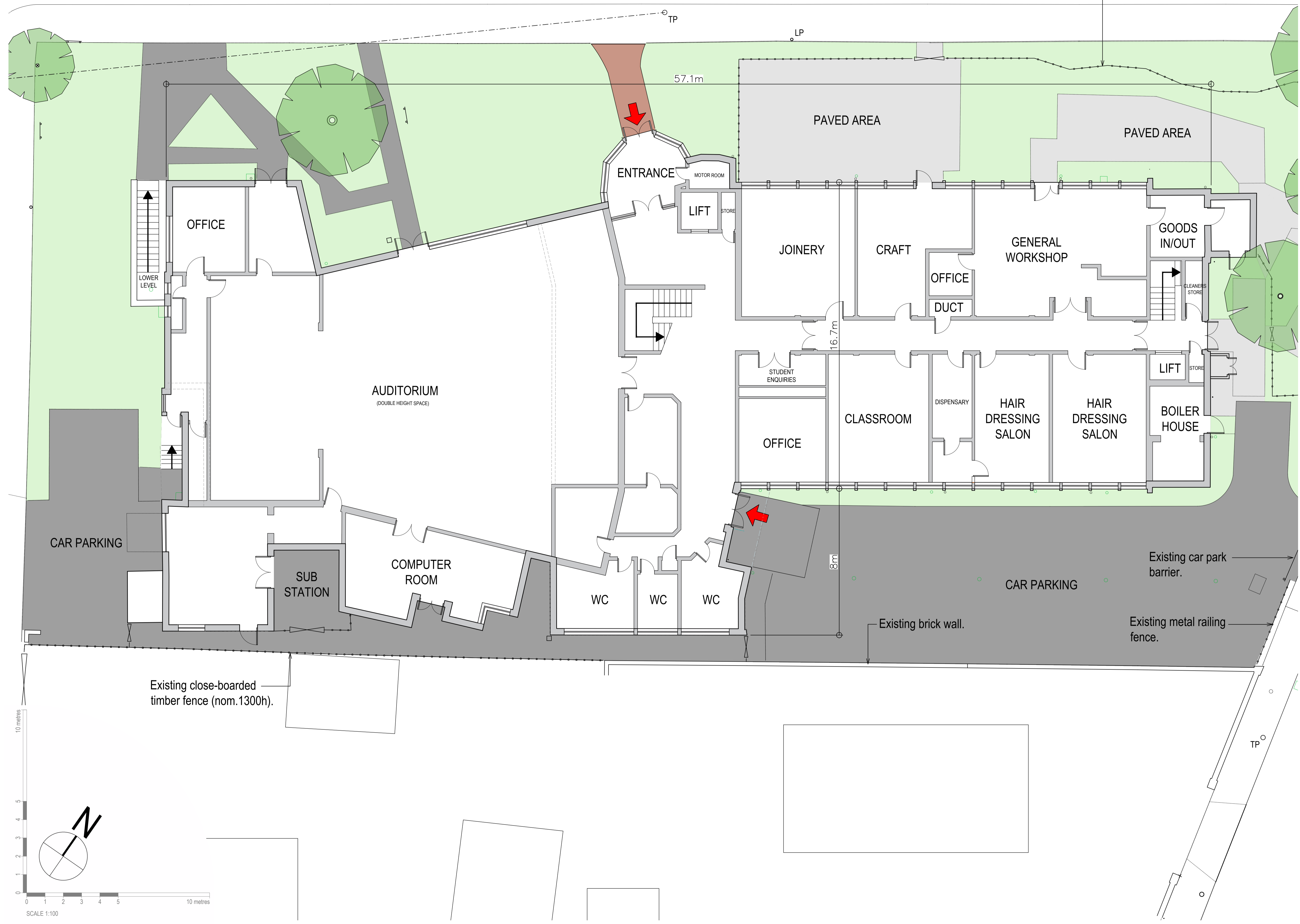

Date	Rev.	Descriptions	RB	MH
22-03-2024	A	Issued for outline planning consent.		

**barefoot & gilles**  
Third Floor, Eldon House, 2 Eldon Street, London, EC2M 7LS. Tel: 020 7422 7800  
Nine Hills Road, Cambridge, CB2 1GE. Tel: 01223 653068  
2 Cromwell Court, 16 St. Peters Street Ipswich, Suffolk IP1 1XG. Tel: 01473 257474  
design@barefootgilles.com www.barefootgilles.com

Project: Clacton College Site  
Client: Clacton-on-Sea CO15 6JQ  
Drawing: Marble Arch Group Limited  
Existing Ground Floor Plan

Scale & Format	1:100 @A1	Date	26-02-2024
BGA Drawing No.	2248-DE-20-10	Revision	A
BIM Model File	NA		

GUIDE TO BGA DRAWING NUMBERS			
PROJECT NO.	STATUS	TYPE	DWG NO.
example 1234	BK = Sketch DE = Planning PI = Production Information	15- Site / External Plans 20- Floor / Roof Plans 30- Elevations 40- Sections 50- Details 60- Schedules 70- Room Layouts	example 01

DISCLAIMER  
This drawing was prepared for the Client, Project & Site stated below and for the purposes set out in the Project Particulars. Barefoot & Gilles Limited accepts no responsibility whatsoever should the drawing be used by any other person, on any other site or for any other purpose than those stated. This drawing is to be read in conjunction with all relevant drawings and specifications.  
WORK TO FIGURED DIMENSIONS ONLY. ALL MEASUREMENTS ARE TO BE CHECKED ON SITE AND ANY DISCREPANCIES REPORTED TO BAREFOOT & GILLES LIMITED

