

NOTES
 1. No dimensions are to be scaled from this drawing.
 2. Contractors must verify all figured dimensions on site before commencing any work or making any shop drawings.
 3. This drawing is the sole copyright of Savills and no part may be reproduced without the written consent of the above.
 4. Site Location Plans are prepared from the Ordnance Survey Map with the sanction of the Controller of H.M. Stationery Office. Crown Copyright Reserved.

Note - Notional furniture layout shows furniture provision as required to comply with minimum standards for such contained in the Oxford City Council HMO Standards.

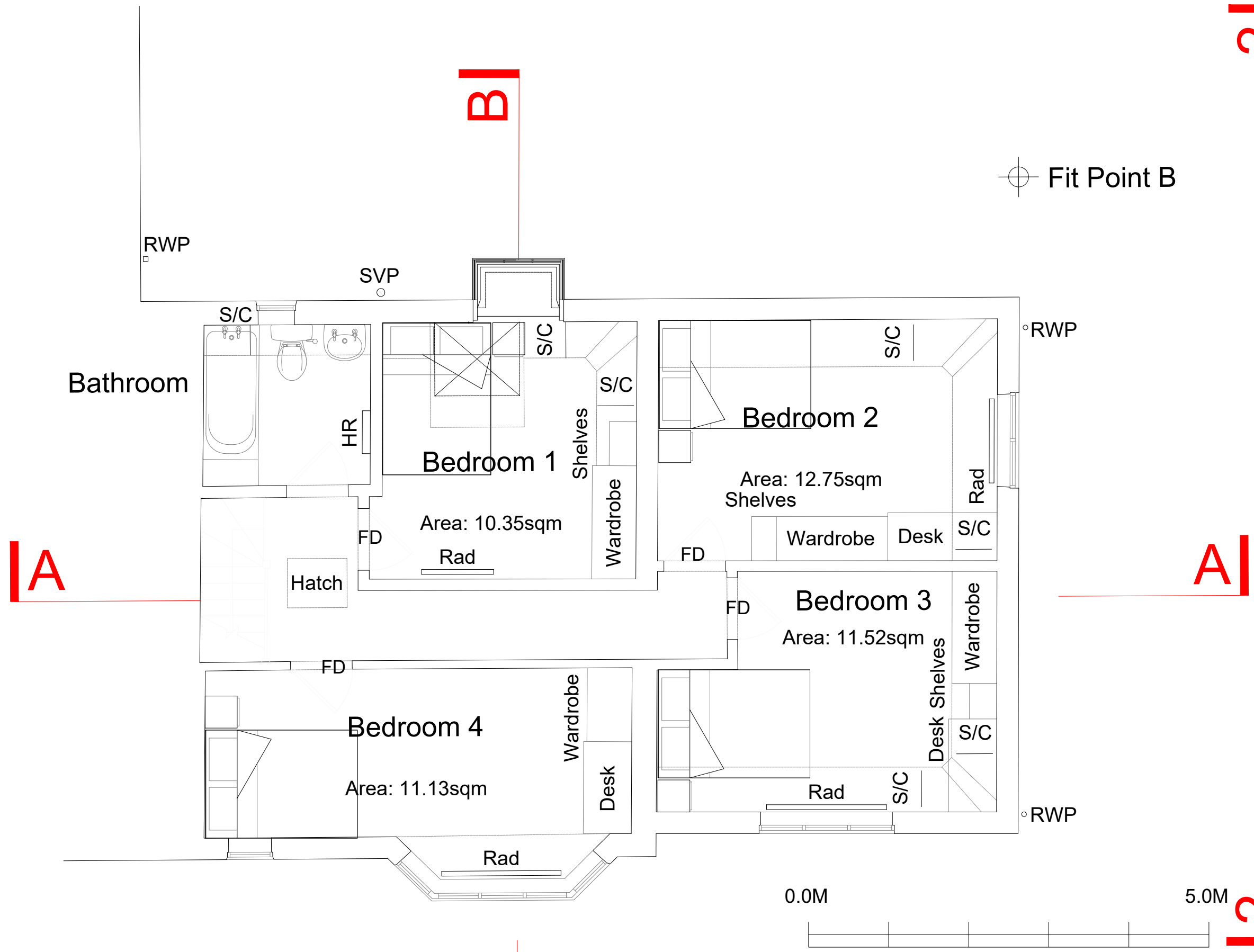

Fit Point A

First Floor Plan

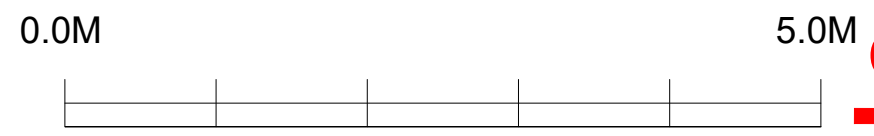

Rev	Description	By	Date
-	Drawing Status	-	-
 ARCHITECTURE & BUILDING CONSULTANCY Savills (UK) Limited Wytham Court, 11 West Way, Botley, Oxford OX2 0QL Telephone: + 44 (0)1865 269000 Fax: + 44 (0)1865 269001 www.savills.co.uk			
Client			
-Mr & Mrs Baumann			
Project			
- 1 Collinwood Road			
- HMO Conversion			
Drawing Title			
- First Proposed			
-			
-			
Scale	Date	Drawn	Checked
-1:50@A3	- 11.3.24	-HD	-
Drawing Number	Rev.	Project Number	
-008	-	-	