

Notes
 Do not scale from this drawing. All dimensions to be checked on site prior to construction and any discrepancies reported to the Architect. Copyright reserved.

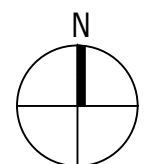

Block plan as Proposed
 1:200 @ A3

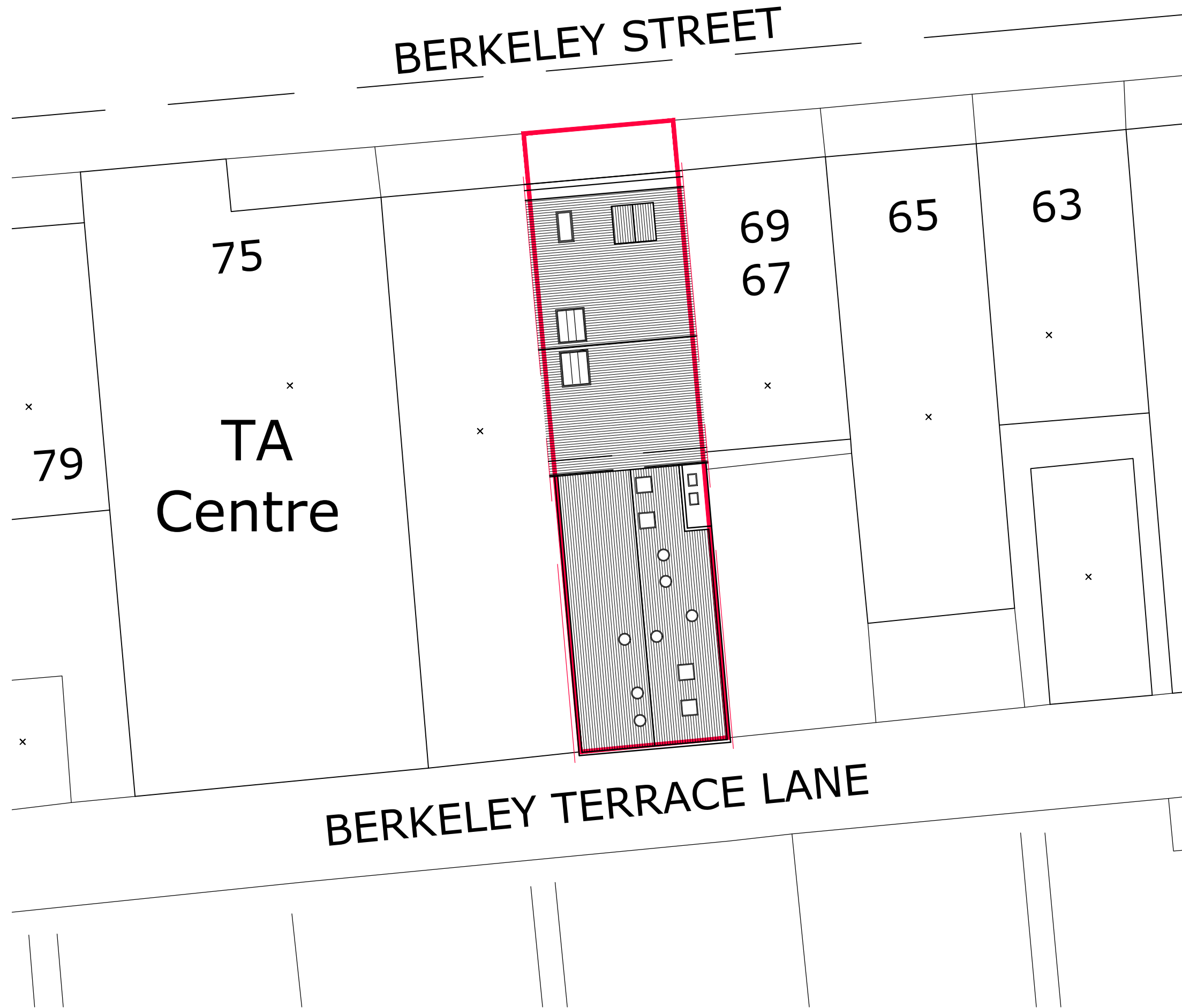

| | | | | |
|-----------|---|--------|-------|---------|
| Revisions | | | | |
| Status | PLANNING | | | |
| Client | Mr Tim Zhou | | | |
| Project | 71 Berkeley Street Glasgow G3 7DX | | | |
| Title | Block Plan as Proposed | | | |
| Scale | Size | Date | Drawn | Checked |
| 1:50 | A3 | MAR 24 | FH | JDF |



Allison Architecture
 13 Royal Crescent
 Glasgow G3 7SL
 t: +44 (0)141 353 1082
 e: hello@allisonarchitecture.co.uk
 www.allisonarchitecture.co.uk

| | | |
|-------------|-------------|------|
| Project No. | Drawing No. | Rev. |
| 24005 | 00-002 | |