

**PROPOSED SITE PLAN
GROUND FLOOR**

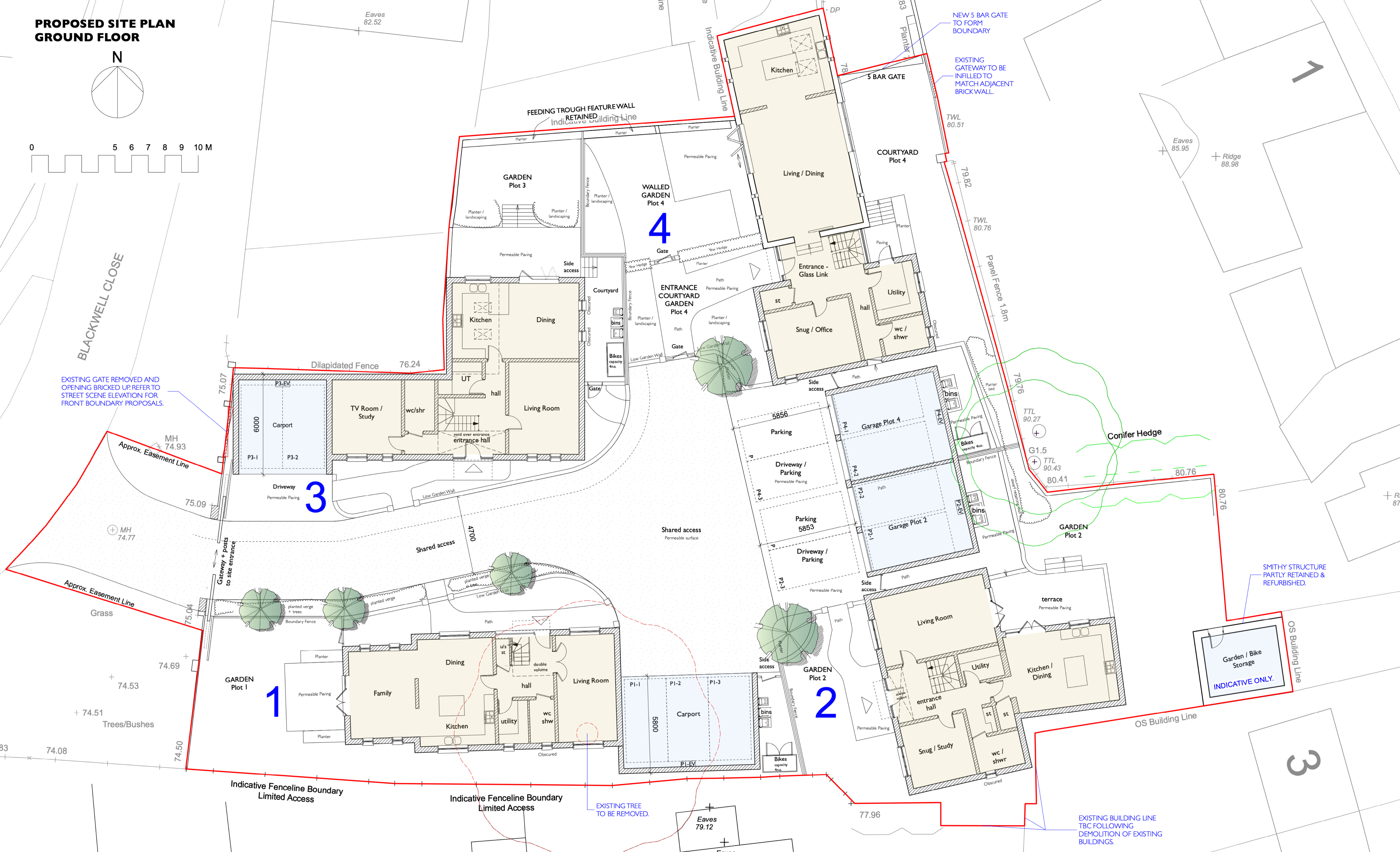
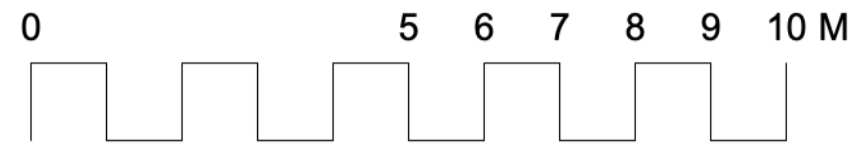
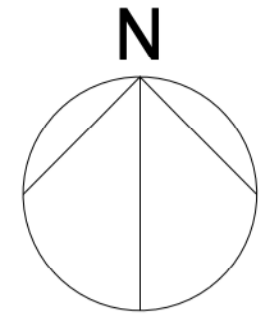

BLACKWELL CLOSE

EXISTING GATE REMOVED AND OPENING BRICKED UP. REFER TO STREET SCENE ELEVATION FOR FRONT BOUNDARY PROPOSALS.

NEW 5 BAR GATE TO FORM BOUNDARY

EXISTING GATEWAY TO BE INFILLED TO MATCH ADJACENT BRICK WALL

SMITHY STRUCTURE PARTLY RETAINED & REFURBISHED.

EXISTING BUILDING LINE TBC FOLLOWING DEMOLITION OF EXISTING BUILDINGS.

EXISTING TREE TO BE REMOVED.

Garden / Bike Storage
INDICATIVE ONLY.



Unit 25, BASEPOINT
EVESHAM
WORCESTERSHIRE
WR11 1GP
t : 020 7328 2576
Email: info@hubarchitects.co.uk

All dimensions are to be checked on site before commencement of works.
All sizes and dimensions to any structural elements are indicative only. See structural engineer's drawings for actual sizes/dimensions.
Sizes of and dimensions to any service elements are indicative only. See service engineer's drawings for actual sizes/dimensions.
This drawing to be read in conjunction with all relevant Architect's drawings, specifications and other consultants' information.

Rev.	Date	Description
A	2312-12	General drawing update, road adjustment for tracking coordination.
B	2312-14	General drawing update, coordination.
C	2401-04	General drawing update, coordination.
D	2401-10	General drawing update, coordination.
E	2401-23	General drawing update, following client comments.
F	2402-08	General drawing update, following client comments.
G	2403-26	General drawing update.

PLANNING		
Initial:	JC	
Project:	Land East of Blackwell Close, Earls Barton.	Drawing: PROPOSED GF SITE PLAN
Scale:	1:100 @A1	DWG: 1365 - PL - 101
Date:	Nov '23	Revision: G

+ Ridge 81.69