

Site Orientation

Position (x,y)
The survey grid is a local grid coincident with Ordnance Survey National Grid.

Height (z)
All Orthometric Heights are related to OSGM02 GPS Datum Computed using Leica Smartnet RTK Network

1. Surveyed boundary features are not necessarily legal boundaries.
2. All information contained in this drawing (including digital data) should be checked and verified prior to any fabrication or construction.
3. Copyright of all data produced by Vertex Surveys shall remain with Vertex Surveys unless otherwise specifically agreed.

Elevation Survey Key

FEATURES	SURFACES	
Alarm Box	A	Brick
Air Brick	AB	Cladding
Air Conditioning Unit	ACU	Metal Cladding
Column	Col	Render
Down Pipe	DP	Stone Cladding
Electrical Consumer Unit	EUC	Stone
Electric Meter	EM	Sloping Tiled Roof
Fuse Box	FB	Timber
Gas Meter	GM	Timber Cladding
Handrail	HR	Vertical Tile Hanging
Junction Box	JB	
Light	L	
Refrigeration Unit	RU	
Rain Water Pipe	RWP	
Switchbox	SB	
Soil Vent Pipe	SVP	
Telecoms Box	TB	
Vent	V	
Waste Pipe	WP	

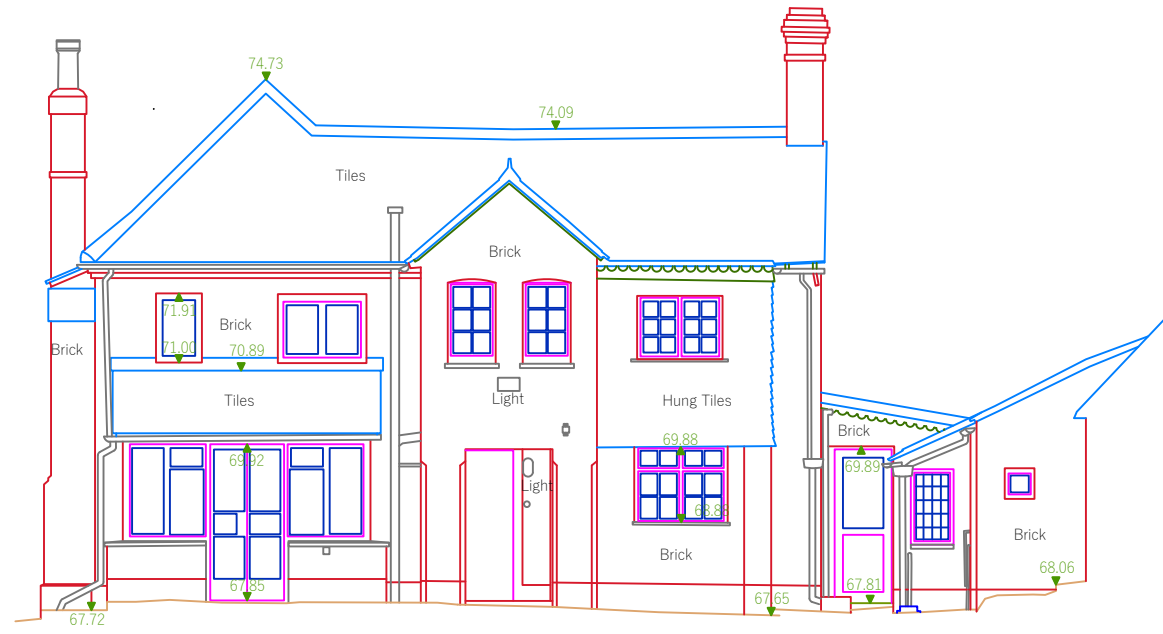

Datum 66.00m
East (Front) Elevation

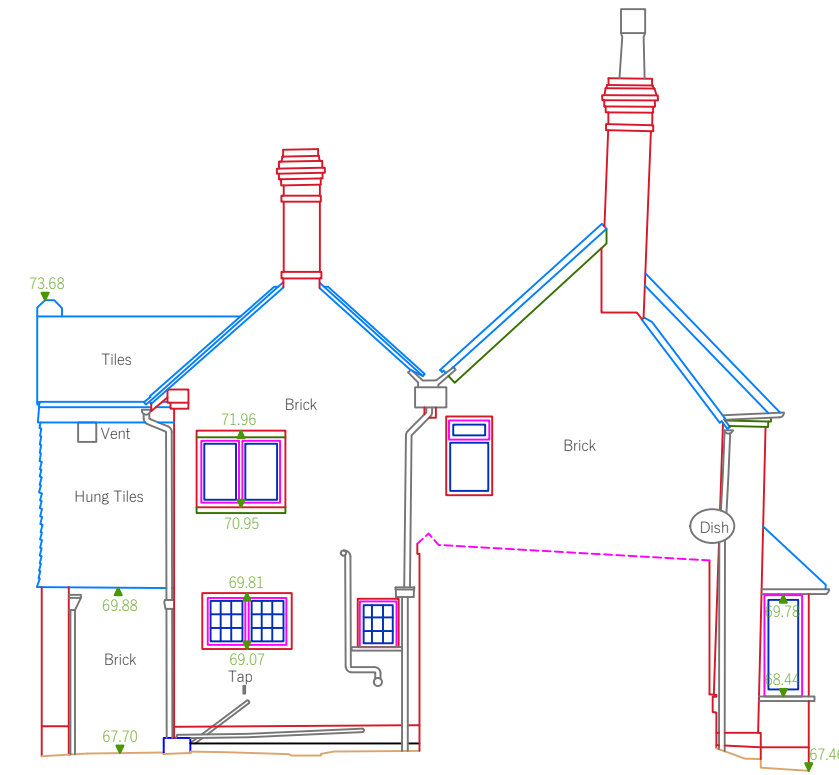

Datum 66.00m
South (Side) Elevation

Rev. Suffix	Date	Initial	Revision Details	

Surveyor: DH Drawn By: DH Checked & Issued By: AJH

Client
Patton Architecture

Location
Eastbury Cottage
The Street
Compton, GU3 1EG

Drawing Title
Elevations

Job No.	2205034	Dwg No.	2205034-03
Sheet Size	A3	Sheets	1 of 1
Scale	1:100	Date	June 2022



Vertex Surveys Limited
5 Pathfields
Shere
Guildford
Surrey, GU5 9HP
T: 01483 203 181
E: mail@vertexsurveysltd.com
W: vertexsurveysltd.com

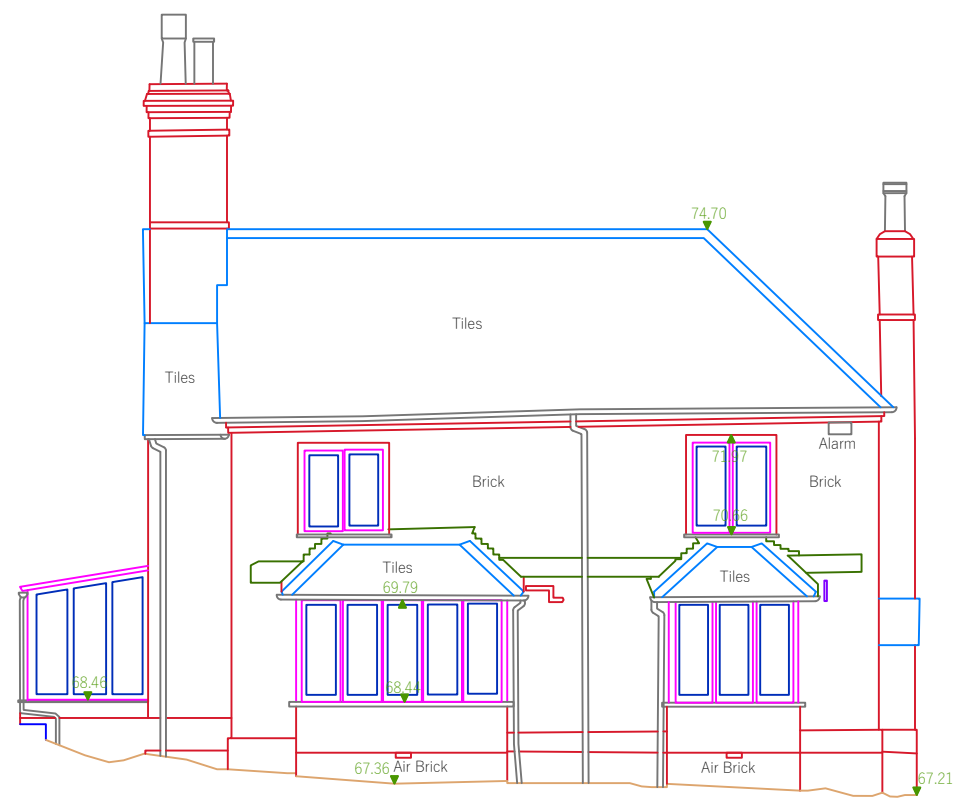

Datum 66.00m
East (Front) Elevation

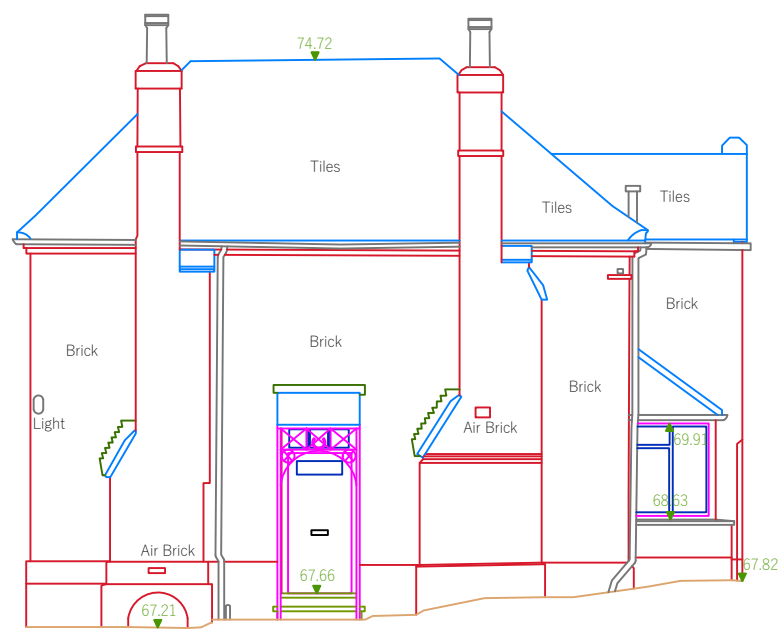

Datum 66.00m
North (Side) Elevation

