

COPYRIGHT ©

DETAILS OF THIS DRAWING ARE THE COPYRIGHT OF ASPIRE ARCHITECTURAL SERVICES LTD AND MUST NOT BE REPRODUCED OR COPIED WITHOUT PRIOR WRITTEN CONSENT.

ANY ERRORS OR OMISSIONS ARE TO BE REPORTED TO THE ARCHITECT IMMEDIATELY.

ALL PROPOSED ROAD AND JUNCTION ALTERATIONS SUBJECT TO HIGHWAYS ENGINEERS DETAILED DESIGN.

REMOVAL OF ANY EXISTING TREE AND LANDSCAPED AREAS SUBJECT TO NEGOTIATIONS WITH LOCAL AUTHORITY PLANNING DEPT AND OTHER STATUTORY CONTROLS.

ALL DRAWINGS TO BE READ IN CONJUNCTION WITH STRUCTURAL ENGINEERS DRAWINGS AND ALL RELATED ARCHITECTS AND CONSULTANT DRAWINGS AND OTHER RELEVANT INFORMATION.

ANY CHANGES TO THE DRAWN DESIGN DURING CONSTRUCTION WORK SHOULD BE RECORDED AND REPORTED TO THE DESIGNER IMMEDIATELY.

ASPIRE ARCHITECTURAL SERVICES LTD WILL NOT TAKE RESPONSIBILITY FOR ANY VARIATION MADE BY OTHERS TO THE DESIGN AND CONSTRUCTION DETAIL CONTAINED WITHIN THIS DRAWING.

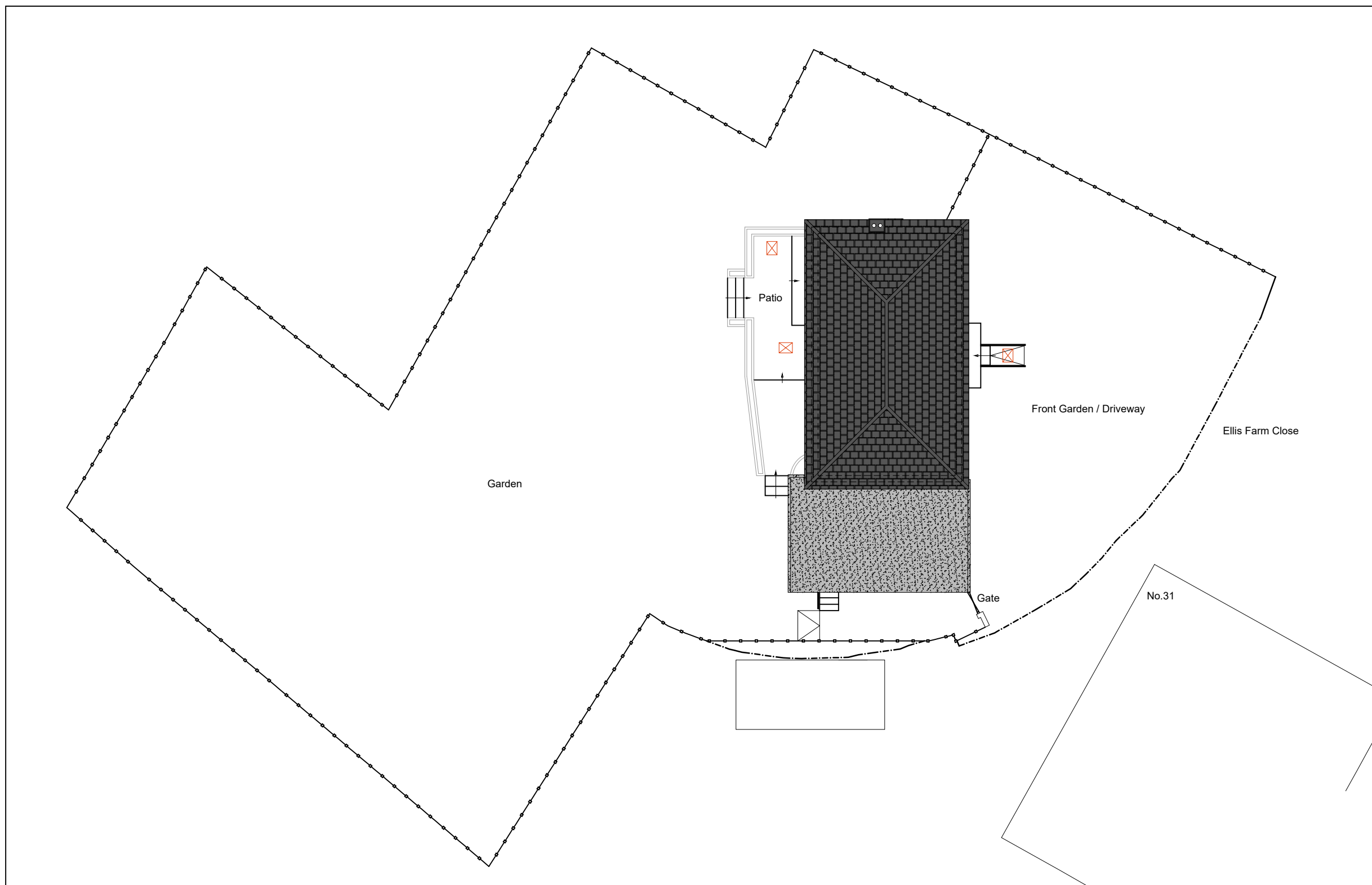

Existing Site Plan

Scale - 1:200@A3



REV	DATE	VARIATION



WWW.ASPIRE-AS.CO.UK
UNIT 3, FOXHILLS FARM BUSINESS CENTRE
LONGCROSS ROAD
CHERTSEY
KT16 0DN
TEL: 01932 988520

Project
30 ELLIS FARM CLOSE, WOKING, SURREY, GU22 9QN

Title
EXISTING SITE PLAN

Drawn By AG	Checked ASPIRE	Date APR 24
----------------	-------------------	----------------

Drawing Number 2227-120	Revision -	Scale 1:200@A3
----------------------------	---------------	-------------------

Client
-

Planning