

SHERWOOD WAY

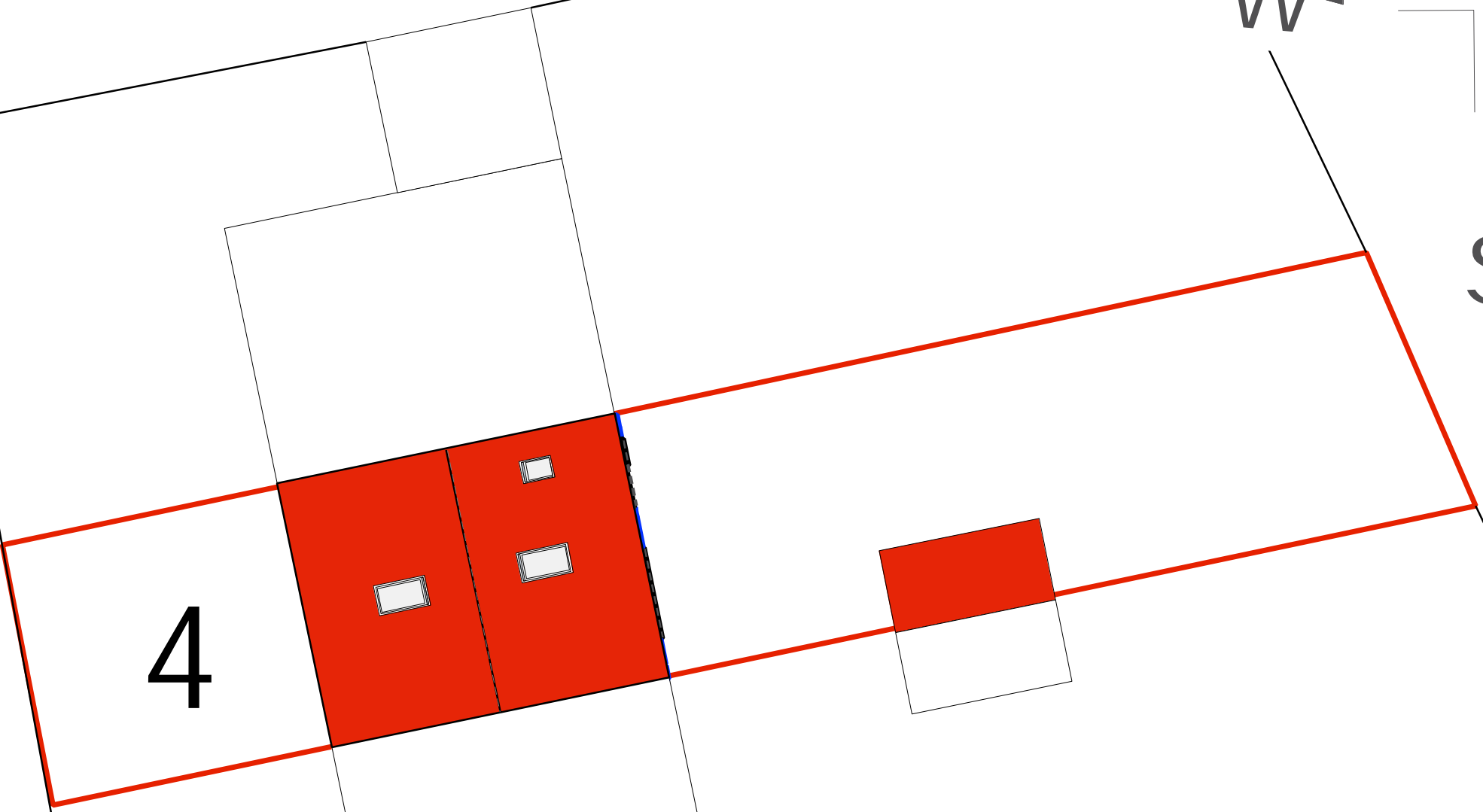

Scale 1 : 125 New site plan

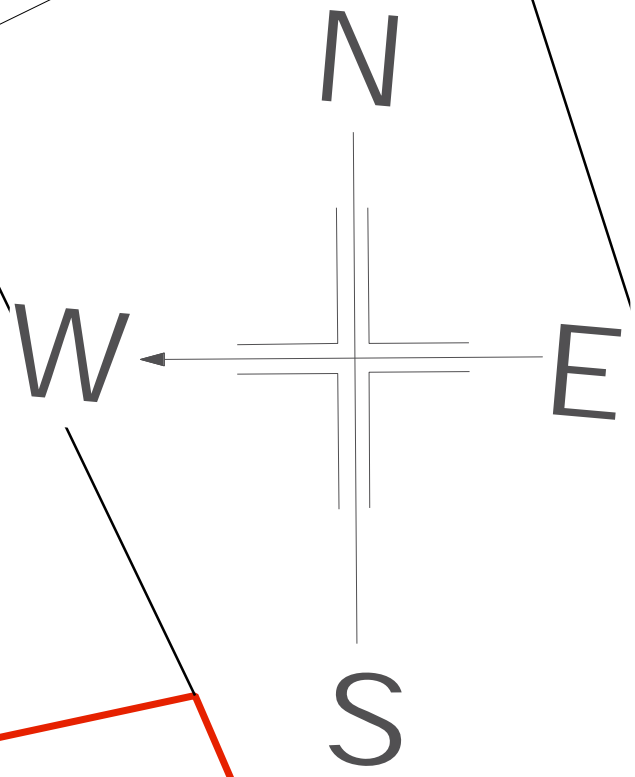
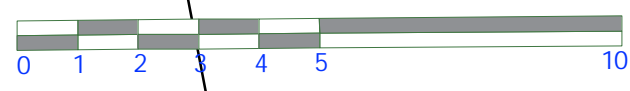

Holdsworth Designs
12 Greentrees Avenue, Tonbridge, Kent, TN10 4ND

Client	Laura Milkente	Address	4 Sherwood Way	Scale	1 : 125	Drawing Title	New site plan	Drawing Number	
	Loft conversion		Tunbridge Wells						
Project	4 Serwood Way Ton Wells		Kent TN2 3LL	Drawn by	MGH	Date	03.04.2024		24.41.09