

Scale 1 : 100 Plan

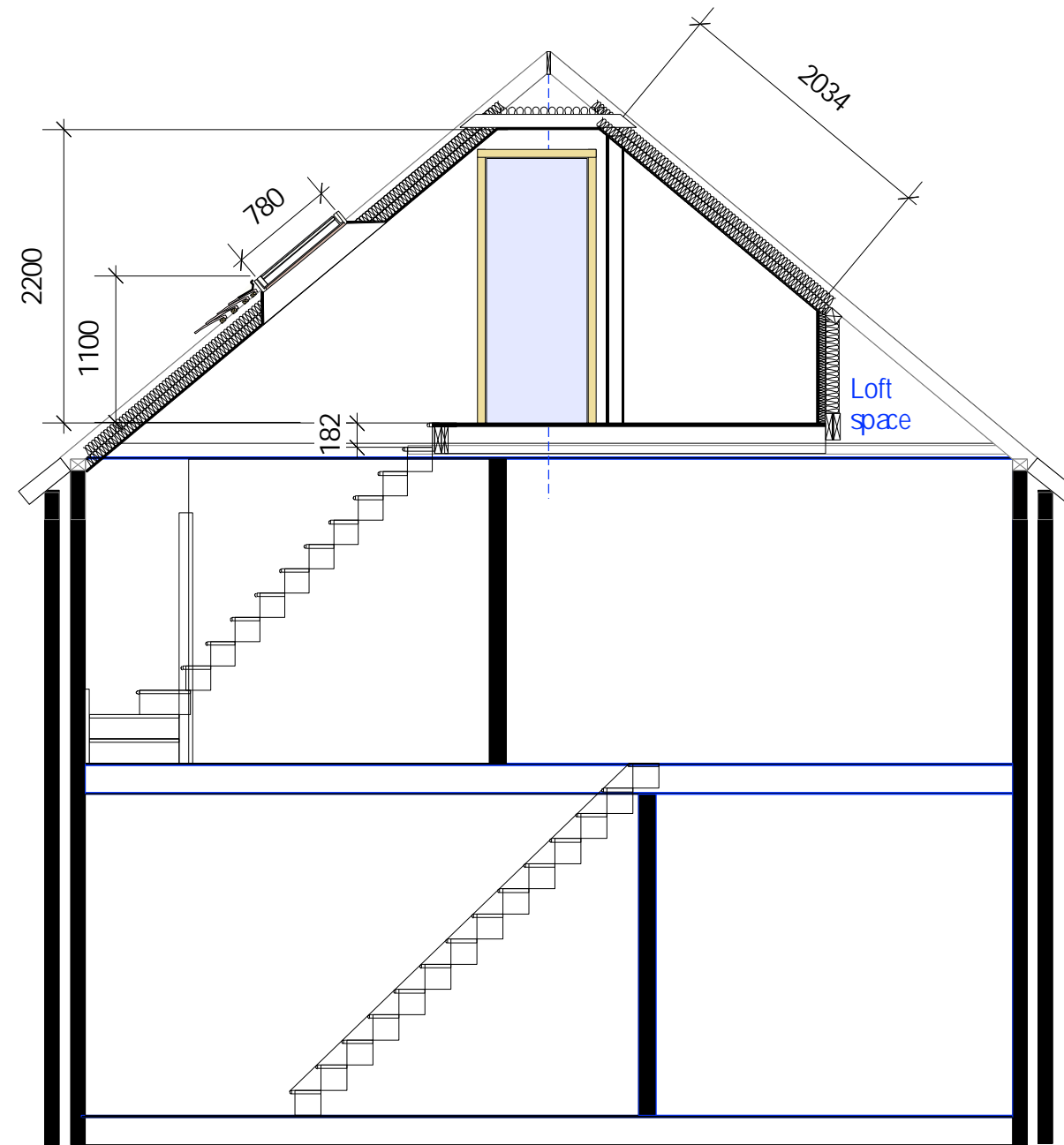

Scale 1 : 50 Section AA

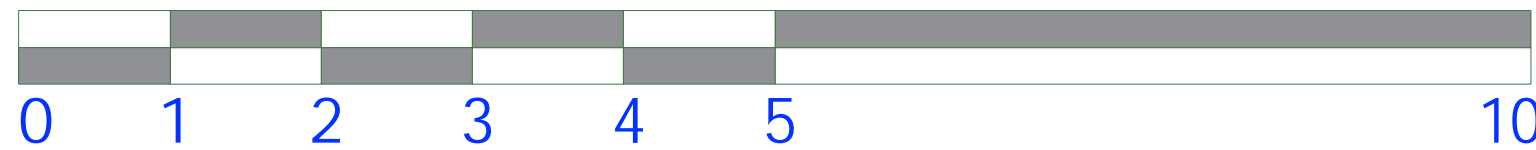

Do not scale from this drawing
Report any errors or discrepancies
Check all measurements
before commencing
All materials,
components & workmanship
to comply with all current
regulations, codes of practice
& manufacturers installation instructions
This drawing and all designs
is the property of Holdsworth Designs

Proposed Additions/ modifications

EXTERNAL
Connect new loft shower room waste
to existing soil stack

INTERNAL
Bedroom two
Remove existing doorway
Create new lobby to new Loft staircase
New Fire dorr to bedroom two
Plasterboard, skim, skirtings & architraves
New Fire door

Bedroom one
Install New Fire door to Bedroom one

Loft room
Create loft room
New floor joists suspended from
2 no. 'flitch beams' cut into Party walls
Create new support wall under rafters
Create new ceiling with max .2.126
between rafter support
Install 2 no.
Velux windows FK08 1180mm x550mm
2x 75mm solid Kingspan Insulation
to walls and skceiling
Add 50mm Solid Kingspan to party walls
between & under rafters
Foil tape all joints
Plasterboard & skim

Stairwell
Create stair well with Landing and staircase
Fire door at Loft room access
Install Velux CK01 window over stairs
Plasteboard and skim
Second fix, skirtings and architraves

Loft Shower room
Create sound insulated partition wall with door
Install high powered ventilation system
Second fix Skitings and architraves
Build storage cupboard (show as extra)
Install new Shower shower tray & screen
New WC & Basin



Holdsworth Designs
12 Greentrees Avenue, Tonbridge, Kent, TN10 4ND

Client	Laura Milkente	Address	4 Sherwood Way	Scale	1 : 50	Drawing Title	Section AA	Drawing Number	24.41.13
	Loft conversion		Tunbridge Wells						
Project	4 Serwood Way Ton Wells		Kent TN2 3LL	Drawn by	MGH	Date	03.04.2024		