

FIRST FLOOR PLAN AS APPROVED:  
23/00282/LBC, 23/00281/FUL  
SCALE 1:100

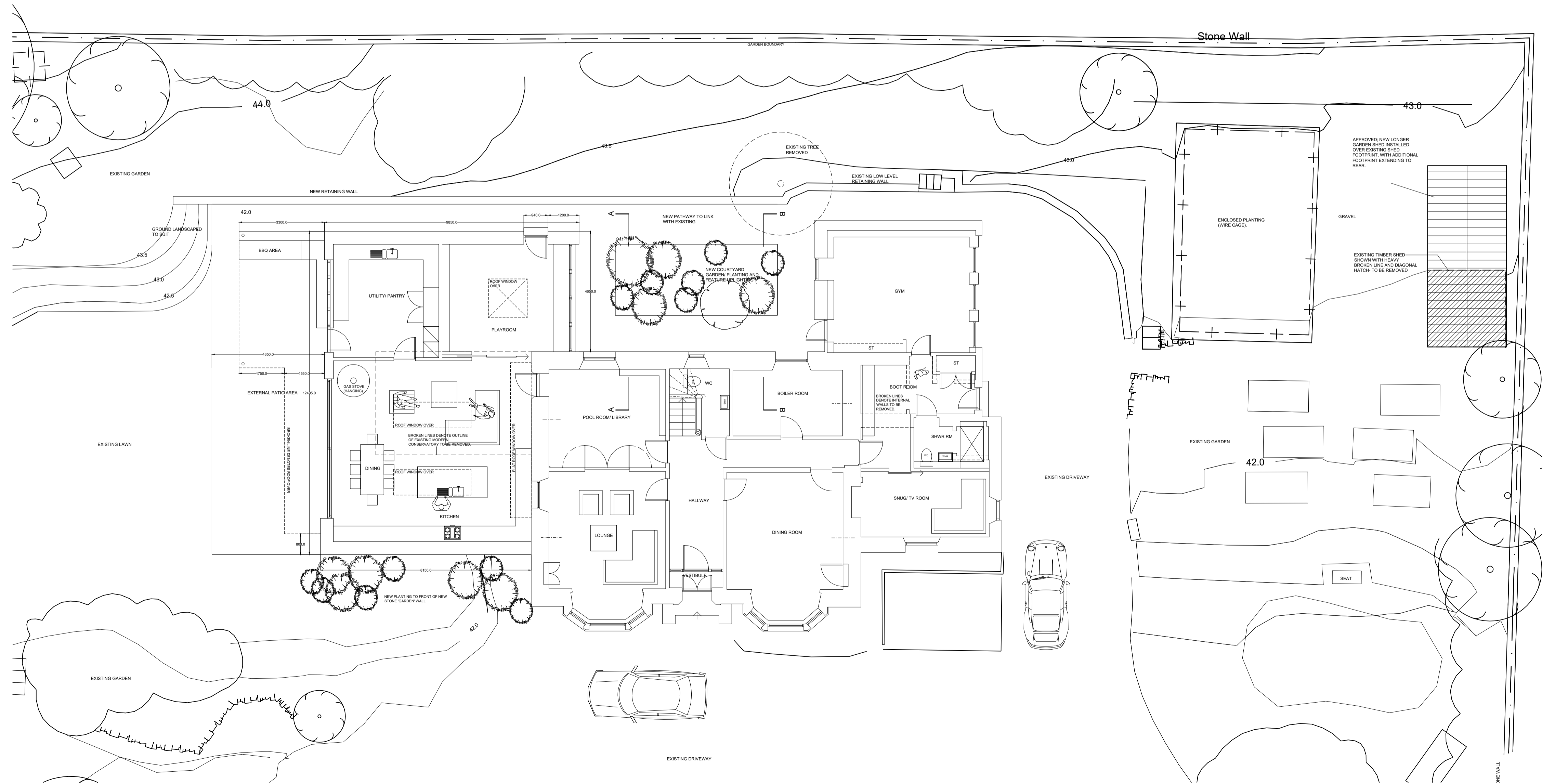

GROUND FLOOR PLAN AS APPROVED:  
23/00282/LBC, 23/00281/FUL  
SCALE 1:100

REVISIONS	
<b>ALLY CROLL ARCHITECT</b> 9 STANLEY HOUSE   115 HENDERSON STREET   BRIDGE OF ALLAN   FK9 4HH	
SIGNED	FOR ALLY CROLL ARCHITECT LTD
DATED	
PLANNING	
PROPOSED ALTERATIONS AND EXTENSION TO EXISTING DWELLING HOUSE AT 7 KENILWORTH ROAD BRIDGE OF ALLAN FK9 4DU FOR MR AND MRS TAYLOR	
DRWG NO : A.21.10 PH2 002	
DATE : MARCH 2024	
DRAWN AEC	
SCALE AS NOTED @ A1	
PLANS AS APPROVED: 23/00282/LBC, 23/00281/FUL	
CONTRACTOR TO VERIFY ALL DIMENSIONS ON SITE PRIOR TO ORDERING MATERIALS OR COMMENCING WORK NO DIMENSIONS TO BE SCALED FROM DRAWINGS ALL DRAINAGE TO BE CONSTRUCTED TO THE SATISFACTION OF THE LOCAL AUTHORITY ELECTRICAL INSTALLATION TO COMPLY WITH THE LATEST IEE REGULATIONS. THIS DRAWING TO BE READ IN CONJUNCTION WITH ALL OTHER ARCHITECTS, CONSULTANTS, SPECIALISTS AND SUB- CONTRACTORS DRAWINGS THIS DRAWING IS THE PROPERTY OF ALLY CROLL ARCHITECT LTD AND COPYRIGHT IS RESERVED BY THEM IF IN DOUBT ASK, DO NOT SCALE. ALL DIMENSIONS TO BE CHECKED ON SITE PRIOR TO ANY WORKS COMMENCING. ANY DISCREPANCY TO BE REPORTED TO ALLY CROLL ARCHITECT LTD.	