

UPPER FLOOR PLAN AS EXISTING
SCALE 1:100

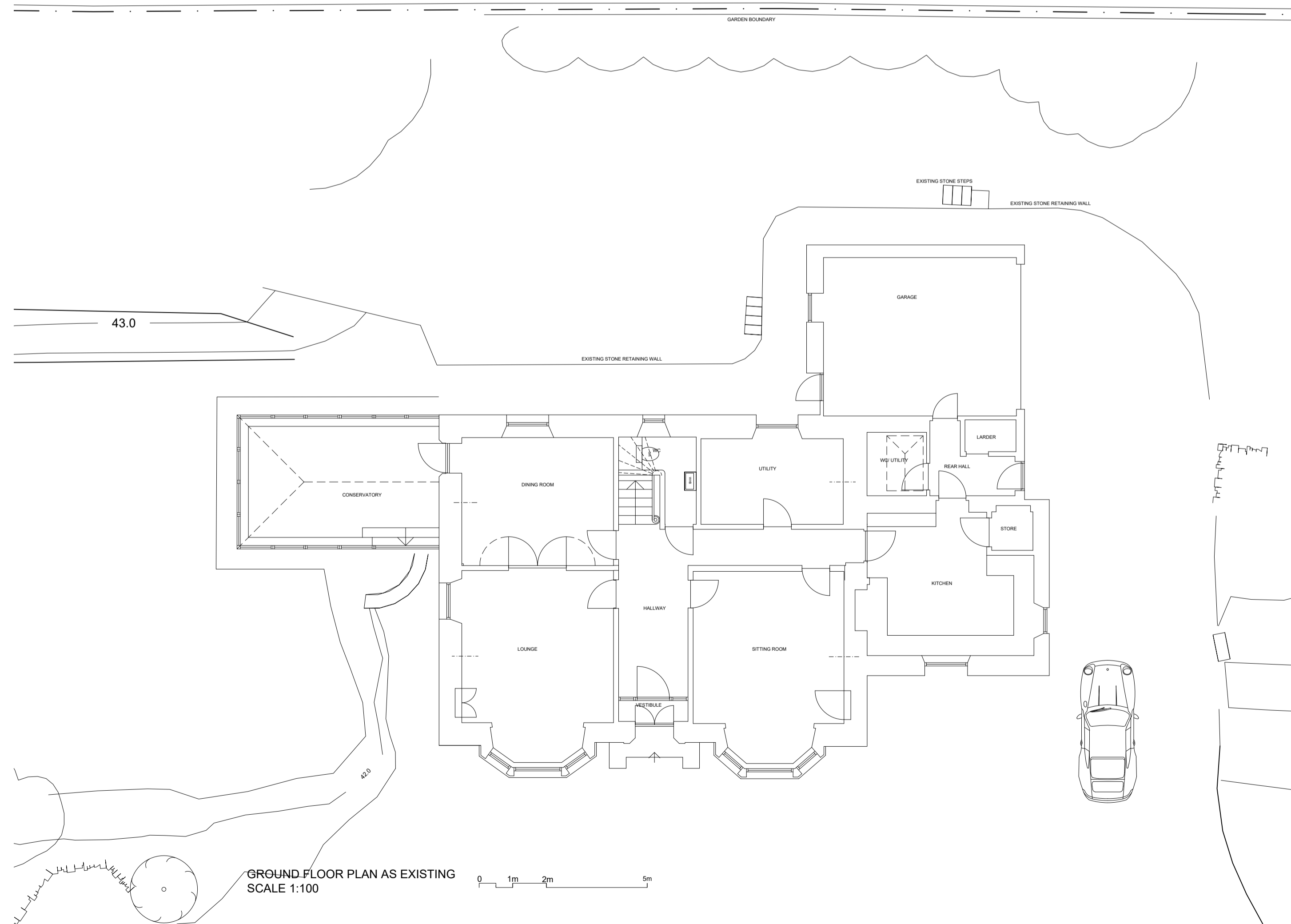

GROUND FLOOR PLAN AS EXISTING
SCALE 1:100

A. 15/04/24 TREES REMOVED	
REVISIONS	
ALLY CROLL ARCHITECT 9 STANLEY HOUSE 115 HENDERSON STREET BRIDGE OF ALLAN FK9 4HH	
SIGNED	FOR ALLY CROLL ARCHITECT LTD
DATED	
PLANNING	
PROPOSED ALTERATIONS AND EXTENSION TO EXISTING DWELLING HOUSE AT 7 KENILWORTH ROAD BRIDGE OF ALLAN FK9 4ND FOR MR AND MRS TAYLOR	
DRWG NO : A.21.10 PH2 011	
DATE : MARCH 2024	
DRAWN AEC	
SCALE AS NOTED @ A1	
EXISTING PLANS	
CONTRACTOR TO VERIFY ALL DIMENSIONS ON SITE PRIOR TO ORDERING MATERIALS OR COMMENCING WORK NO DIMENSIONS TO BE SCALED FROM DRAWINGS ALL DRAINAGE TO BE CONSTRUCTED TO THE SATISFACTION OF THE LOCAL AUTHORITY ELECTRICAL INSTALLATION TO COMPLY WITH THE LATEST IEE REGULATIONS. THIS DRAWING IS TO BE READ IN CONJUNCTION WITH ALL OTHER ARCHITECTS, CONSULTANTS, SPECIALISTS AND SUB- CONTRACTORS DRAWINGS THIS DRAWING IS THE PROPERTY OF ALLY CROLL ARCHITECT LTD AND COPYRIGHT IS RESERVED BY THEM IF IN DOUBT ASK, DO NOT SCALE, ALL DIMENSIONS TO BE CHECKED ON SITE PRIOR TO ANY WORKS COMMENCING. ANY DISCREPANCY TO BE REPORTED TO ALLY CROLL ARCHITECT LTD.	