

scale 1 : 100 @ A3

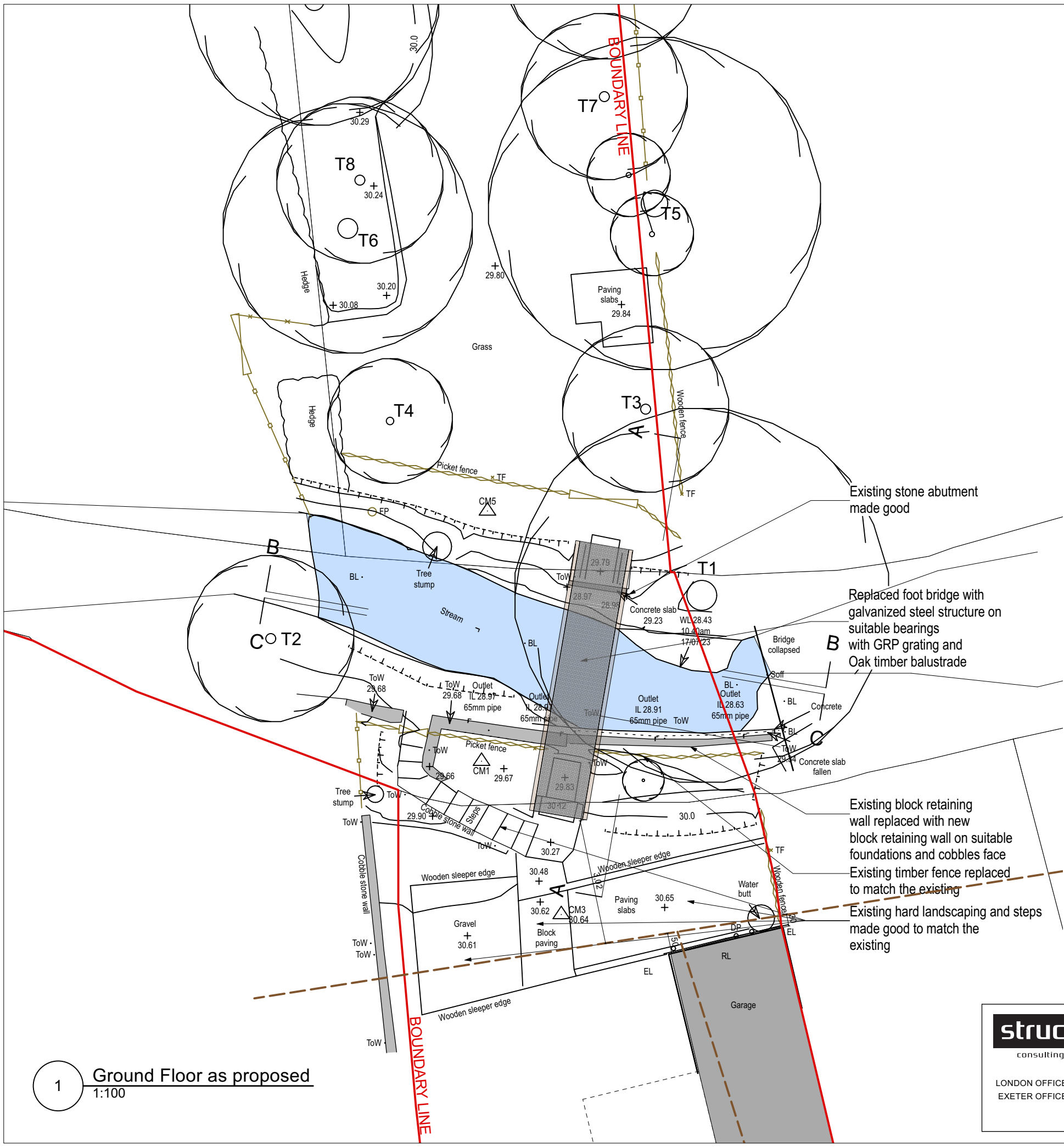
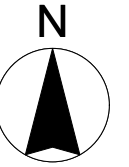
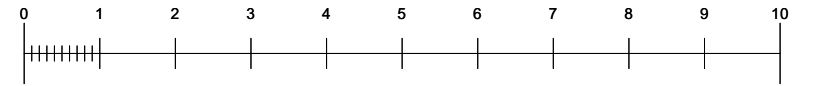

Existing stone abutment made good

Replaced foot bridge with galvanized steel structure on suitable bearings with GRP grating and Oak timber balustrade

Existing block retaining wall replaced with new block retaining wall on suitable foundations and cobbles face

Existing timber fence replaced to match the existing

Existing hard landscaping and steps made good to match the existing

1 Ground Floor as proposed  
1:100

**AS PROPOSED**

2024-02-29

**structureHaus**  
consulting . engineering . designing

LONDON OFFICE 020 8940 7810  
EXETER OFFICE 01392 363497  
info@structurehaus.com  
www.structurehaus.com

PROJECT  
REPAIR WORKS TO RIVER WALL,  
FOOTBRIDGE AND ASSOCIATED  
LANDSCAPING  
PENSHURST, HIGH STREET  
NEWTON POPPLEFORD, DEVON, EX10 0DW

CLIENT  
Peter Waylett, AEDes First

DRAWING  
Ground Floor as proposed

SCALE  
1 : 100  
06057E\_PENHURST\_PLANNING.vwx

REVISION				
B	29.02.24	For submission	BM	DP
A	23.02.24	Sewer added, cobbles face DETAILS	BM	DP
REV	DATE	DETAILS	DRAWN	CHECKED
DRAWING NUMBER		REVISION		
06057E PA-07		B		
Drawn by	BM	Checked by	DP	
Date	2024.01.05	Date		
ISO A3				