

AJ
Approver

Rev	Date	Note	By
P1	20/02/2024	Initial Issue	SR
P2	06/03/2024	Minor amendments following client feedback	AJ
P3	13/03/2024	Updated to 2 Bed Single Storey	SR
P4	14/03/2024	Highlevel Windows Ommited, Roof Lights Added	SR
P5	28/03/2024	General amendments following client feedback	AJ

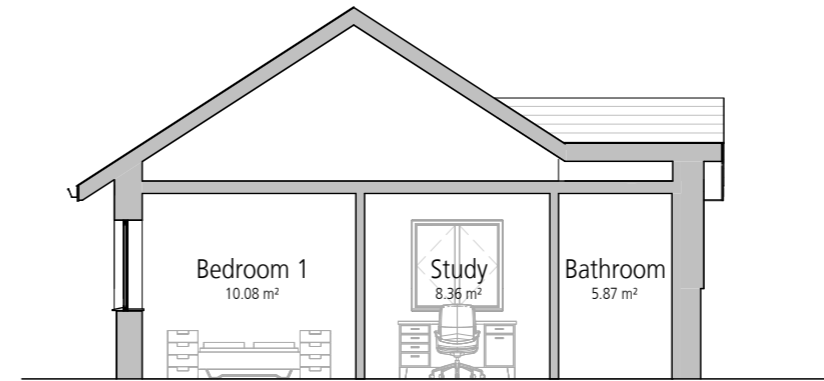

Proposed Section A-A



Proposed Section B-B



Proposed Section C-C

mitchell
architects

Stoke Damerel Business Centre, 5 Church Street, Stoke, Plymouth, PL3 4DT
T 01752606007 E info@mitchellarchitects.co.uk
www.mitchellarchitects.co.uk

MAL Project Reference [internal]: 2342

Project
Chard Road Housing

Client
P.Rump

Sheet
Pharmacy Conversion - Proposed Sections

2342-MAL-DR-A-130-002

Drawn by: AJ / SR

Checked by: LK

Revision	Status	Scale @ Size
P5	S1 FOR COORDINATION	1 : 100 @ A3

Responsibility is not accepted for errors made by others in scaling from this drawing. All construction information should be taken from figured dimensions only.
ALL dimensions and levels to be checked on site and any discrepancies reported before work commences - if in doubt, ASK.
This drawing is © Copyright Mitchell Architects.