

DRAINAGE (SuDS)
 A new soakaway will be designed in accordance with Approved Document H & BRE Digest 365, the design allows an increase of 30% for climate change. The proposed hardstanding areas shall be laid with a cross fall so all rainwater shall be directed into the ground locally and within the site boundaries.
 Provide a silt trap to the surface water drainage line so that the silt and debris can be removed before it can enter the soakaway. The silt trap shall be cleared weekly until the development is completed after which a three monthly inspection rota shall be followed.

WASTE STORAGE
 Unchanged

BOUNDARY TREATMENT
 Unchanged

EXTERNAL MATERIALS

Walls	01 - Dry Stone wall effect
	02 - White Render
	03 - Dark Grey Render
Roof	04 - Slate
	05 - Single ply Alwitra 7021
Windows & Doors	06 - RAL 7021
Rainwater Goods	07 - RAL 7021

Denotes obscured glazing Pilkington level 3
 # Denotes obscured glazing Pilkington level 3, with window restrictor. Maximum window opening 80mm or 10" whichever ever is greater. To comply B Regs approved Doc O.

with

AREAS

Existing Floor Area	224.92m ²
Proposed Floor Area	286.85m ²
Site Area	2308m ²

TREES
 T1, T2 etc: The existing trees will be assessed by the Arboriculturalist
 NT1, NT2 etc: New tree planting, Refer to Trees and Landscaping Notes

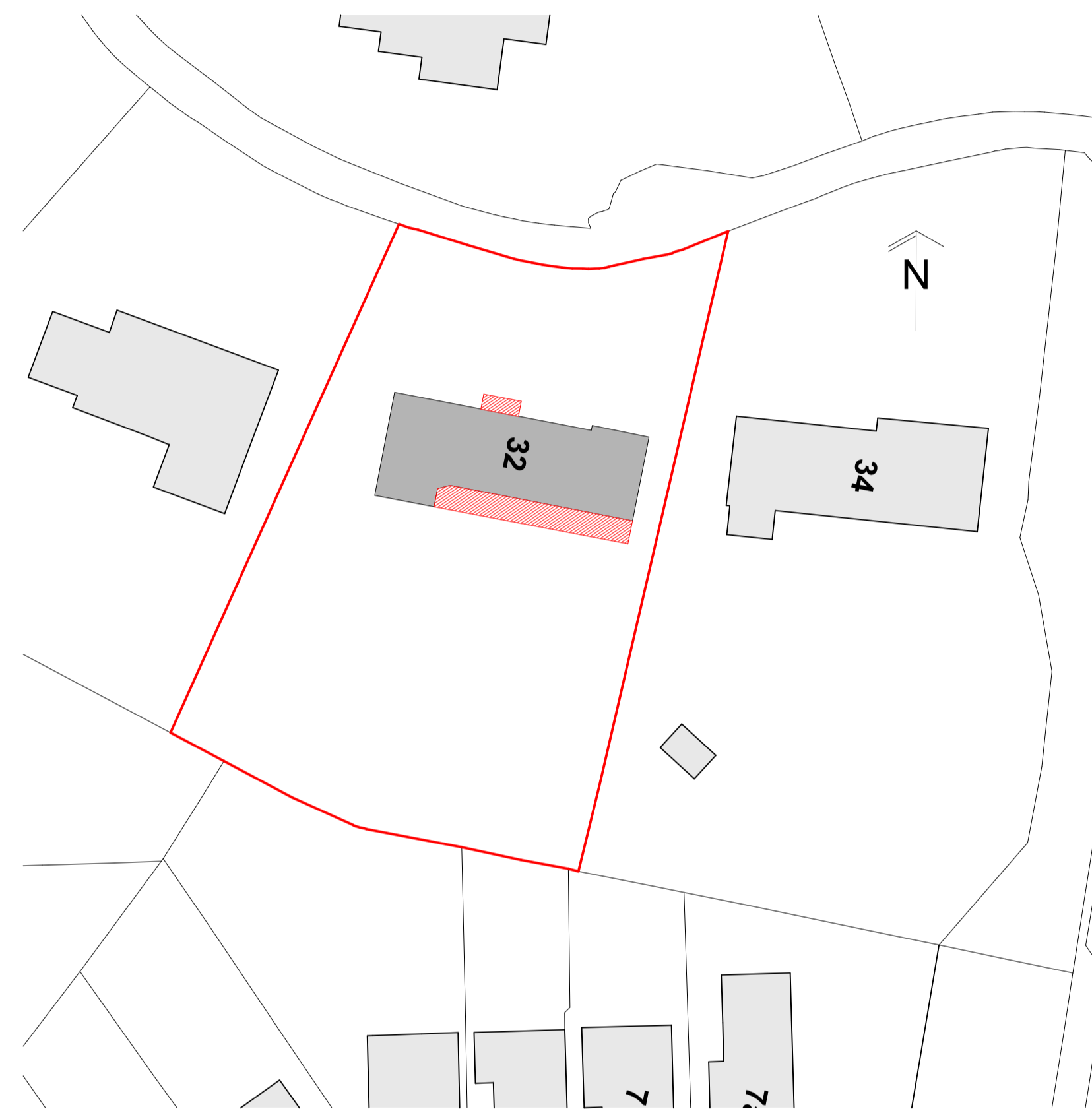
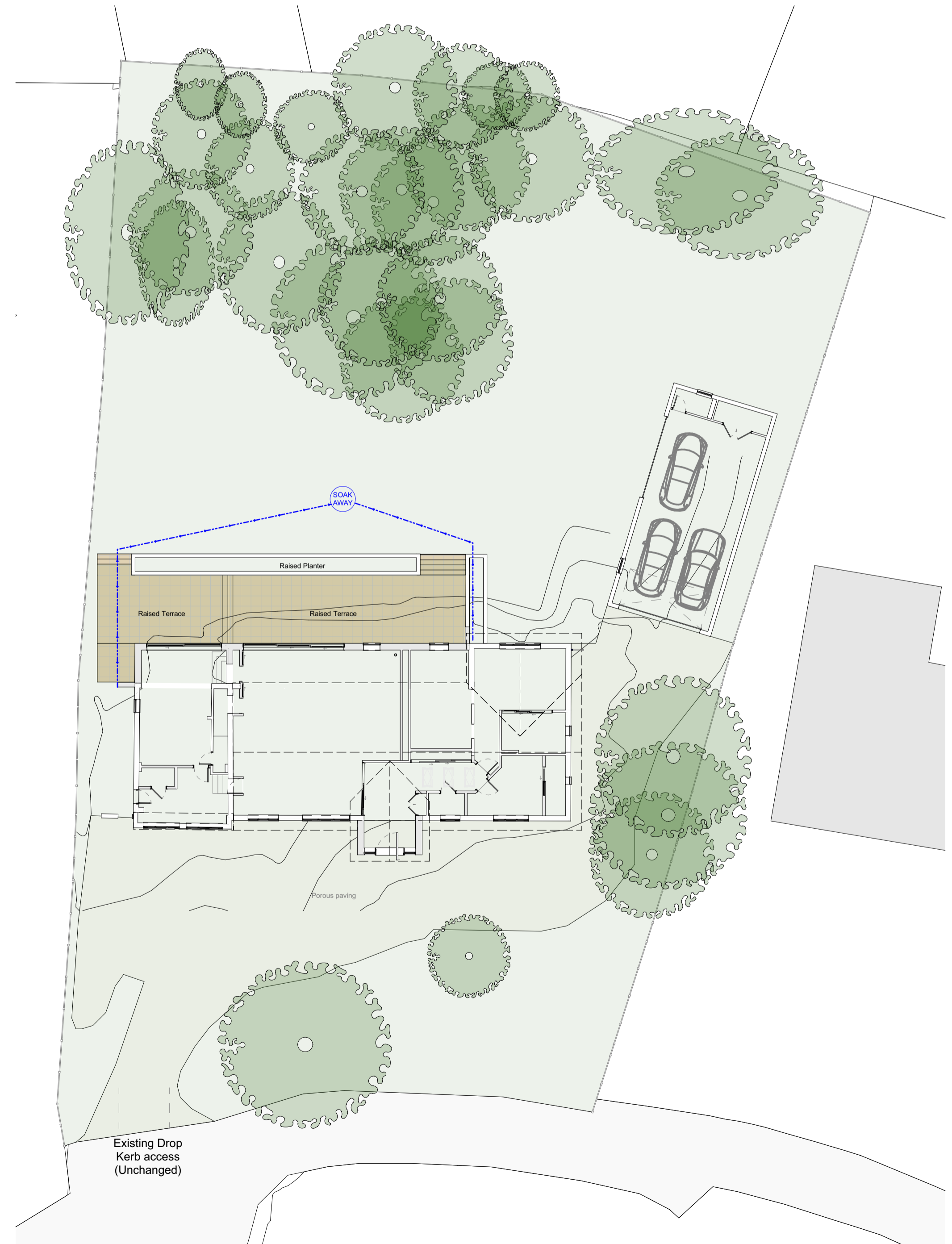

REV	19/01/2024	Internal a/c, porch fenestration a/c, add velux
CLIENT	Mr & Mrs Jones	
PROJECT	32 Ashwood Drive BH18 8LN	
ADDRESS	32 Ashwood Drive BH18 8LN	
DRAWING	Site and Block Plans	
STATUS	Preliminary	
DATE	Jan 24	
SCALE @ A1	1:200, 1:500	
DRAWING N°	2066-00-001	REVISION A

Asplan
 DESIGN - PLANNING - APPROVAL
 Architecture, Planning & Building Consultancy
 Chartered Surveyors & Building Engineers
 info@asplan.co.uk 07968 585858

CBUILD chartered building engineer **RICS** chartered building engineer

ISSUE SCHEDULE
 Preliminary Building Regs
 Planning Construction

©Asplan Registered Trade Mark No. UK0000219822. Copyright © 2017 Asplan Associates Ltd. This drawing has copyright protection and may not be reproduced without written permission from Asplan Associates Ltd. The Contractor is responsible for checking the dimensions on site and any discrepancy to be verified with Asplan Associates Ltd prior to the commencement of any building works or fabrication. This drawing is not to be scaled and must be read in accordance with all associated architectural, surveying, engineering and service drawings. Asplan Associates Ltd do not accept responsibility for errors associated with CAD data or information produced by third party surveys. IF IN DOUBT ASK!

1m at 1:500	0	1	2	3	4
1m at 1:200	0	1	2	3	4
1m at 1:100	0	1	2	3	4
1m at 1:50	0	1	2	3	4
1m at 1:250	0	1	2	3	4