

This drawing is copyright. It is sent to you in confidence and must not be reproduced or disclosed to third parties without our prior permission. Do not scale from this drawing. This drawing is to be read in conjunction with all relevant consultants, specialist manufacturers drawings and specifications. Any discrepancies in dimensions or details on or between these drawings should be drawn to our attention. All dimensions are in millimeters unless noted otherwise. Any surveyed information incorporated within this drawing cannot be guaranteed as accurate unless confirmed by fixed dimension.

REV	DESCRIPTION	BY	CHKD	DATE
P01	FIRST PRELIMINARY ISSUE	MR	NB	23/01/2024
P02	RAMP, STEPS, COURTS UPDATED	MR	NB	13/02/2024
P03	STEPS UPDATED	MR	NB	21/02/2024
P04	ACCESS CONTROL ADDED TO PEDESTRIAN GATE. SPORTS COURT FENCING NOTE AMENDED.	MR	NB	22/02/2024
C01	FIRST CONSTRUCTION ISSUE	MR	NB	01/03/2024
C02	ALT. TO EX TENNIS COURT FENCING. ALT. TO DOUBLE GATE AND FENCE TO ACCESS ROAD. ALT. TO EXISTING WELD MESH FENCE LINE	MR	NB	14/03/2024

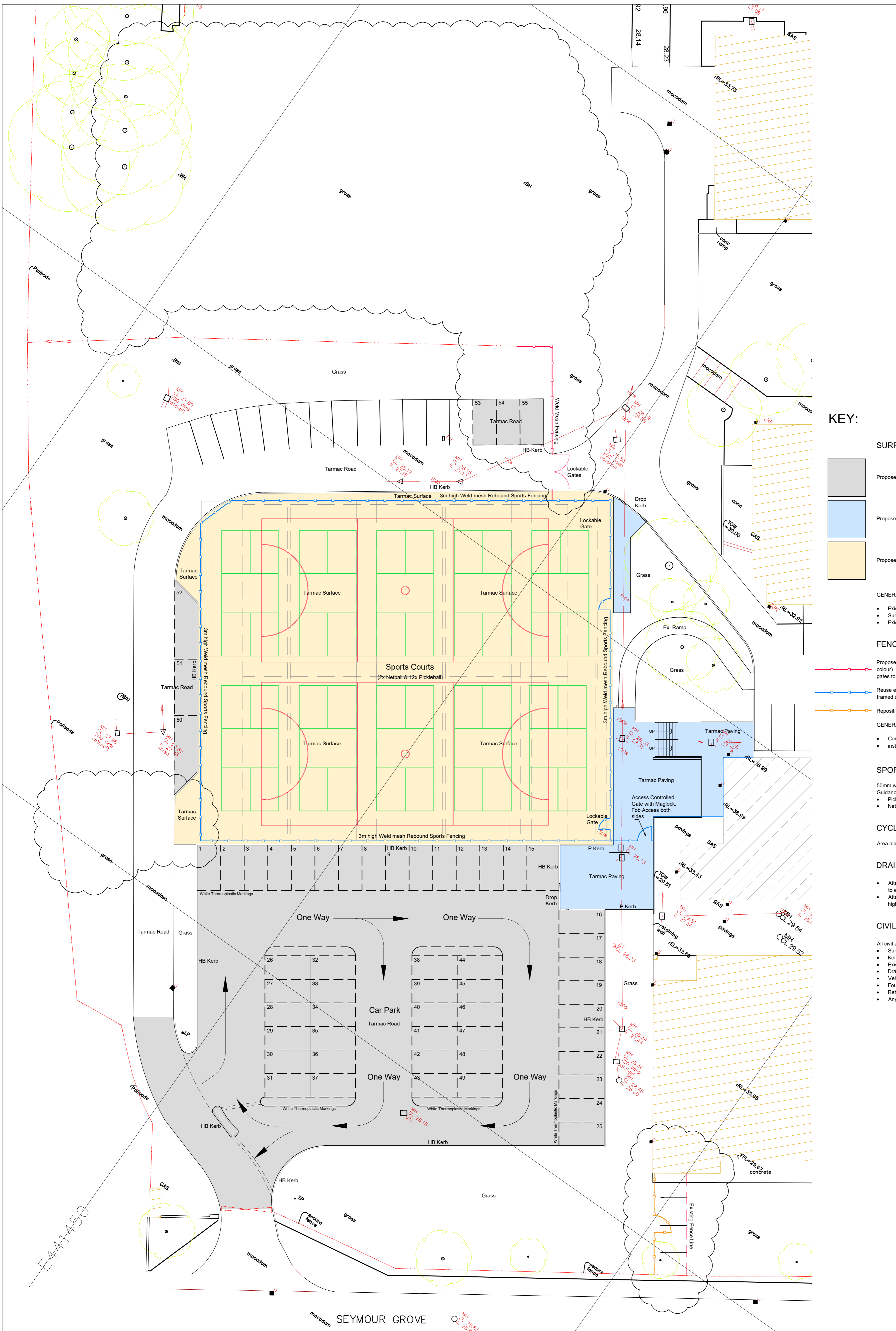

KEY:

- SURFACING**
- Proposed Tarmac Surface (Road Construction)
 - Proposed Tarmac Surface (Paving Construction)
 - Proposed Tarmac Surface (Sports Courts)

- GENERAL SURFACE NOTES:**
- Existing & proposed grass areas to be made good, prepared and seeded
 - Surfacing to proposed steps and ramp as larger scale details
 - Existing surfacing to remain as existing unless identified otherwise

- FENCING**
- Proposed weld mesh fencing to match existing perimeter fencing (Height, type and colour). Lockable framed double gates to match existing (100mm max. gap below closed gates to road surface)
 - Reuse existing weld mesh sports fencing from tennis courts. Colour: Existing. Lockable framed single gates to provide 1200mm clear opening
 - Reposition & Reuse existing weld mesh fencing with lockable gate.

- GENERAL FENCING NOTES:**
- Contractor to coordinate kerbing and fence post foundations and haunching
 - Installation in accordance with manufacturers instructions and recommendations

- SPORTS COURT MARKINGS**
- 50mm wide slip-resistant sports court markings in accordance with Sport England Guidance (not Sport England Funded)
- Pickleball - White
 - Netball - Yellow

- CYCLE PARKING**
- Area allocated for cycle parking. Details to be agreed with client/school

- DRAINAGE**
- Attenuation tank to be positioned below new car park surface to minimise disruption to existing soft landscaped areas
 - Attenuation tank drainage connection within the school where practical to avoid highway connection if possible

- CIVIL & STRUCTURAL DESIGN**
- All civil and structural design by BGP to include but not limited to the below:
- Surfacing and design buildups
 - Kerb layouts and design detailing
 - Existing and proposed levels and coordination
 - Drainage design and detailing
 - Vehicle tracking checks
 - Foundations
 - Retaining Walls
 - Any other civil or structural design information

PROPOSED SITE PLAN

1:200

PURPOSE: CONSTRUCTION	
PROJECT: Car Park & Court Areas Egglecliffe School & Sixth Form College for Stockton-on-Tees Borough Council	
DESCRIPTION: Proposed Site Plan	
DRAWN BY: MR	SCALE: 1:200
SHEET SIZE: A1	DATE: January 2024
PROJ NO: 23186	ORIG: HL
VOLUME: ZZ	LEVEL: 00
TYPE: DR	ROLE: A
NUMBER: 2001	SUITABILITY: D2
REV: C02	

HOWARTH LITCHFIELD

Liddon House, Belmont Business Park, Durham, DH1 1TW.
 Tele: (0191) 3849470 E: hlp@hlpuk.com www.howarthlitchfield.com

Copyright and all intellectual property rights remain vested in Howarth Litchfield Partnership Limited