

## STATUTORY DECLARATION

I, DOUG GRIFFITH, DO SOLEMNLY AND SINCERELY DECLARE as follows:

1. That my full name is Douglas John Griffith and I live at Byways, Church Farm Lane, East Wittering with my wife Joyce. The extent of our ownership is edged with a red line on the plan attached at DG1.
2. In 2013 we obtained a Certificate of Lawfulness of Proposed Use or Development to "*Construct a new ancillary residential building to be used as a double garage and hobby room*" under council reference EWB/13/00719/ELD.
3. We commenced works on the building in March 2014 and completed it in early 2015. Whilst there were a few minor changes to the fenestration and internal layout of the building I did not consider that those mattered as it was not a planning permission that we obtained and the use remained incidental to the main house. The floor plan of the building as completed is attached at DG2. Its location is cross hatched on the plan at DG1. As completed the building had a main machinery store area with a gym to one side and a store for canoes and surf boards the other side. It had a concrete floor throughout, but had insulated external walls. Receipts for the base works; OSB for the structural timber walling; windows; and the garage door which I recall was the final item in February 2015 are attached at DG3.
4. At that time our son, Andrew, lived with us in our property and he was 27 years old when the building was completed. A lot of the items stored in the building were his and he would be in the building most days. I think from this he felt it would be much better if he had his own independence and he asked us if it could be converted so he could live in it and be independent. We agreed to this and commenced works on converting the building in November 2015.
5. We undertook the works slowly due to time and cost restraints. First, I insulated the loft; installed the heating pipes; and plasterboarded the walls and fitted a bathroom. This was in October / November 2015 and I attach receipts for those works at DG4. At this time the building continued to be used with a gym and for storage – ie for purposes incidental to our house.
6. Works then stopped at the end of 2015, due to finances, and did not recommence until the summer of 2016 with the fitting of a gas boiler in June 2016; lighting in September 2016; kitchen units, white goods and shower door in late December 2016 and I attach receipts for those works/items at DG5. The works were completed in March and our son and his [then] girlfriend, Emma, moved into it on 1<sup>st</sup> April 2017.
7. At that time, we erected a fence between the two properties in order that we could all have our own private space and privacy. The alignment of the boundary fence is indicated with a blue line on the plan at DG1.

8. They are now married and our grandson was born on 15 March 2021.
9. I attach at DB6 a floor plan of the building as converted and confirm that this has been its layout since the end of March 2017 to the present day.
10. I can confirm that since 1<sup>st</sup> April 2017 the converted outbuilding dwelling has been continually occupied by our son and now daughter-in-law. They have all the facilities they require to live wholly independently from my wife and I. They are not dependant on us for anything nor us on them.

AND make this Declaration SOLEMNLY AND SINCERELY  
Believing the same to be true by  
Virtue of the Statutory Declarations Act 1835.



DECLARED at )  
In the County of )  
This the 15<sup>th</sup> day of March 2024 )



Before me,   
A Solicitor/Commissioner for Oaths.

LISA CARR  
CARR SOLICITORS  
115 HIGH STREET  
SELSEY, CHICHESTER  
WEST SUSSEX, PO20 0QB  
01243 606 883

This is the document marked "DG1" referred to in the  
Affidavit of Doug Griffith sworn this 15<sup>th</sup> day  
of March 2024



Before me

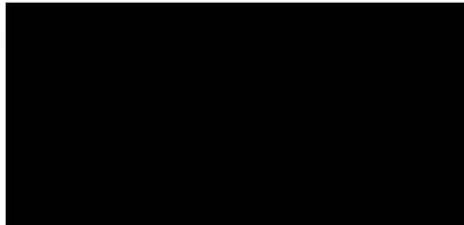

LISA CARR  
CARR SOLICITORS  
115 HIGH STREET  
SELSEY, CHICHESTER  
WEST SUSSEX, PO20 0QB  
01243 606 883

Solicitor / Commissioner for Oaths

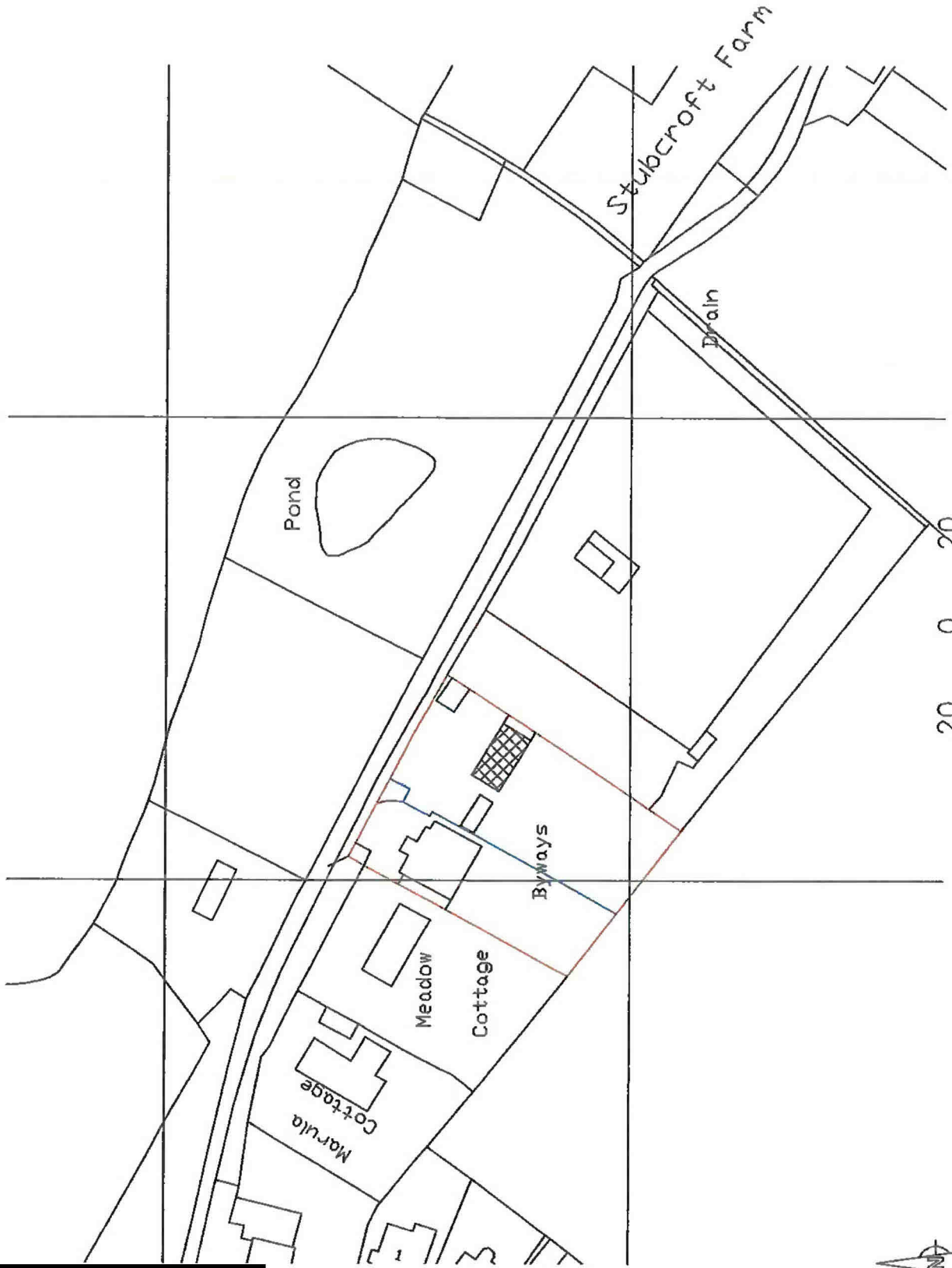
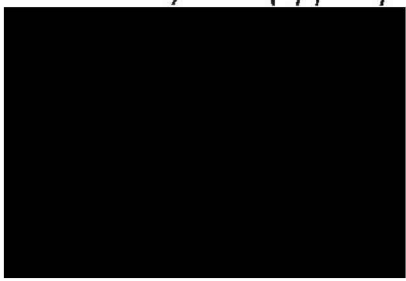

This is the document marked "DG2" referred to in the  
Affidavit of Doug Griffith sworn this 15<sup>th</sup> day  
of *November* 2024

Before me

LISA CARR  
CARR SOLICITORS  
115 HIGH STREET  
SELSEY, CHICHESTER  
WEST SUSSEX, PO20 0QB  
01243 606 883

*Solicitor* / Commissioner for Oaths

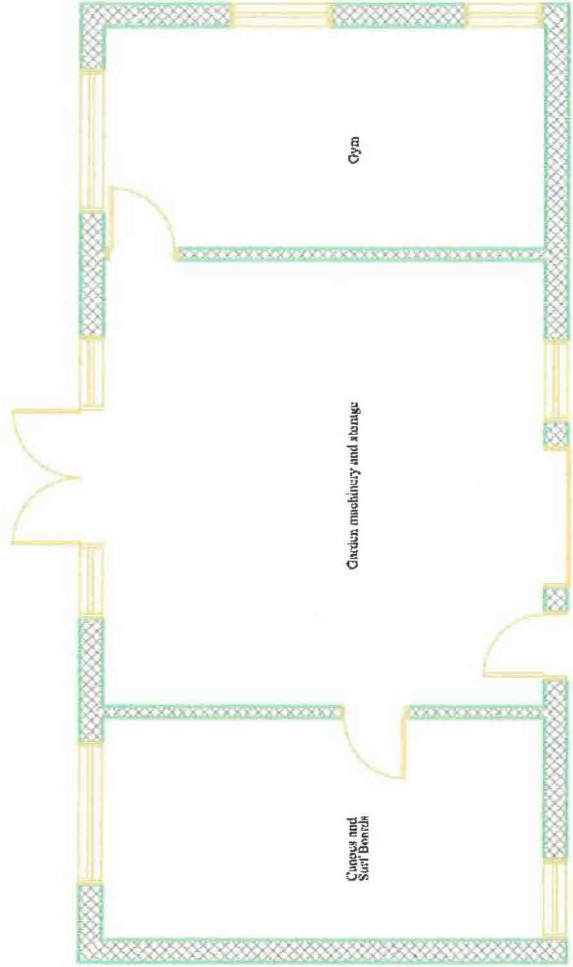
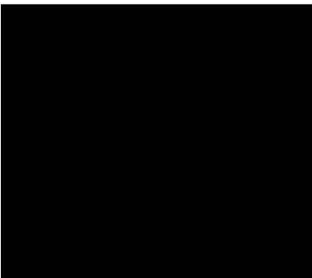

DATE	NO.	BY	DATE	NO.	BY
10/10/2010	1	STEPHEN JUPP	10/10/2010	3	STEPHEN JUPP

STEPHEN JUPP ARCHITECTS  
100, RIVERVIEW ROAD  
MELBOURNE VIC 3000  
PH: 03 9412 1234  
WWW.SJA.AU

This is the document marked "DG3" referred to in the  
Affidavit of Doug Griffith sworn this 15<sup>th</sup> day  
of March 2024

Before me



LISA CARR  
CARR SOLICITORS  
115 HIGH STREET  
SELSEY, CHICHESTER  
WEST SUSSEX, PO20 0QB  
01243 606 883

Solicitor / Commissioner for Oaths



55 Shore Road  
East Wittering  
Chichester  
West Sussex  
PO20 8DY

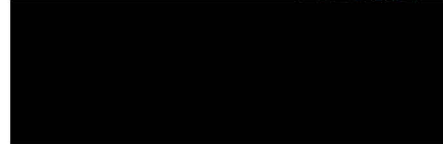

Proud members of

**Checkatrade.com**  
Where reputation matters

**CLIENT**

Doug & Joyce  
Byways  
East Wittering  
West Sussex

13.07.14

**INVOICE**

**JOB DESCRIPTION**

Construct concrete base for timber building approx. 85sqm. Excavate area dig footing to perimeter and 2no bay footings lay 4 coarse brickwork on footings install 100-150mm well compacted hardcore to oversite lay 1200 guage polythene membrane finish with 150mm ready mix concrete. Install 3no drainage/ service pipes 2 supplied by client.

All materials /labour supplied (waste soil removed by client)

Total charge

~~£4510.00~~ £4400 - Paid in full 14/7/14.

Thankyou for your custom

Please make cheques payable to G McGuiness

**CONTRACTOR:**

**G.McGUINESS**

**KIND REGARDS**





914742677168135080

# SALES ADVICE (Customer Copy)

Page : 1 of 3

## Customer Details

Mr & Mrs Griffith  
Byways  
Church Farm Lane  
East Wittering  
CHICHESTER  
PO20 8PT

## Delivery Address

Mr & Mrs Griffith  
Byways  
Church Farm Lane  
East Wittering  
CHICHESTER  
PO20 8PT

## Store Details

0686 - HAVANT WH

Order No.	Date	Customer No.	Reference No.
68135080	31.03.2014		

Line	EAN/Barcode	Description	Note	Qty	Unit Price (inc VAT)	Total Price (exc VAT)	VAT	Total (inc VAT)
0001	03161388	DBL SIDE CTR T/F CEMENT 1760X1120 Clearance Discount	SC	2	289.00	481.67	96.33	578.00
						316.67-	63.33-	260.00
<b>Total</b>						£165.00	£33.00	£198.00

REGISTERED OFFICE: B&Q PLC, B&Q HOUSE, CHESTNUT AVENUE, CHANDLERS FORD, EASTLEIGH, HAMPSHIRE SO53 3LE.  
REGISTERED IN ENGLAND No. 973387

This is not a VAT Invoice



is Perkins

Travis Perkins Trading Company Limited

Registered in England No. 733503

VAT REGN. No. GB 408 5567 37

TRAVIS PERKINS TRADING CO. LTD  
HILTON GREEN CAMP, 2RD OXFORD  
WICHESTER

CASH INVOICE

07809460

BRANCH	TEL:	DELIVERY INDICATOR	DATE
88228 ANDREW GRIFFITH GROUND MAINT ways Church Farm Lane East Wittering Wichester PO20 8PT	01242 512923		20/07/14 10:21
	BYWAYS CHURCH FARM LANE EAST WITTERING PO20 8PT	CONTACT : TEL NO : 01243673800 DATE REORD : 04/08/14	HACHR CR/DB

1 STRUCTURAL OSB 3 24*0Y(220x18MM FSC 803928 PROMOTION	50.00 SHEET	15.99 EACH	799.50	20.00	159.90	1617.40kgs
* TOTAL ORDER WEIGHT		1617.400 kgs	(LINES 1)			

The indicated weights on this document are approximate and are intended to assist in manual handling considerations. Building aggregate material weights allow for a +/- 5% tolerance.

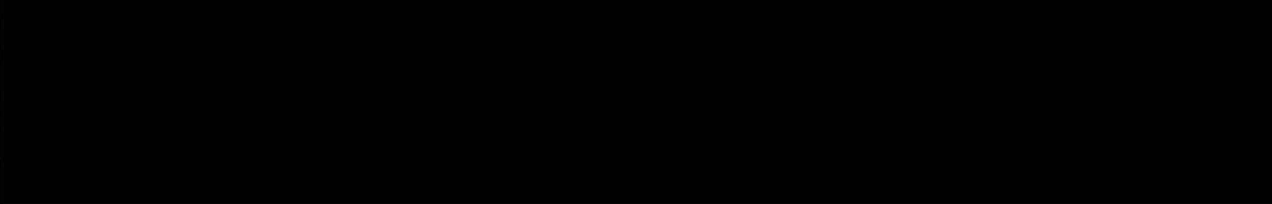

damages must be reported within 2 working days and damages must be reported within 7 days of receipt of materials.

**Health & Safety:** For information on products (e.g. COSHH) please visit [www.travisperkins.co.uk](http://www.travisperkins.co.uk). Contact the Dept. during office hours on 04) 752424 if data not available.

This slip confers no rights to remove items from our branches. An invoice or delivery note must be obtained from our staff. A delivery note is not a receipt.

SIGNATURE	TIME
PRINTED	DATE

799.50	
159.90	***
959.40	*****

PLEASE SEE REVERSE FOR TERMS OF SALE/HIRE



# HOWDENS JOINERY CO.

Taxpoint Date: 12/02/2015 16:06  
Account: [REDACTED]

## CASH INVOICE

Mr AG Griffith  
[REDACTED]  
PO20 8PT



Your Contact: Mr Andrew Griffith  
Contact No:  
Your Reference:

Qty	Product	Disc%	Net V
1	DXG0110 Softwood FL&B Garage 6'6"x7'0"	66.49	157.49 SF

Only products marked F (FSC) or P (PEFC) above are certified as follows: : :

FSC Mix 70%, SA COC 001813  
70% PEFC Certified, SA-PEFC/COC-001813

Merchant No :	[REDACTED]	Source :	Chip and PIN
Date & Time :	[REDACTED]	TID Seq No :	3710
Card Type :	[REDACTED]	Start Date :	01/07/2013
Card No :	[REDACTED]	Expiry Date :	30/09/2016
Auth Code :	[REDACTED]		

AiD : [REDACTED]  
Sales Value : 188.99GBP  
Transaction : 825373  
Terminal ID : 20229972  
Issue No : [REDACTED]  
PAN Seq No : [REDACTED]

Your account will be debited with the above amount  
Card Verified by PIN

Rate	Goods	VAT		
S 20.00	157.49	31.50	Order Value :	188.99
			Previous payments :	0.00
			Current Payment :	188.99
			Goods supplied :	0.00
			Outstanding :	0.00

All prices are in Sterling

Payment details:-

X Visa Delta 188.99

Depot: HJ Chichester Manager: Garry Gwilym  
Address: Units 1 & 2, Terminus Road, Chichester, West Sussex, PO19 8TX

Tel: 01243 530737 Fax: 01243 530184  
E-mail: chichester@howdens.com

This is the document marked "DG4" referred to in the  
Affidavit of Doug Griffith sworn this 15<sup>th</sup> day  
of March 2024



Before me

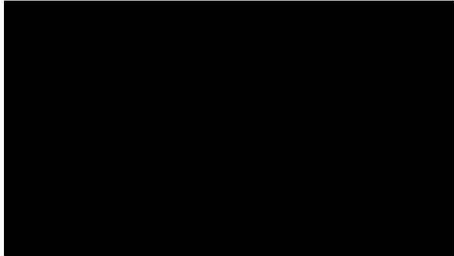

LISA CARR  
CARR SOLICITORS  
115 HIGH STREET  
SELSEY, CHICHESTER  
WEST SUSSEX, PO20 0QB  
01243 606 883

Solicitor / Commissioner for Oaths



**Covers Home Ideas Branch**

Sussex House, Quarry Lane, Chichester, West Sussex, PO19 8PE  
Tel: 01243 785141 Fax: 01243 531151 Email: enquiries@covers.biz

"We look for Certification from Suppliers to ensure Chain-of Custody and we will not trade in timber species which are either endangered (thereby appearing on the World Conservation Union Red list) or procured by immoral practice. Only the products that are identified as such on this document are PEFC or FSC ® Certified."



**Cash Sales Invoice**

**Invoice Address**  
Cash Sale Account  
Mr Griffith  
Byways  
East Wittering

**Invoice No** [REDACTED]  
**Invoice Date** 11/11/15 11:27  
**Customer** ZCash  
**Sales Order** 10668375  
**Your Ref**  
**Raised By** Samuel Willingale  
**Sale Type** Collected  
**Till** Sx Hse Trade 1

No.	Description	Quantity	Price (Ex-Vat)	Total	VAT	Rate
1	B8308 - Supaloft Green 150mm x 575mm (2 Pack) 6 Sq Mtr	11 ea	44.00 ea	484.00	96.80	20.00

SECURITY

VAT Registration No: 322 0083 17  
Registered in England No: 396804

Printed 11/11/2015 11:27:39



Total Amount	£484.00
Total VAT	£96.80
Invoice Total	£580.80

All orders are subject to our standard terms and conditions , available on request, or for these and a full list of our depots please visit [www.covers.biz](http://www.covers.biz)

ORDER NO: 150166

<b>BRANCH</b>	150166	<b>TEL:</b>	01243 73800	<b>DELIVERY INDICATOR</b>		<b>DATE</b>	05/11/15
7980 DREW DRIFTH LROUND MINT ways urch Farm Lane Wittering chester 20 BPT			BYWAYS CHURCH FARM LANE EACT WITTERING 2020 BPT				

BRITISH GYPSUM GYPROC PLASTERBOARD 2400X1200X12.5MM SQUARE EDGE 750054	20.00 SHEET	5.29 SHEET	158.40	20.00	31.68	733.00kg
BRITISH GYPSUM GYPROC PLASTERBOARD 1800X900X12.5MM SQUARE EDGE 750051	14.00 SHEET	4.42 SHEET	61.88	20.00	12.38	134.60kg
BRITISH GYPSUM GYPROC FIRELINE BOARD 2400X1200X12.5MM STRAIGHT EDGE 750145	3.00 SHEET	8.65 SHEET	25.95	20.00	5.19	92.10kg
ATKINS SCREWS DRYWALL 3.5/38MM BUSH HEAD BLACK BRX 500 28830	1.70 BOX	10.41 BOX	9.21	20.00	1.84	1.40kg
STANLEY FATMA AL SHEET TAPE 25X15 5-33-080 51762	1.00 EACH	17.99 EACH	17.99	20.00	3.60	0.45kg
<b>TOTAL ORDER WEIGHT</b>			<b>1023.163 kg</b>			<b>(LINES 1, 2, 3, 4, 5)</b>

Indicated weights on this document are approximate and are intended to assist in manual lifting considerations. Building aggregate material weights allow for a +/- 5% tolerance.

Goods must be reported within 2 days and damages must be reported within 7 days of receipt of materials.

& Safety: For information on this (e.g. COSHH) please visit [travisperkins.co.uk](http://www.travisperkins.co.uk). Contact the branch during office hours on 01243 752424 if data not available.

Travis Perkins Trading Company Limited confers no rights to remove goods from our branches. An invoice or note must be obtained from branch staff. A delivery note is not a receipt.

SIGNATURE	TIME
PRINTED	DATE

**PLEASE SEE REVERSE FOR TERMS OF SALE/HIRE**



**Covers Home Ideas Branch**

Sussex House, Quarry Lane, Chichester, West Sussex, PO19 8PE  
Tel: 01243 785141 Fax: 01243 531151 Email: enquiries@covers.biz

"We look for Certification from Suppliers to ensure Chain-of Custody and we will not trade in timber species which are either endangered (thereby appearing on the World Conservation Union Red list) or procured by immoral practice. Only the products that are identified as such on this document are PEFC or FSC @ Certified."



**Cash Sales Invoice**

**Invoice Address**  
Cash Sale Account  
Mr Griffith  
Byways  
East Wittering

**Invoice No** [REDACTED]  
**Invoice Date** 11/11/15 11:27  
**Customer** ZCash  
**Sales Order** 10668375  
**Your Ref**  
**Raised By** Samuel Willingale  
**Sale Type** Collected  
**Till** Sx Hse Trade 1

No.	Description	Quantity	Price (Ex Vat)	Total	VAT	Rate
1	B8308 - Supaloft Green 150mm x 575mm (2 Pack) 6 Sq Mtr	11 ea	44.00 ea	484.00	96.80	20.00

**SECURITY**

VAT Registration No: 322 0083 17  
Registered in England No: 396804

Printed 11/11/2015 11:27:39

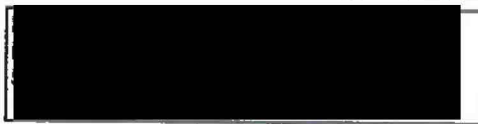

Total Amount	£484.00
Total VAT	£96.80
Invoice Total	£580.80

All orders are subject to our standard terms and conditions , available on request, or for these and a full list of our depots please visit [www.covers.biz](http://www.covers.biz)

ore  
 Trade Park  
 ay Road  
 G NOR REGIS  
 West Sussex  
 PO22 9GH

Contact: Karen Carter  
 Tel: 01243 863900  
 Fax: 01243 867444  
 Email: bognorregis@bathstore.com



Invoice To:  
 Mrs. Joyce Griffith  
 Byways  
 Church Farm Lane  
 East Wittering  
 CHICHESTER  
 PO20 8PT

Deliver To:  
 The Bath Store  
 Unit 2-3  
 Shripney Trade Park  
 Shripney Road  
 BOGNOR REGIS  
 PO22 9GH

Date: 18/10/2015  
 Time: 13:34  
 Your Ref:  
 Doc Ref: 61548193  
 Order Date: 18/10/2015  
 Delivery Date: 22/10/2015

Cash Invoice

In Product Description	Quantity	Unit Price	Total
2 DENVER CORNER WC ** KIT ** SOFT CLOSE SEAT INC PAN CISTERN FITTINGS Comprising:			
3 > DENVER CORNER CISTERN WHT EXCLUDING FITTINGS	1 Each	24.06 LP	24.06
4 > DENVER CLOSE COUPLED PAN WHT	1 Each	19.25 LP	19.25
5 > DENVER & MONTE THERMOSET SOFT CLOSE SEAT WHT SINGLE BUTTON RELEASE	1 Each	38.49 LP	38.49
6 > DUAL CISTERN FITTINGS CITY DEN EURO MYTIME SOHO TRIO WATER MK2	1 Each	43.30 LP	43.30
12 Delivery charge (FREE store collect & Franchise)	1 Each	0.00 EA	0.00

Rate	Goods	VAT	Payment details:-	Order Value	:	125.10
s 20.00	104.25	20.85	Debit / Credit Cards 125.10	Previous Payments	:	0.00
				Current Payment	:	125.10
				Goods Supplied	:	0.00
				Outstanding	:	0.00

Unit Prices are in Base currency and include VAT at the current applicable rate.

Bath Store.com Limited trading as Bath Store. Registered address: 2nd Floor Meridian House, 69-71, Camerton Road, Wiltford, Wiltshire, WID17 1DS. Registered in England. No. 022240475. VAT Registered No. 125 5170 37



This is the document marked "DG5" referred to in the  
Affidavit of Doug Griffith sworn this 15<sup>th</sup> day  
of *March* 2024 

Before me 

 Solicitor / Commissioner for Oaths

LISA CARR  
CARR SOLICITORS  
115 HIGH STREET  
SELSEY, CHICHESTER  
WEST SUSSEX, PO20 0QB  
01243 606 883

# B & K O'DWYER LTD

Plumbing & Heating

Manor Farmhouse  
Earmley  
CHICHESTER  
West Sussex PO20 7JL  
Tel: 01243 624040  
Email: office@bkod.co.uk  
www.bkod.co.uk

## ESTIMATE

To: Joyce

Estimate No: [REDACTED]

Date: 15/06/2016

### Comments or special instructions:

RE: Byways, Church Farm Lane, East Wittering, PO20 8PT

Description	Amount
To supply and fit Vaillant Elite 832 combination boiler	
Pipe up new gas supply	
Pipe hot, cold and heating pipes in copper	
Supply and fit primary filter	
Run condensate drainage	
Flush system and add inhibitor	
Test and commission system	
Complete gas notification and provide benchmark forms	
Provide a 7 year guarantee via registration into the Vaillant Advance Installer programme	
	LABOUR: £450.00
	MATERIALS: £1,458.09
	Sub total £1,908.09
	VAT @ 20% £381.62
	TOTAL £2,289.71

### Terms and conditions:

1. All pricing is subject to VAT
2. 50% deposit is required on placement of order
3. All sums due to B & K O'Dwyer Ltd shall be payable immediately by the customer upon receipt of relevant invoice.



Order Ref: XXXXXXXXXX  
Customer: XXXXXXXXXX  
Order Date: 07/09/2016  
Delivery Date: 07/09/2016

# Sale Acknowledgement

**National Lighting**  
Everything lights & more

Document Type Order Acknowledgement

**Invoice To:**  
CASH SALE

**Delivery To:**  
CASH SALE

Genesis 1:3 Ltd  
T/A National Lighting Limited  
8 Grand Union Trading Estate  
Abbey Road  
Park Royal  
London  
NW10 7UL  
Tel Accounts: 0845 201 0212  
Website: [www.nationallighting.co.uk](http://www.nationallighting.co.uk)  
Email: [helpdesk@nationallighting.co.uk](mailto:helpdesk@nationallighting.co.uk)  
VAT Reference: VAT No: 608054752

<u>Code</u>	<u>Description</u>	<u>Qty</u>	<u>Unit</u>	<u>Total</u>
39168	KNIGHT TRIPLE CEILING BAR CHROME 3X35W GU10 IP44 ✓	1	66.60	66.60
39617	COSMO TRIPLE PLATE CEILING CHROME 25W G9 IP44 ✓	2	42.30	84.60
61003	AMALFI 6X50W GU10 SATIN NICKEL ✓	4	26.10	104.40
G2521313	AMALFI 2 BAR 2X50W GU10 SAT/NCKL ✓	1	9.78	9.78
1685	5W SMD GU10 SPOTLIGHT WARM WHITE 320LM 110DEG	24	1.98	47.52
47996	LED GU10 5.5W 240V SMD 6000K	5	4.08	20.40
61685	12.3W GLS LED DIMMABLE W/WHITE E27 1060LM	2	6.60	13.20
G9LED7	G9 230V 4W LED CAPSULE DIMMABLE 4000K	6	7.14	42.84
9612982	ARTO OUTDOOR HANGING WALL LIGHT IN HIGH-GRADE STEEL ✓	2	26.40	52.80

### Notes / Special Instructions

All shortages or damaged goods must be reported in writing within 48hrs upon receipt of goods. Any claims made thereafter will not be accommodated. Damages must be kept in original packaging. TERMS & CONDITIONS APPLY.

Delivery: 0.00  
Subtotal: 368.45  
VAT: 73.69  
Total: 442.14

**Customer Address:**

Mrs Joyce Griffith  
Byways  
Church Farm La  
CHICHESTER  
PO20 8PT

# Wickes

## Let's do it right

**Delivery Address:**

Mrs Joyce Griffith  
Byways  
Church Farm La  
CHICHESTER  
PO20 8PT

**Design Consultant:**

Wendy Thompson  
Direct Tel:

**Order No: 058978****Version No: 1****Order Date: 28 December 2016****Store:**

Chichester 058  
Barnfield Drive  
Chichester

VAT Number : 408556737

Item Description	Qty	Unit List Price	Unit Offer Price	Total Discount	Total Offer Price
<b>Components &amp; Fittings</b>		<b>£ 56.53</b>			
114060 Adeline Bar Handle - Large	5	8.00	8.00	7.70	32.30
114060 Adeline Bar Handle - Large	3	8.00	8.00	4.62	19.38
212912 WORKTOP JOINER BOLT - PACK OF 3	1	6.00	6.00	1.15	4.85
<b>Style Kitchens</b>		<b>£ 1,231.99</b>			
125854 GLEN WHT 600mm HL Base Unit	1	342.00	171.00	210.82	131.18
125876 GLEN WHT 925mm HL Corner Base Unit	1	536.00	268.00	330.41	205.59
125892 GLEN WHT 2.6m Plinth	1	64.00	32.00	39.45	24.55
125962 GLEN WHT 600mm Larder Unit	1	706.00	353.00	435.20	270.80
125982 GLEN WHT 18mm Decor Base End	2	214.00	107.00	263.84	164.16
125984 GLEN WHT 18mm Decor Tower End	2	338.00	169.00	416.72	259.28
125986 GLEN WHT 18mm Decor Tall Wall End	2	102.00	51.00	125.76	78.24
126007 GLEN WHT 300mm Tall Wall Unit	1	256.00	128.00	157.81	98.19
<b>Worktops</b>		<b>£ 215.61</b>			
142950 Laminate Black Stone Colourfill	1	9.00	9.00	1.73	7.27
213080 Laminate Black Stone WT 36x600x3000mm	2	129.00	129.00	49.66	208.34

**Discounts Applied**

<b>Sale Discount</b>	<b>£ 1,606.00</b>
Kit - Winter Sale 2017 Early Bird	£ 68.26
Kit - Winter Sale 2017 Additional 15%	£ 291.45
Kit - Winter Sale 2017 DC Deal 5	£ 79.16
<b>Total Additional Discount</b>	<b>£ 438.87</b>

<b>Total List Price</b>	£	<b>3,549.00</b>
<b>Delivery</b>	£	<b>0.00</b>
<b>Discounts</b>	£	<b>2,044.87</b>
<b>Total Product Price</b>	£	<b>1,504.13</b>
<b>Installation Price (Exc. Specialist Works)</b>	£	<b>0.00</b>
<b>Total Product Price (Exc. Installation)</b>	£	<b>1,504.13</b>

**Payment Method**

Card [REDACTED] 28/12/2016 £ 1,504.13

**Supplier Orders**

[REDACTED]

Thank you for choosing Wickes for your project. In a few days our Home Delivery Centre will make contact to start the arrangements necessary to prepare your order for delivery. Our aim is to complete your order within the published lead time and although we will be pleased to agree a later date, whilst you make plans, we must deliver your order no later than six months from today's date after which time it will be automatically cancelled.

Order Date: 28 December 2016

1 of 4



**David Cover & Son Ltd**  
**Covers Home Ideas Branch**

Sussex House, Quarry Lane, Chichester, West Sussex, PO19 8PE  
Tel: 01243 785141 Fax: 01243 531151 Email: enquiries@covers.biz

## Payment Receipt

**Invoice Address**  
Cash Sale Account  
Mr Griffith  
Byways  
Church Farm Lane  
East Wittering  
PO20 8PT

**Order No** [REDACTED]  
**Order Date** 22/12/16 14:30  
**Customer** ZCash  
**Delivery** On 22/12/2016  
**Sale Type** Collect Later  
**Raised By** Gavin Stephens  
**Rep** 02  
**Till** Sx Hse DIY 3

Your Ref : Griffith

Page 1 of 1

Special Instructions	Notes

No.	Description	Qty	Price (Ex Vat)	Total
1	B12730 - Haven Slider 1200x1850 Shower Door H2S12CS	1 ea	133.33 ea	£ 133.33

Received With Thanks :  
22-Dec-2016 14:32 £ 160.00 [REDACTED]

Total Goods	£ 133.33
Total VAT	£ 26.67
Total Amount	£ 160.00

Printed 22/12/2016 at 14:33:23

Title of goods does not pass until payment has been received. Subject to our terms and conditions of sale. Copies available on request.  
PLEASE NOTE: We are unable to accept the return of Cement and Plaster based, bag products.

**Lines marked with \*\*\* are Special Order Items and once ordered cannot be cancelled or returned**



Joyce Griffith <griff800@gmail.com>

**AOL2350675 - Your Order Invoice**

1 message

26 December 2016 at 11:16



Order Date: 26 December 2016

**Delivery**

Beko WDR7543121W : 27 January 2017  
 Indesit LD70N1W : 27 January 2017  
 Hotpoint HFED110P : 27 January 2017  
 Zanussi ZCV680TCBA : 27 January 2017  
 Wpro C00375499 : 27 January 2017  
 Wpro C00379698 : 27 January 2017

**Cardholder Address**

Name Mrs Joyce Griffith  
 Address Byways Church Farm Lane  
 East Wittering  
 Chichester  
 West Sussex  
 PO20 8PT

**Delivery Address**

Name Mrs Joyce Griffith  
 Address Byways Church Farm Lane  
 East Wittering  
 Chichester  
 West Sussex  
 PO20 8PT



YOUR CREDIT/DEBIT CARD HAS BEEN CHARGED WITH THE TOTAL VALUE OF YOUR ORDER.

**Order Details**

Description	Item Price	Delivery Date	Total
Beko WDR7543121W Washer Dryer in White	£329.00	27 January 2017	£329.00
Indesit LD70N1W Fridge Freezer in White	£259.00	27 January 2017	£259.00
Hotpoint HFED110P Standard Dishwasher in White	£220.00	27 January 2017	£220.00
Zanussi ZCV680TCBA Electric Cooker in Black	£349.00	27 January 2017	£349.00
Wpro C00375499 Washing Machine Care Pack in White	£20.00	27 January 2017	£20.00
Wpro C00379698 Dishwasher Care Pack in White	£20.00	27 January 2017	£20.00
		Subtotal	£1197.00
		Delivery Total	£0.00



This is the document marked "DG6" referred to in the  
Affidavit of Doug Griffiths on his 15<sup>th</sup> day  
of March 2024

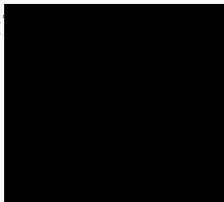

Before me



LISA CARR  
CARR SOLICITORS  
115 HIGH STREET  
SELSEY, CHICHESTER  
WEST SUSSEX, PO20 0QB  
01243 606 883

Solicitor / Commissioner for Oaths

