

STATUTORY DECLARATION

I, JOYCE GRIFFITH, DO SOLEMNLY AND SINCERELY DECLARE as follows:

1. That my full name is Joyce Barbara Griffith and I live at Byways, Church Farm Lane, East Wittering with my husband, Doug.
2. That I have read my husband's Statutory Declaration sworn on 15th March 2024 which concerns the use of our outbuilding in the location cross hatched on the plan attached at JG1.
3. That I can confirm the statements made within my husband's Declaration are accurate and true.
4. That the floor plan of the building as converted attached at DB6 of my husband's Declaration is an accurate representation of the room arrangement of our son's house since the end of March 2017 to the present day.
5. I can also confirm that since 1st April 2017 the converted outbuilding dwelling has been continually occupied by our son and now daughter-in-law. They have all the facilities they require to live wholly independently from my husband and I. They are not dependant on us for anything nor us on them.

AND make this Declaration SOLEMNLY AND SINCERELY
Believing the same to be true by
Virtue of the Statutory Declarations Act 1835.



DECLARED at

In the County of

This the 26th day of March 2024

Before me,

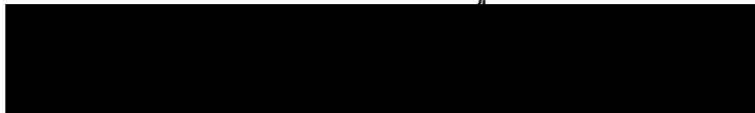

A Solicitor/Commissioner for Oaths.

LISA CARR
CARR SOLICITORS
115 HIGH STREET
SELSEY, CHICHESTER
WEST SUSSEX, PO20 0QB
01243 606 883

This is the document marked "JG1" referred to in the
Affidavit of Joyce Griffith sworn this 26th day
of *March* 2024



Before me

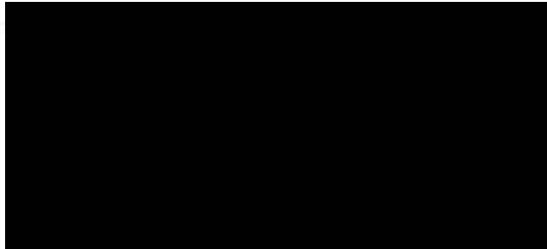

Solicitor / Commissioner for Oaths

LISA CARR
CARR SOLICITORS
115 HIGH STREET
SELSEY, CHICHESTER
WEST SUSSEX, PO20 0C
01243 606 883

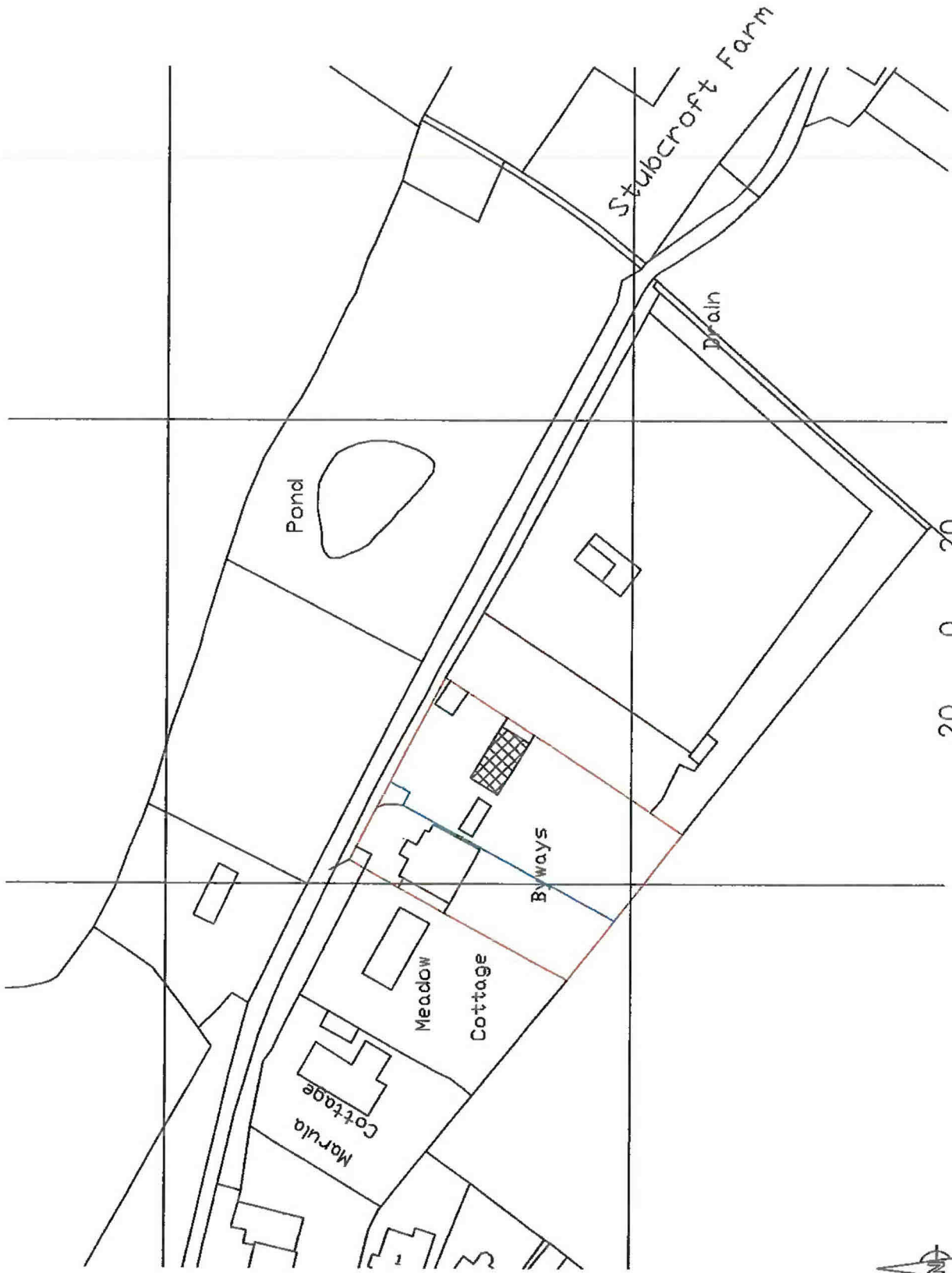

Stat Dec Plan

Scale 1:1250 @ A4



Crown Copyright and database rights 2024.
 OS AC0000814278 National Map Centre.
 Purchased 12/03/2024 1 year licence.

