

BEVERLEY ROAD

STEEP HILL

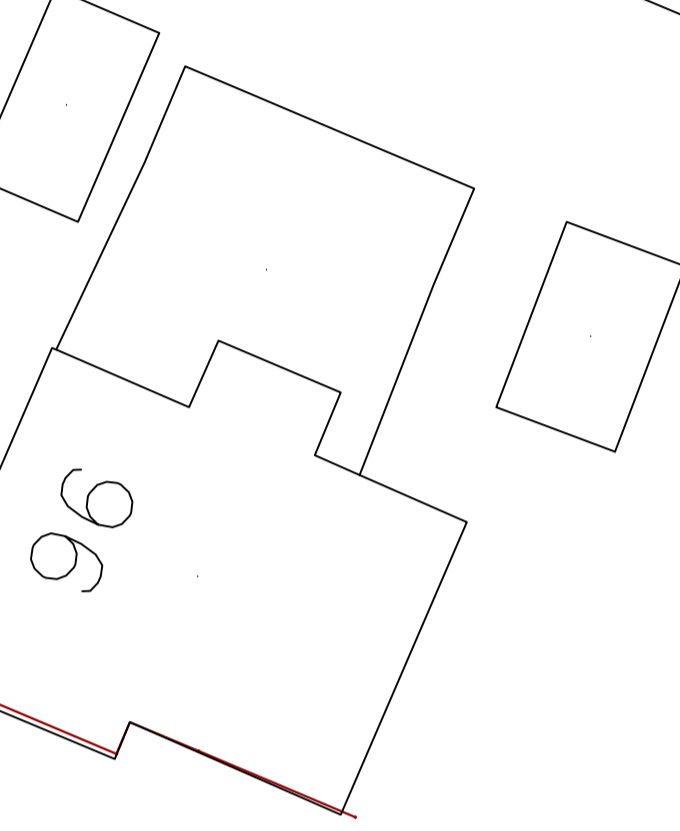

CONNECT TO MAINS

Grass Track Access

82

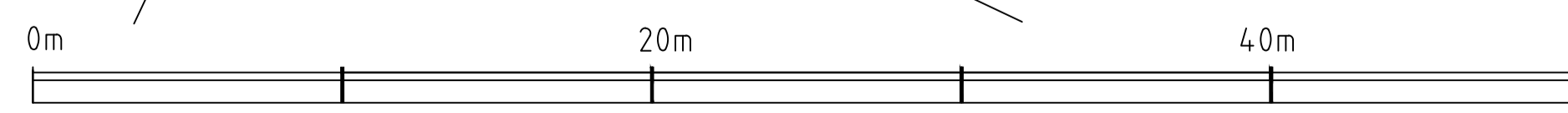

Scale Bar (1:200)

Landscaping Details

Shrub planting

- 300mm of topsoil to be spread over planted area and graded to fall as required.
- Topsoil to be weed free and clear of any other debris to give minimum 150mm depth.
- Shrubs from 2 litre pots to be planted in 300x300x200mm deep pits and treated with slow release fertiliser.
- Shrub beds to be topped with 75mm of clean medium grade bark mulch.

Shrub after care - 5 year establishment period

- Shrubs to be watered after initial planting for a sustained period until established.
- Beds to be maintained weed free by hand or chemical means in April and June.
- During first 5 years beds to have bark mulch maintained to a cover of 75mm.
- Any dead plants to be removed and replaced within the first five year period.

Hard Landscaping

Indicates gravel drive areas Existing hedge

Indicates tarmac or block paved private access drive Proposed hedge

Tree position and crown spread

Notes on Planting

**Container Grown Trees:** shall be planted in pits 300mmx300mmx200mm depth, and the backfill shall include 3 litres of peat-free tree and shrub compost.

**Mulch:** Planting pits to receive 75mm depth pulverised ornamental bark mulch. Natural woodland/edge plants to be planted within 800gm flax fibre mulch mat pinned to soil. Hedgerow to be planted through 800gm flax fibre mulch roll, edges tucked.

**Trees in grass:** 1m diameter around tree to be kept free of grass and mulched to a depth of 75mm with bark.

**Plant position:** Final position of trees and shrubs subject to confirmation of service

**Trees to be Secured** to a cross bar between two stakes so as not to damage the rootballs.

Tree and Shrub Maintenance (5 growing seasons)

**Dead, defective or seriously damaged trees** should be replaced with another tree of the same species, size and maturity.

**Water** plants immediately after planting and during periods of drought, including regular spraying of the crown with water in the growing period (when the sun is off their leaves in the evening).

**Perennial and annual weeds** to be removed using hand or chemical means in April and June.

**Mulch** to be maintained at 75mm depth.

**Formative pruning.** All trees in intensively used areas should be subject to formative pruning as detailed in BS 3998: 1989.

Hedge Maintenance (5 Growing Seasons)

**Failed plants** are to be replaced the following planting season.

**Weed growth** within the hedge to be treated annually with a suitable systemic herbicide prior to the hedge flushing.

**Mulching** is to be maintained to ensure weed growth is minimised. Any weeds can be spot treated.

Notes

- All dimensions must be checked on site and not scaled from this drawing, any discrepancies to be reported the office below.
- The Contractor shall make a survey of the site and shall be responsible for obtaining all dimensions and levels necessary for the proper construction of works as indicated.

Client

CHURCH GATE HOMES

Job Title

PROPOSED DEVELOPMENT  
96 BEVERLEY ROAD  
SOUTH CAVE

Drawing Title

SITE PLAN AND  
LANDSCAPE PLAN

©Copyright

ELEVATION

ELEVATION DESIGN LTD

DESIGN - CONSTRUCTION  
PROJECT MANAGEMENT

16 Wright Street Hull HU2 8JU

Telephone 01482 221155  
Fax 01482 221105  
Email forename@elevationdesign.org.uk

Revisions	Date	Description	DR	CH
-----------	------	-------------	----	----

Status	SCHEME
--------	--------

Scale	A1- 1:200	Date	05/03/2024
-------	-----------	------	------------

Drawn By	KS	Checked	Approved
----------	----	---------	----------

Drawing No.	2413.01	Rev	
-------------	---------	-----	--