

FLOOD RISK ASSESSMENT

32 ELMFIELD WAY, SANDERSTEAD, SOUTH CROYDON, CR2 0EE

Below are two maps showing the location of the property and the risk to flooding. The map shows there is no probability of flood risk from rivers and seas. There is low flood risk from surface water. As a result, it can be confirmed that the proposed finished floor levels will be constructed no lower than existing floor levels and that flood proofing of the new works will be incorporated where appropriate.

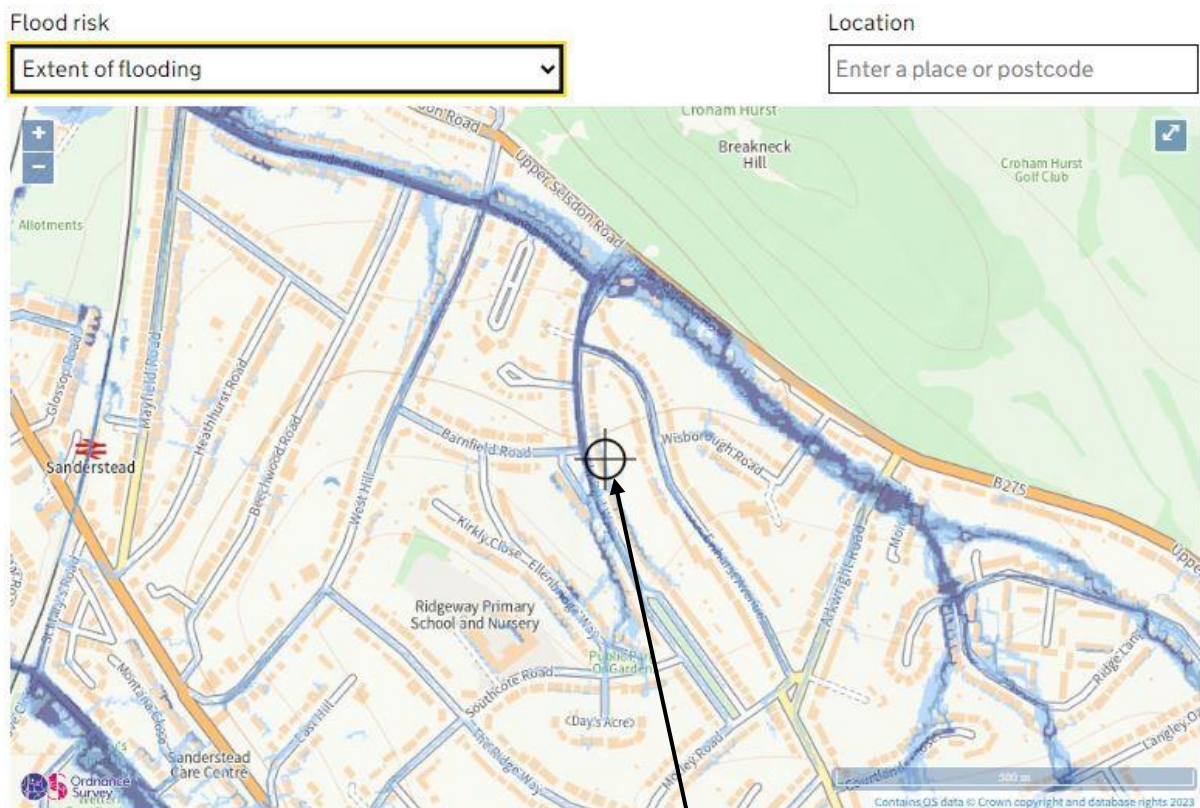

32 ELMFIELD WAY,
SANDERSTEAD, SOUTH
CROYDON, CR2 0EE

Flood risk

Extent of flooding

Location

Enter a place or postcode

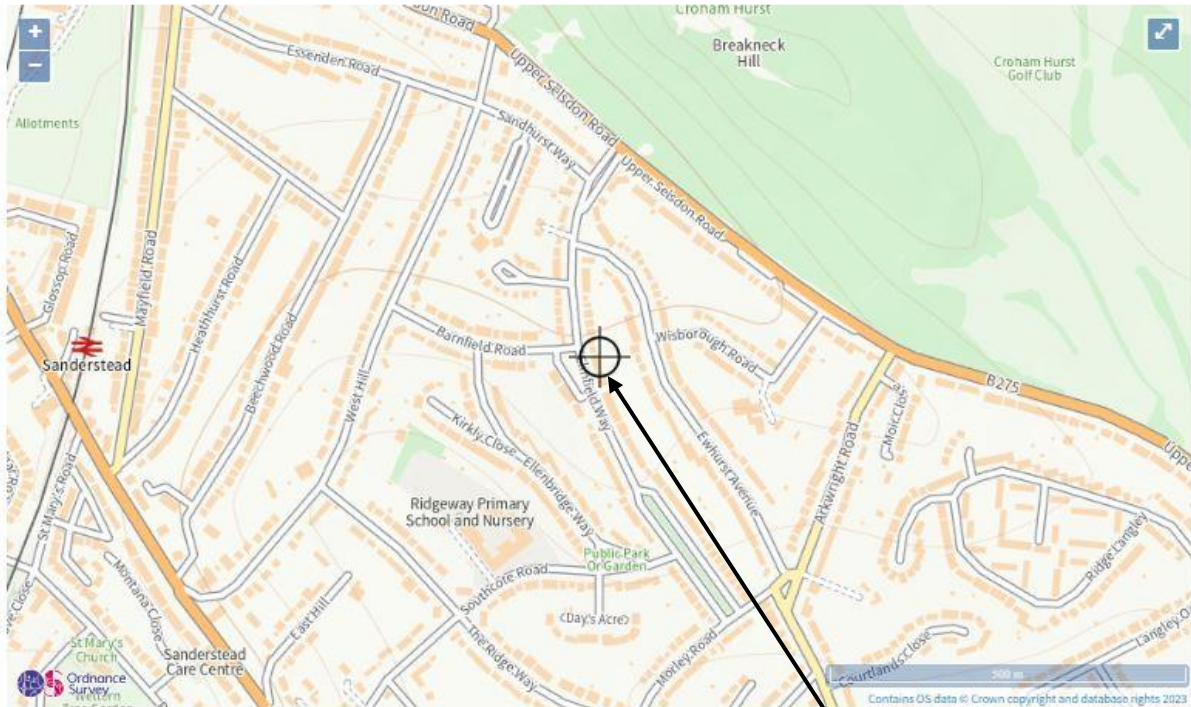

Extent of flooding from rivers or the sea

- High
- Medium
- Low
- Very low
- Location you selected

32 ELMFIELD WAY,
SANDERSTEAD, SOUTH
CROYDON, CR2 0EE

Soakaways are designed to cope with large amounts of surface and roof rainwater. The rainwater from roof gutters, patios and driveways should ideally be directed towards a soakaway within the boundary of the property. Please see figure 1 and 2 below.

Figure 1

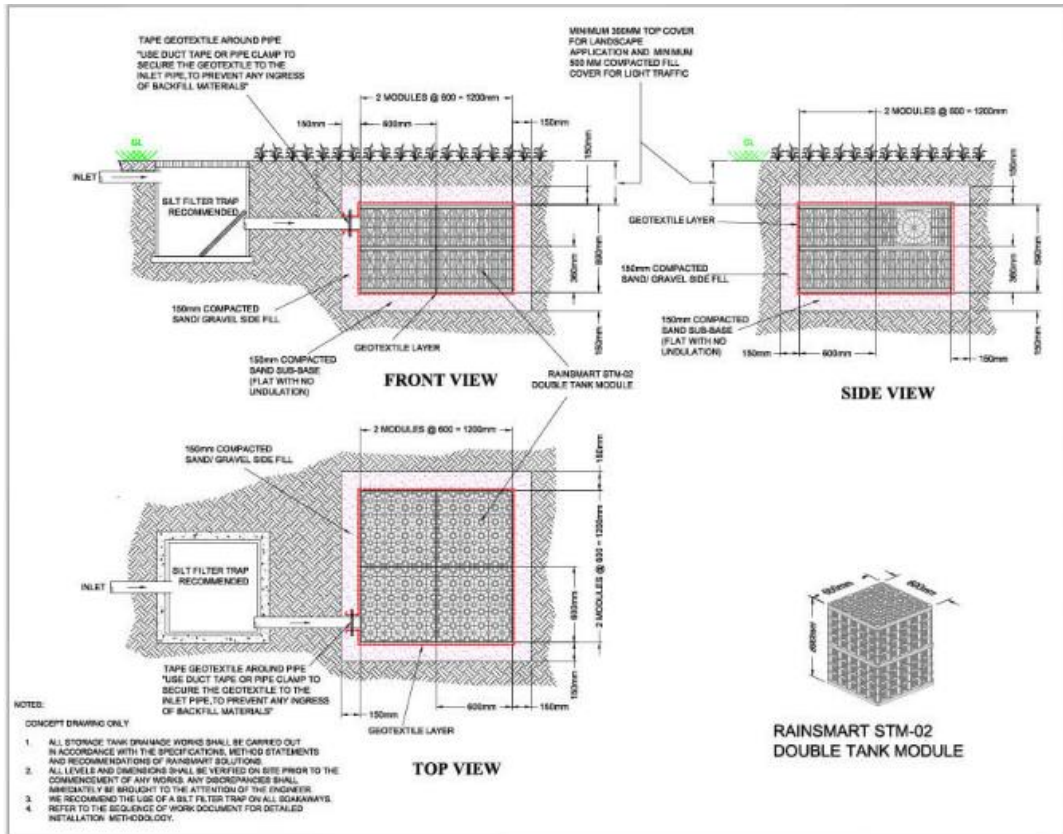
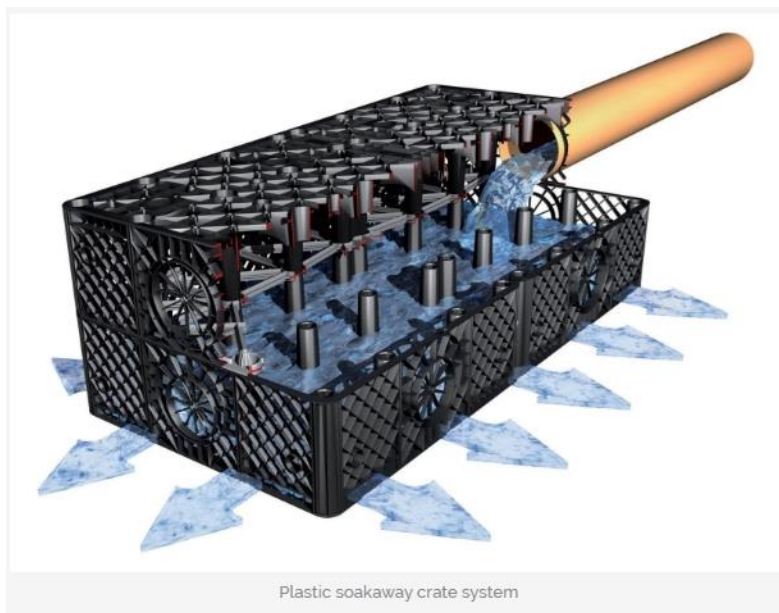

Figure 2



Please see site plan and block plan which has already been submitted, including the proposed plans and elevations.