

Section 03 — 1.50

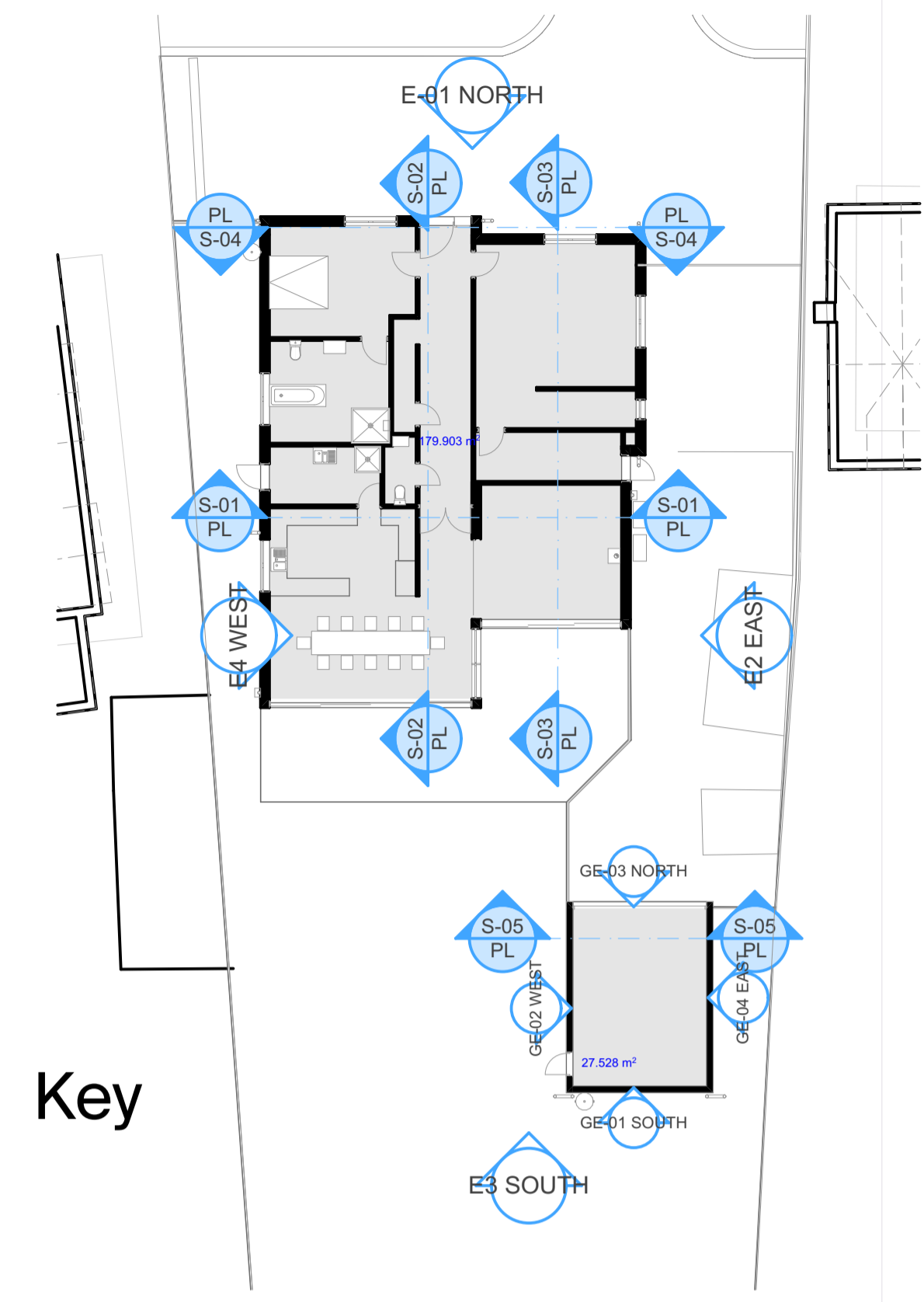

Section 04 — 1.50



At building services, underground and overground should be located and surveyed as required.
 Prior to works commencing on site drainage design should be investigated on site and a CCTV scan should be completed of existing drains. If drains are proposed over or near a neighbouring property or which are deemed to be shared then the relevant application should be completed to the local water board (managing body).
 At drawings to be read in-conjunction with supporting documentation (as defined within plans).
 Ground conditions for foundations to be reviewed and confirmed on site by contractor and agreed with structural engineer prior to works proceeding.
 Contractor to complete Construction Phase Plan and relevant FTA admission to HSE. Contractor to complete and maintain an up to date health and safety file during the construction phase of works.
 All relevant party wall agreements to be put in place by client and checked by contractor prior to works proceeding on site.
 Contractor to ensure that all relevant government guidelines regarding health and safety are fully adhered to during any construction works or meetings.
 All dimensions are to be checked on site and Studio Drake LTD to be notified of any discrepancies. Written dimensions are to be followed unless otherwise stated. Dimensions are taken from drawings. This drawing is copyright and cannot be reproduced without prior written consent from Studio Drake LTD.

Drawing status

Revision	Ref	Description	Date
C		Scale bar added	10.04.2024
B		OT defined minor alteration	21.02.2023
A		Proposed minor alteration	11.02.2023
		Description	Date

Client:	Irwin Mitchell LLP
Project:	Proposed replacement dwelling at LANSDOWNNE, BANNISTER GREEN, FELSTED, CM8 3NQ
Drawing title:	Planning Drawing Scale as mentioned on plans (print @ A1)
Project ref:	2021.90.55
Drawing ref:	PL 004
Date:	06.03.2022

Architecture — from a different angle.

Studio Drake
 Studio (in)
 11 Netherconestford
 King Street
 Netherton
 NR11PW
 © 2024 Studio Drake

Proposal to be read in-conjunction with Arboricultural Impact Assessment completed by Talking Elm Tree Consultants.

