



- FACING BRICKWORK WITH DETAILING
- MEDIUM DENSITY BLOCKWORK
- DENSE CONCRETE BLOCK MINIMUM 1990kg/Mcu
- LIGHTWEIGHT BLOCKWORK - THERMALITE SHIELD OR HIGH STRENGTH 7
- TYPE A WALL - SEPARATING WALL - METAL STUD FRAME - PART E
- TYPE B WALL - SEPARATING WALL - MASONRY WALL UPGRADE - PART E
- TYPE C WALL - STANDARD TIMBER FRAME STUD WALL
- TYPE D WALL - INTERNAL STUD WALL SUBJECT TO PART E
- TYPE E WALL - SEPARATING STUD WALL - NEW BUILD
- UPGRADED WALL FOR THERMAL RESISTANCE
- UPGRADED WALL FOR SOUND RESISTANCE

- MAINS WIRED FIRE DETECTION AND SIREN POINT - INTERLINKED WITH BATTERY BACKUP
- FIRE DOOR FD30 RATED WITH INTUMESCENT STRIPS AND 3No 100mm STEEL HINGES
- FIRE DOOR FD30S RATED WITH INTUMESCENT STRIPS, SMOKE SEALS, SELF CLOSING DEVICE AND 3No 100mm STEEL HINGES
- MEANS OF ESCAPE WINDOW MINIMUM 0.33m² CLEAR OPENABLE AREA MINIMUM 450mm IN ANY DIRECTION BOTTOM OF OPENABLE AREA TO BE WITHIN 800-1100mm FROM FINISHED FLOOR LEVEL. ENSURE HINGES DO NOT IMPEDE EGRESS

REF.	BEAM
G1	SEE ENGINEERS DESIGN
G2	SEE ENGINEERS DESIGN
G3	SEE ENGINEERS DESIGN
G4	SEE ENGINEERS DESIGN - GOALPOST FRAME
G5	RIDGE BEAM - SEE ENGINEERS DESIGN
ALL CATNIC LINTELS TO BE VERIFIED BY CATNIC PRIOR TO ORDERING / INSTALLING	
DRAWING / SCHEDULE TO BE CROSS REFERENCED WITH STRUCTURAL ENGINEERS DESIGN	

ALLOWABLE GLAZING BY AREA CALCULATION = 11.24m²  
ACTUAL PROPOSED GLAZING = 14.36m²

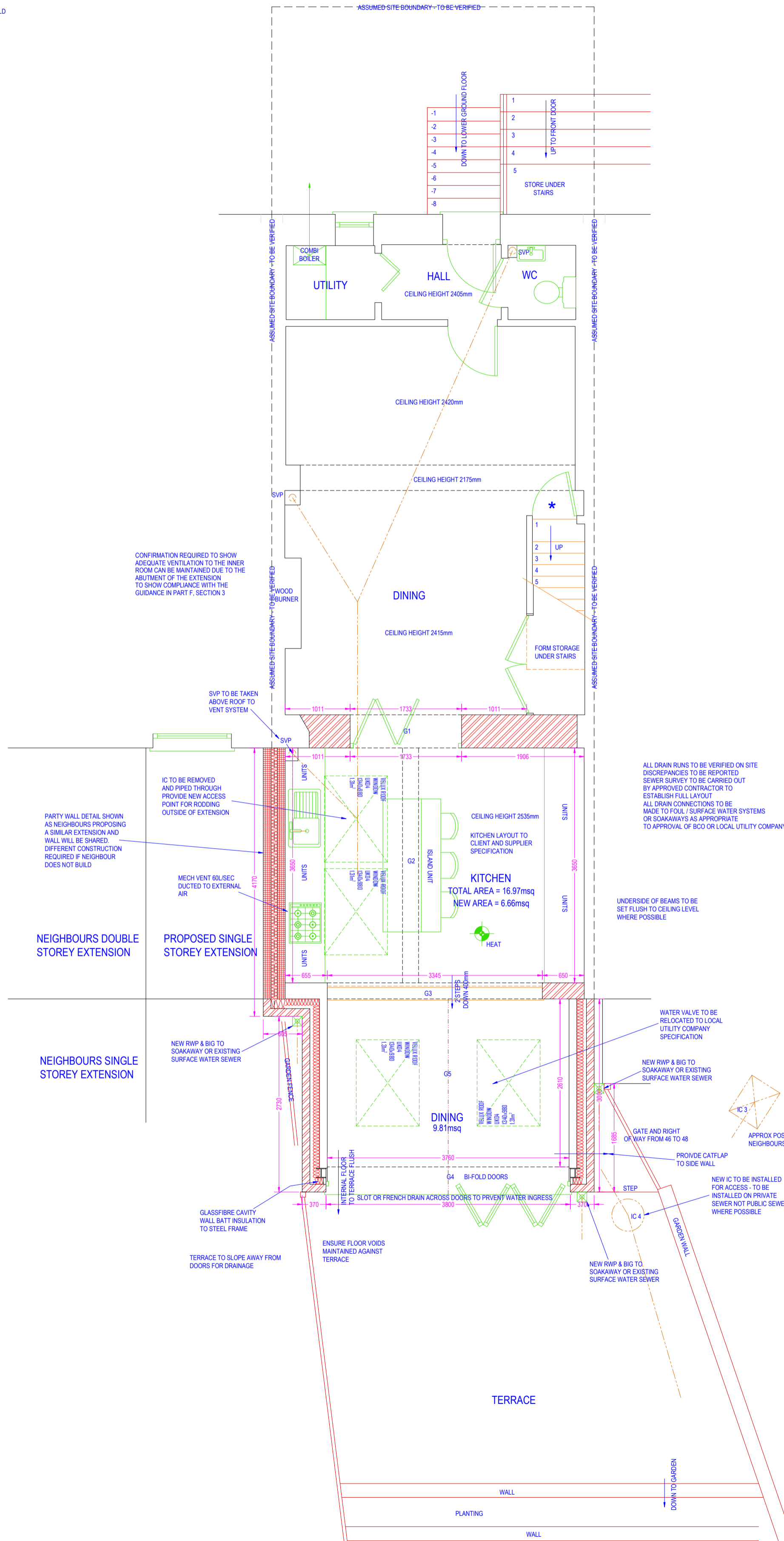

SPECIALIST REPORTS TO BE OBTAINED TO IDENTIFY THE EXISTING FLOORS, WALLS AND ROOFS FOR THE SUITABILITY TO RESIST THE INGRESS OF MOISTURE REMEDIAL WORK TO BE CARRIED OUT IN RESPECT OF ANY PROBLEMS IDENTIFIED TO THE APPROVAL OF THE BCO

ALL STRUCTURAL BEAMS, CONNECTIONS, PADSTONES, BEARINGS, PIERS, FOUNDATIONS, ETC TO ENGINEERS DESIGN AND TO BE TO APPROVAL OF BCO PRIOR TO ORDERING OR INSTALLING

ANY NEW OR REPLACEMENT HEATING, LIGHTING LAYOUTS AND SWITCHING DESIGN TO FOLLOW GUIDANCE AS GIVEN IN PART L1 FOR THE PURPOSES OF CONTROLS, LAYOUTS, EFFICACY AND INSULATION AS APPLICABLE FOR EACH SERVICE. YOUR ATTENTION IS DRAWN TO THE PROVISIONS OF THE 'DOMESTIC SERVICES COMPLIANCE GUIDE'

CONTRACTOR TO CONFIRM POSITION OF LOADBEARING WALLS ON SITE AND ANY DISCREPANCIES TO BE REPORTED

MAINTAIN CLEARANCE EITHER SIDE OF SEWER AS IT PASSES THROUGH FOUNDATION AND SEWER TO BE BRIDGED WITH PCC LINTELS

PUBLIC SEWERS: YOUR LOCAL UTILITY COMPANY HAS AUTHORITY TO REJECT BUILD OVERNEAR APPLICATIONS FOR PROPOSALS AFFECTING THEIR PLANT / SERVICES. ENSURE FULL APPROVAL IS GRANTED PRIOR TO COMMENCEMENT OF SITE WORKS. ALL DRAIN RUNS ARE TO BE VERIFIED ON SITE BY AN APPROVED SEWER SURVEY TEAM

NEW INSPECTION CHAMBER TO BE INSTALLED ON A PUBLIC SEWER TO BE IN ACCORDANCE WITH THE GUIDANCE GIVEN IN 'SEWERS FOR ADOPTION 8th EDITION' AND TO THE APPROVAL OF THE LOCAL UTILITY COMPANY AND BCO

SEWER LOCATIONS TO BE ASSESSED TO ENSURE NEW WALLS DO NOT INTERFERE WITH DRAINS THAT CANNOT BE MOVED AND DISCREPANCIES TO BE REPORTED

IF IN DOUBT - ASK  
COPYRIGHT CITYSCAPE ARCHITECTURE LTD  
ALL DIMENSIONS, LEVELS AND ANGLES TO BE CHECKED ON SITE BY CONTRACTOR  
ALL BOUNDARIES ARE ASSUMED AND WE ACCEPT NO LIABILITY FOR BOUNDARY INACCURACY  
YOU ARE REMINDED OF YOUR RESPONSIBILITIES UNDER THE 'PARTY WALL ETC. ACT' 1996 WHERE APPLICABLE  
RESPONSIBILITY IS NOT ACCEPTED FOR ERRORS MADE BY OTHERS IN SCALING FROM THIS DRAWING  
ALL DRAIN RUNS EXISTING AND PROPOSED ARE TO BE VERIFIED ON SITE DUE TO RESTRICTED ACCESS - ENSURE ALL CONNECTIONS MADE TO CORRECT SYSTEMS

**CITYSCAPE**  
ARCHITECTURE

T: 0117 900 0124  
W: www.abcpplans.co.uk  
E: mail@abcpplans.co.uk

CLIENT: BUCKINGHAM  
SITE: 46 HAMBROOK LANE, BRISTOL. BS34 8QD

SCHEME: SINGLE STOREY REAR EXTENSION  
TO BE READ IN CONJUNCTION WITH: Z-821-S001  
DRAWING NUMBER: Z-821-D007

REVISION: X  
DATE: 26TH MARCH 2024