

Block/Roof Plan 1:200

THE
SITE

PROPOSED
CAR
PORT
PROPOSED
EXTENSION

concrete
handstanding
to area of
carport

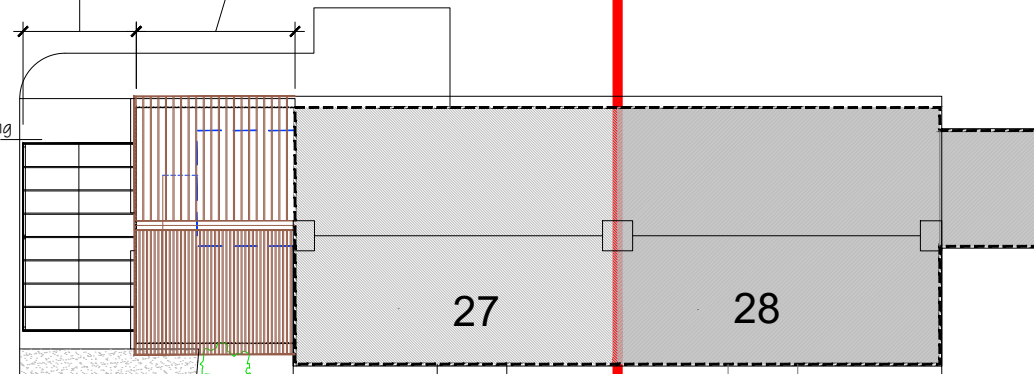

27

28

Shelter

Ext'g water
stop cock
chamber

Ext'g
manhole

concrete

Ext'g
manhole

Ext'g road gully

Proposed new
vehicular drop
kerb and
access

2000

2400

3000

3660

25000

8000

HARPERS ESTATE

Garages



Location Plan 1:1250

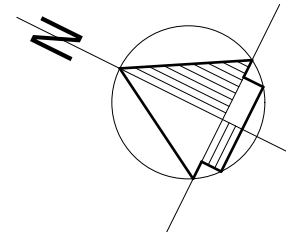
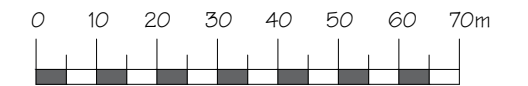

A. Red line boundary line area amended

16th April 2024

WISTON DESIGN

ARCHITECTURAL AND BUILDING DESIGN CONSULTANTS
11 Copper Beeches Telephone: (01206) 562973
Stanway, Colchester Fax: (01206) 562973
Essex, CO3 0YB Email: peter.hinchliffe@btinternet.com

scale 1:1250 drawn PH date March 2024
1:200 @ A3

Project Number 23/011/606 Drawing Number 001

Revision A

Project title
**PROPOSED EXTENSION and ALTERATIONS
27 HARPER'S ESTATE
NAYLAND
SUFFOLK**
For: Mr D. Mayhew

Drawing title
Location Plan & Block/Roof Plan