

- Notes**
- Datum : Ordnance Survey level Datum via OS Active GPS Network derived at station S004.
 - Survey Grid : Flat earth grid derived via Ordnance Survey Active GPS Network at station S004.
 - Survey contents correct as of date of survey and survey undertaken to agreed specification
 - All critical dimensions to be checked prior to site works
 - All floor coverings are carpet unless stated otherwise

Legend of Abbreviations

- | | |
|------------|--|
| B | Beam underside height |
| BL | Beam underside level |
| BLT | Beam top level |
| C | Cill height from the floor |
| CE | Ceiling level |
| CI | Cill level |
| CL | Cover level |
| CS | Ceiling slope height from the floor |
| CSL | Ceiling slope level |
| F/C | False ceiling |
| F/P | Finished floor level |
| G | Gully |
| H | Head height from the floor |
| HL | Head level |
| IC | Inspection cover |
| I | Invert level |
| MH | Manhole |
| PL | Purlin underside height |
| PL | Purlin underside level |
| RA | Ridge underside height |
| RA | Rafter level |
| RL | Ridge underside level |
| RWP | Rainwater pipe |
| SLB | Sloping beam |
| SBL | Sloping beam level |
| SO | Soffit level |
| SOF | Soffit level |
| SYP | Soil vent pipe |
| U/S | Underside height |
| W/A | Window above |
| W/HT | Wall Height Level |
| (250) | Floor to ceiling height |
| (250) | Floor level |
| +10/00 | Boxing |
| [Hatching] | Hatching indicates extent of structure |
| [Hatching] | Overhead ceiling feature, eg. beam, ceiling slope, opening |
| [Hatching] | Overhead roof feature, eg. purlin, rafter, ridge |
| [Hatching] | Direction of floorboards or joists |
| [Hatching] | Up for stairs |
| [Hatching] | Down for ceiling slopes |
| [Hatching] | Katador |
| [Hatching] | Light Fitting - Fluorescent Tube |
| [Hatching] | Light Fitting - Ceiling |
| [Hatching] | Light Fitting - Wall |
| [Hatching] | Light Fitting - Track |
| [Hatching] | Light Switch (# = Number of Switches) |
| [Hatching] | Pull Cord |
| [Hatching] | Electric Socket (# = Number of Sockets) |
| [Hatching] | Electric Socket - Blank |
| [Hatching] | Electric Switch (# = Number of Switches) |
| [Hatching] | BT Socket |
| [Hatching] | TV Aerial |
| [Hatching] | Smoke Detector |
| [Hatching] | Fire Alarm Sounder |

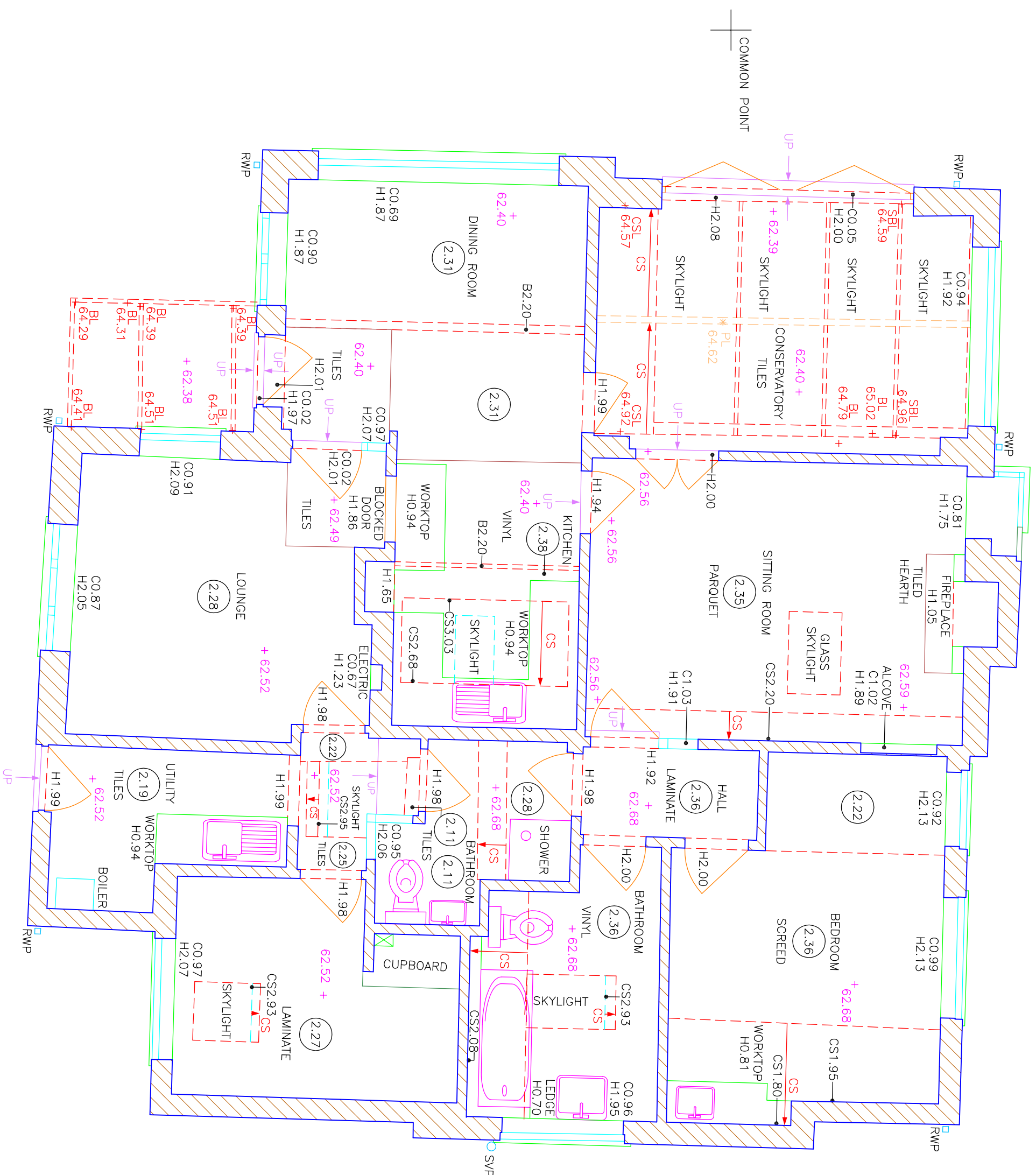

AD HORNOR LTD
 LAND AND MEASURED BUILDING SURVEYORS
 51 Bridge Street
 Pershore
 Worcestershire
 WR10 1AL

Telephone: 01386-555486
 Website: www.adhorne.co.uk
 E-mail: enquiries@adhorne.co.uk

Title	Arthebe Revivied, Sheepwash Lane, Wolverley, Kidderminster, Worcestershire DY11 5SE Floor Plan
Client	Adam Harvey
Date	January 2024
Plot scale	1 : 50 on A2 Sheet
Digital scale	1 CAD unit : 1 metre
Surveyed	BPF
Checked	JKW
Revision	Drawing No. 7279-231AN24-02

