

This drawing is copyright. It is sent to you in confidence and must not be reproduced or disclosed to third parties without our prior permission. Do not scale from this drawing. This drawing is to be read in conjunction with all relevant consultants, specialist manufacturers drawings and specifications. Any discrepancies in dimensions or details on or between these drawings should be drawn to our attention. All dimensions are in millimeters unless noted otherwise. Any surveyed information incorporated within this drawing cannot be guaranteed as accurate unless confirmed by fixed dimension.

REV	DESCRIPTION	BY	CHKD	DATE
P01	STAGE 3 APPROVAL	PAC	DH	06/02/2024
P02	STAGE 4 APPROVAL	PAC	DH	15/03/2024
P03	TENDER ISSUE	PAC	DH	05/04/2024

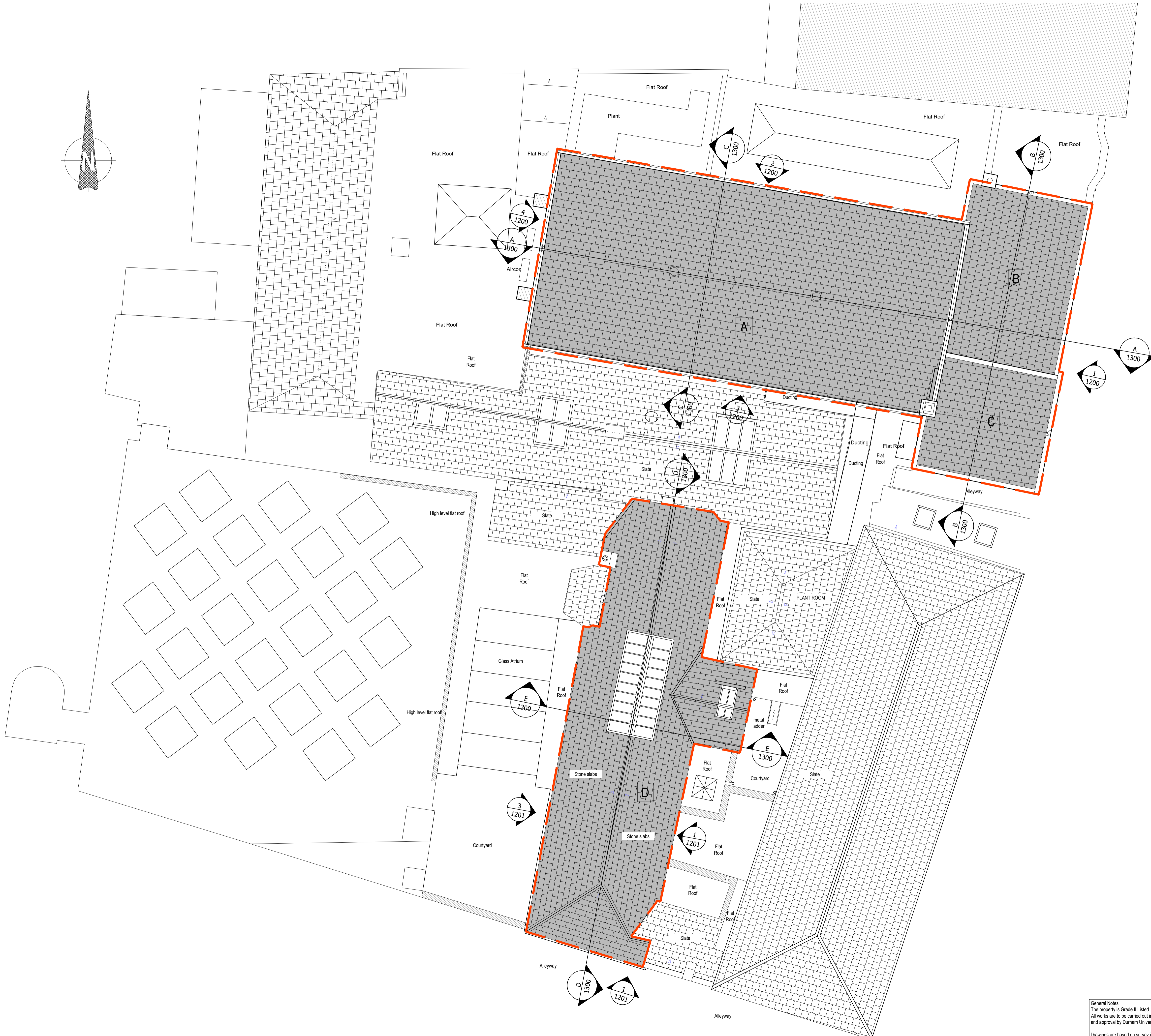
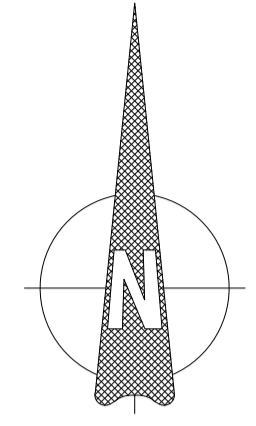

**SCOPE OF WORKS**

To be read in conjunction with Roof Condition Survey Report

To be read in conjunction with Elevations and Sections

- A. Roof over Wolfson Gallery
- B. Roof over Deane Room
- C. Roof over Stairwell
- D. Roof over Education & Learning Centre

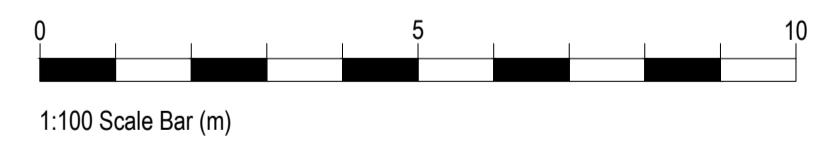

PURPOSE: TENDER	
PROJECT: Proposed Re-Roofing Works Palace Green Library For Durham University	
DESCRIPTION: Existing Roof Plan Palace Green Library Education and Learning Centre	
DRAWN BY: PAC	SCALE: 1:100
SHEET SIZE: A1	DATE: Jan 2024
PROJ NO: 23038	ORIG: HL
VOLUME: 00	LEVEL: 02
TYPE: DR	ROLE: A
NUMBER: 1101	SUITABILITY: D2
REV: P03	

**General Notes**  
 The property is Grade II Listed.  
 All works are to be carried out in accordance with Listed Building Consent and are subject to submission to and approval by Durham University Heritage Officer and Durham City Council Conservation Officer.  
 Drawings are based on survey information provided by amrGeomatics.  
 Any surveyed information incorporated within this drawing cannot be guaranteed as accurate unless confirmed by site measurement.  
 All dimensions given in the descriptions and drawings are approximate.  
 The Contractor, sub-contractors and suppliers must examine the existing site and drawings to ascertain the full extent of the works and take all necessary dimensions before preparing the tender submission.

**HOWARTH LITCHFIELD**  
 Liddon House, Belmont Business Park, Durham, DH1 1TW.  
 Tele: (0191) 3849470 E: hlp@hlpuk.com www.howarthlitchfield.com  
 © Copyright and all intellectual property rights remain vested in Howarth Litchfield Partnership Limited