

This drawing is copyright.
 It is sent to you in confidence and must not be reproduced or disclosed to third parties without our prior permission.
 Do not scale from this drawing.
 This drawing is to be read in conjunction with all relevant consultants, specialist manufacturers drawings and specifications.
 Any discrepancies in dimensions or details on or between these drawings should be drawn to our attention.
 All dimensions are in millimeters unless noted otherwise.
 Any surveyed information incorporated within this drawing cannot be guaranteed as accurate unless confirmed by fixed dimension.

REV	DESCRIPTION	BY	CHKD	DATE
P01	STAGE 4 APPROVAL	PAC	DH	15/03/2024
P02	TENDER ISSUE	PAC	DH	05/04/2024
P03	TENDER ISSUE	PAC	DH	12/04/2024

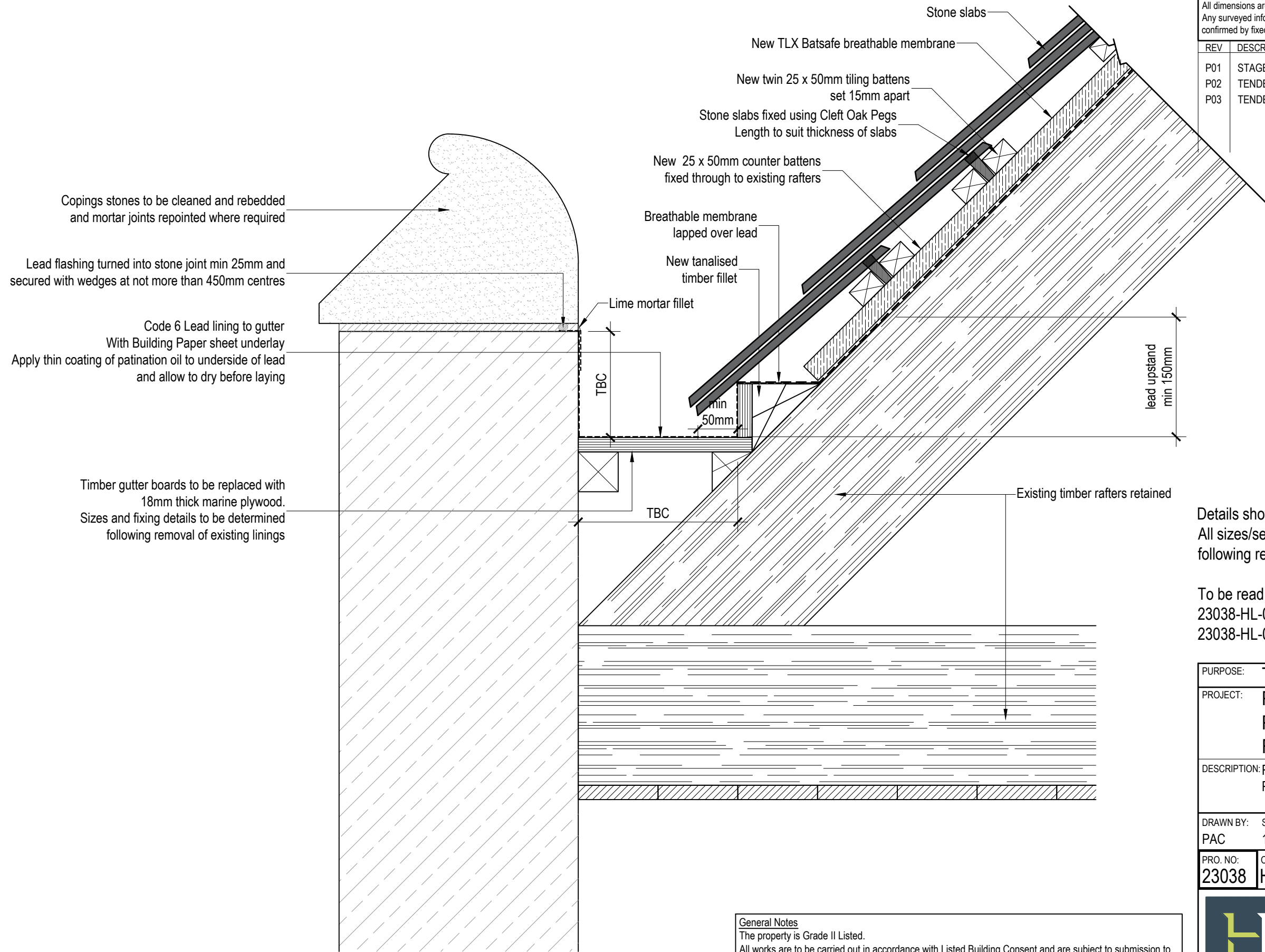

Details shown are indicative
 All sizes/setting out/dimensions etc to be checked on site following removal of existing roof coverings and lead linings

To be read in conjunction with drawings
 23038-HL-00-02-DR-A-2002 - Palace Green Library
 23038-HL-00-02-DR-A-2003 - Education and Learning Centre

PURPOSE:		TENDER						
PROJECT:		Proposed Re-Roofing Works Palace Green Library For Durham University						
DESCRIPTION:		Roof Details PGL Stairs Roof - Parapet Gutter Detail						
DRAWN BY:	SCALE:	SHEET SIZE:			DATE:			
PAC	1:5	A3			Feb 2024			
PRO. NO:	ORIG:	VOLUME:	LEVEL:	TYPE:	ROLE:	NUMBER:	SUITABILITY:	REV:
23038	HL	00	XX	DR	A	3004	D2	P03

General Notes
 The property is Grade II Listed.
 All works are to be carried out in accordance with Listed Building Consent and are subject to submission to and approval by Durham University Heritage Officer and Durham City Council Conservation Officer
 All dimensions given in the descriptions and drawings are approximate.
 The Contractor, sub-contractors and suppliers must examine the existing site and drawings to ascertain the full extent of the works and take all necessary dimensions before preparing the tender submission



**HOWARTH
LITCHFIELD**

Liddon House, Belmont Business Park, Durham. DH1 1TW.
 Tele: (0191) 3849470 E: hlp@hlpuk.com www.howarthlitchfield.com

© Copyright and all intellectual property rights remain vested in Howarth Litchfield Partnership Limited