

LEGEND

ALL OF THESE WORKS ARE TEMPORARY FOR THE DURATION OF THE SALES OFFICE & SHOW HOMES.

PROPOSED GRASSED AREAS.
TOTAL AREA = 540m²
(MAY BE TURF OR SEEDED DEPENDING UPON TIME OF YEAR. PRICE REQUIRED TO REFLECT THIS)

INDICATIVE PLANTING FOR TEMPORARY SHOW AREA
EXTENT OF PLANTING & SPECIFICATION TO BE AGREED WITH SALES DIRECTOR SUBJECT TO AGREED BUDGET.
TOTAL AREA = 130m²

FOOTPATH TO SALES OFFICE AND SHOW HOMES.
TOTAL AREA = 54m²
(PRICE REQUIRED FOR BOTH BLOCK PAVING & YORKSHIRE STONE PAVING)

SHOW AREA CAR PARKING - 6 SPACES.
TOTAL AREA = 216m²
(TARMAC WITH WHITE LINING)
NOTE: THE LAYOUT SHOWS THE EXISTING BELLWAY SALES CENTRE PARKING UTILISED FOR THE SALES COMPLEX

1.8M HIGH CLOSE BOARDED TIMBER FENCE -
ADDITIONAL REQUIRED = 11m.

0.8M HIGH HOOPED TOP METAL ESTATE RAILINGS.
ADDITIONAL LENGTH REQUIRED = 66m
(RAILINGS TO BE GALVANISED BEFORE DELIVERY AND PAINTED BLACK ON SITE)

SIGNAGE KEY

- █ A: SIC FASCIA
- █ C: 'WELCOME' MONOLITH
- █ E: 'AVAILABILITY' MONOLITH
- █ G: 'VISITOR PARKING' MONO
- █ I: 'OPENING TIMES' SMALL MONO
- █ J: 'HOUSETYPE' SMALL MONO
- ~ SALES FLAG POSITIONS

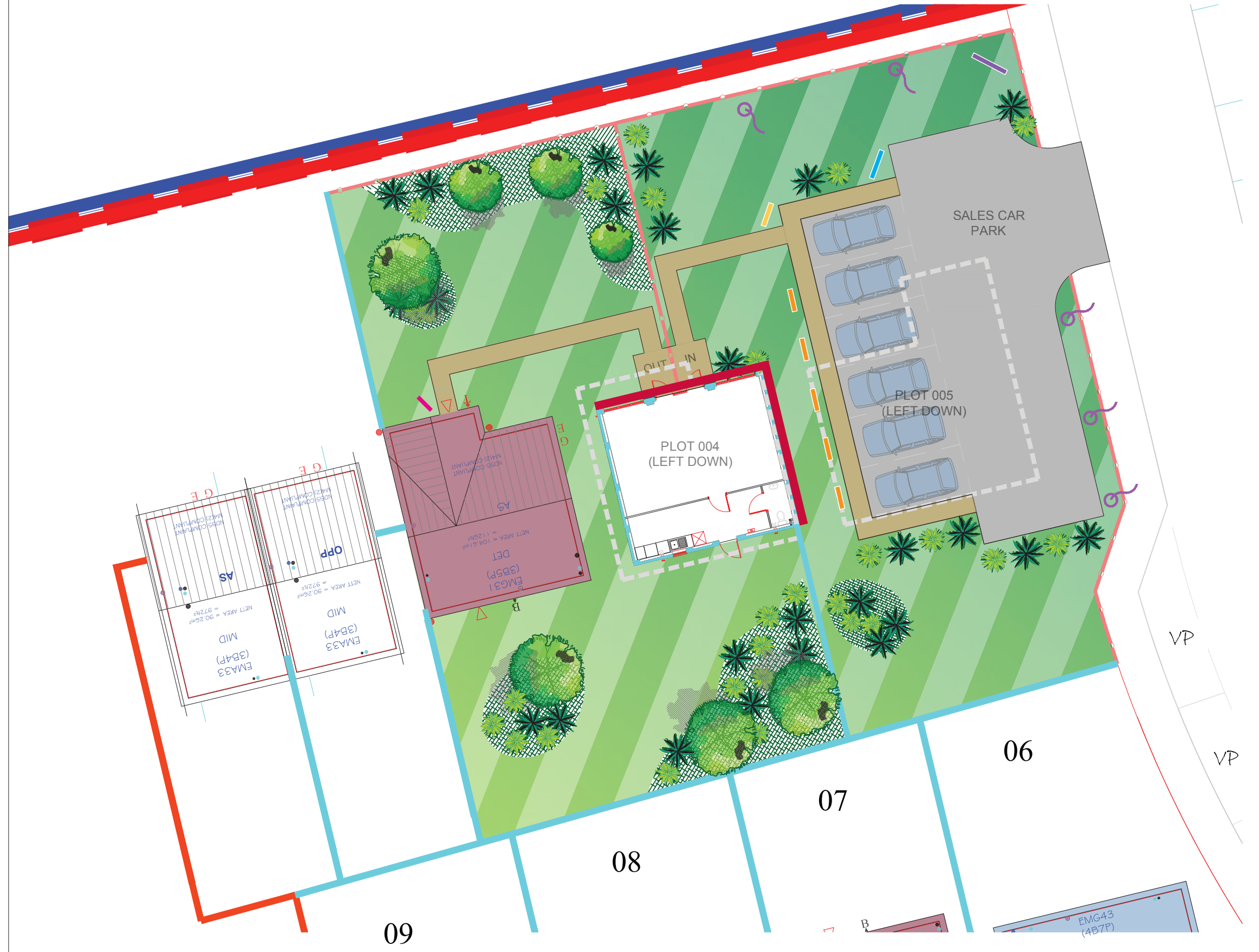

REVISIONS

A	Show area amended in line with layout revisions - show plot now shown as EMG31. Area sizes amended.	06.03.23	RP
B	Show area amended in line with layout revisions - Plots 1-2 position altered. Plot 5 handed.	17.04.23	GB

Taylor Wimpey North East
Rapier House, Colima Avenue,
Sunderland SR5 3XB
Telephone 0191 5165400
Fax 0191 5165401



TITLE	Sales Complex	DRAWN	GB	DATE	09/22
DEVELOPMENT	Pelton Fell Phase 2	CHECKED	RP	DATE	03/23
DRAWING NO.	1N PeIPh2/03-01	SCALE	nts @ A3		
REV	B				

