

Proposed Section A-A
scale 1:50

Floor construction comprising of 22mm tongued and grooved moisture chipboard flooring with glued joints laid on 47x195mm C16 grade treated timber joists at 600mm centres. 100x50mm treated wallplate laid on wall DPC. Insulation between joists to be 180mm Kingspan TF70 (or equal & approved) floor insulation.

DPM to be taken up wall and lapped with wall DPC. DPC not to bridge cavity (if applicable) and to be 150mm minimum above ground level.

Strip footings to be cast in grade RC 28/35 concrete and reinforced with 1No. layer of A393 mesh, bottom, 50mm minimum cover.

215x150mm sub floor vents to be provided where shown and/or any existing sub floor ventilators covered by works to be re-routed to external air.

WALL:
Brick Basecourse colour dark GREY; Blockwork Dry-Dashed Harled Dado Walls - colour WHITE.

Any discrepancies or queries regarding any part of the works to be discussed prior to any affected work being carried out.

Drawings not to be scaled and all sizes to be checked on site.

Lighting / Electrical Items all as per Specification and to final positions to be agreed on site by customer.

ROOF:
BROWN Profiled concrete roof tiles. Code 5 Lead throughout. Sarking board to have 3mm gap in between to allow for installation of breather roof membrane BBA Cert No. 96/3320 (or equal & approved). Fascia/Soffits - uPVC ROSEWOOD FASCIA / WHITE SOFFITS

DRAINAGE:
New 68mm PVCu RWP connected into existing drainage and 110mmØ half round RWG - colour: BLACK. Bracket and support to be fixed at 500mm horizontal centres, 1.8m vertical centres

WINDOWS & DOORS:
Window and Door units to be External ROSEWOOD / Internal WHITE, Optiwhite argon gas filled TRIPLE glazed with 'KS' inner pane coating with warm air edge spacer (0.95 W/m²K U-Value SINGLE OPENABLE WINDOWS; 1.0 W/m²K U-Value DOORS). Opening parts shown. Glass in doors and any adjacent windows to be toughened on inside pane; laminated on outer, designed to resist human impact as set in BS 6262 Part 4: 2019. Low / standard threshold door(s) to be fitted. 4000mm² trickle vents to be fitted to opening sashes as shown to achieve 12000mm² rate of ventilation. 25mm Kingspan insulation to be fitted at window jamb, head and cills to prevent thermal bridging

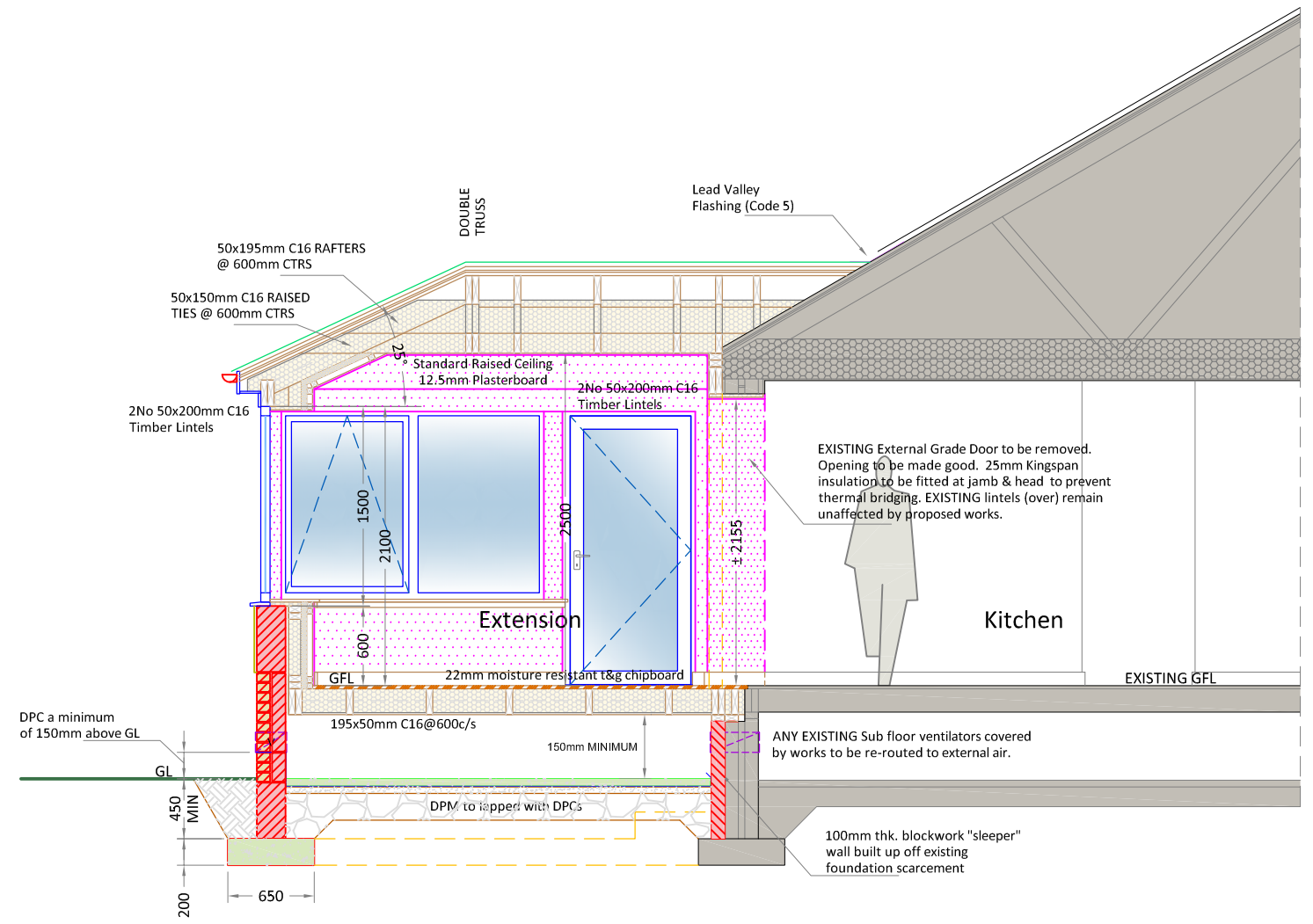
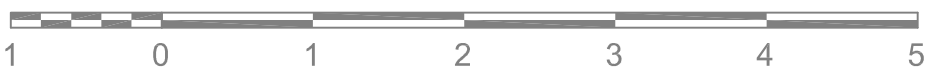

Proposed Section B-B
scale 1:50

GENERAL NOTES

ALL ELECTRICAL WORK TO BE CARRIED OUT IN STRICT ACCORDANCE WITH THE LATEST I.E.E REGULATIONS AND TO COMPLY WITH THE 18TH EDITION OF THE BS 7671: 2018 'THE REQUIREMENTS FOR ELECTRICAL INSTALLATIONS'.

ANY DISCREPANCIES OR QUERIES REGARDING ANY PART OF THE WORKS TO BE DISCUSSED PRIOR TO ANY AFFECTED WORK BEING CARRIED OUT.

WHILST THE HIGHLIGHTED AREAS ARE INDICATIONS OF SERVICES BELOW GROUND THERE MAY BE OTHERS OUT WITH. THEREFORE ALL EXCAVATIONS SHOULD INCORPORATE EXTREME CARE AND DILIGENCE.

DRAWINGS TO BE READ AND UNDERSTOOD PRIOR TO WORK COMMENCING. FIGURED DIMENSIONS TO TAKE PREFERENCE OVER SCALED DIMENSIONS. ALL DIMENSIONS AND LEVELS TO BE CHECKED ON SITE. EXISTING DRAINAGE AND SERVICES POSITIONS TO BE CONFIRMED ON SITE. ANY DISCREPANCIES TO BE REPORTED BACK TO ARCHITECT.

CUSTOMER APPROVAL		
SALES ADVISER		
SALES MANAGER		
APPROVAL	DATE	SIGNATURE

No.	REVISION	DRAWN BY	CHECKED BY	DATE
3	ISSUED FOR PLANNING & WARRANT APPROVAL	Z.URQUHART		18/04/2024
2	DRAWING AMENDMENTS AS PER CUSTOMER COMMENTS	Z.URQUHART		08/04/2024
1	ISSUED TO CUSTOMER FOR APPROVAL	Z.URQUHART		02/04/2024
0	ISSUED TO SALES FOR APPROVAL	Z.URQUHART		20/03/2024

CUSTOMER:
MR & MRS B. HENDERSON
57 NESS CIRCLE
ELLON
ABERDEENSHIRE
AB41 9BR

PROJECT:
PROPOSED EXTENSION

THISTLE CONTRACT NO: 41560



THISTLE HOUSE, WOODSIDE ROAD
BRIDGE OF DON, ABERDEEN, AB23 8EF
TEL: 01224 706555 WWW.THISTLE.GROUP

DATE	MARCH '24	DRAWING NO:	203
SCALE	1:50		