

**PRE-EXISTING GROUND  
FLOOR PLAN**

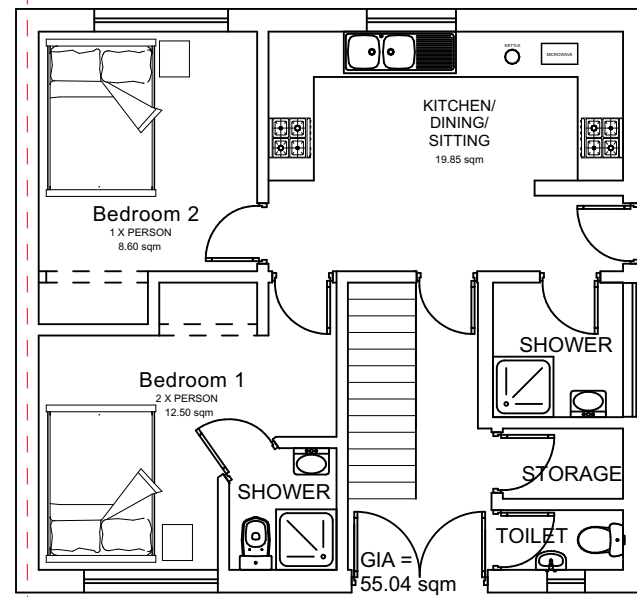

**EXISTING GROUND  
FLOOR PLAN**

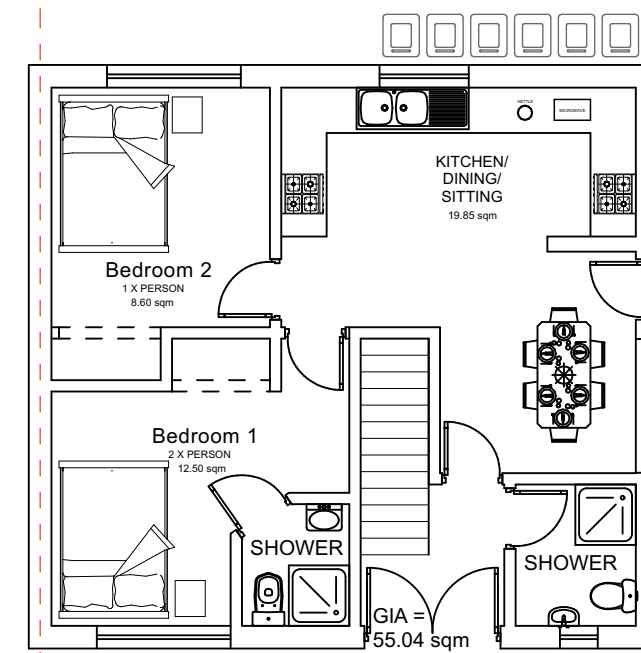

**PROPOSED GROUND  
FLOOR PLAN**

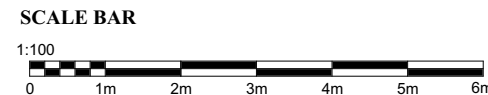

<b>MEK TOWN PLANNING AND DESIGN CONSULTANTS LTD</b> <a href="http://www.mektownplanningconsultants.co.uk">www.mektownplanningconsultants.co.uk</a> Email: <a href="mailto:contact@mektownplanningconsultants.co.uk">contact@mektownplanningconsultants.co.uk</a>  <b>14 CLIVE HOUSE, HADDO STREET, LONDON SE10 9RH.</b> <b>MOB. +447506208449</b>	<b>DRAWING TITLE</b>			<b>PROJECT TITLE</b>	<b>TECHNICAL TEAM</b>
	<b>PRE-EXISTING, EXISTING AND PROPOSED GROUND FLOOR PLAN</b>			<b>CHANGE OF USE FROM C3 (DWELLING HOUSE) TO A SUI GENERIS HMO OF UP TO 8 PEOPLE INCLUDING PROVISION OF BIN STORAGE AND CYCLE PARKING AREA.</b>	<b>CAD TECHNICIAN: TEZIKUBA ARTHUR</b>
	<b>SCALE</b>	<b>DATE</b>	<b>DRWG NO.</b>		<b>CIVIL / STRUCTURAL ENG: BASOOMYE FRANCISCO</b>
	<b>1:100</b>		<b>11YR/003</b>	<b>SITE ADDRESS</b>	<b>CHECKED BY: MOSES EKOLE PLANNING CONSULTANT</b>
<b>A-3</b>	<b>REVISION</b>		11 York Road, Corby, NN18 0NU		