

Notes

Do not scale from this drawing for purposes other than those associated with the planning application process.

All dimensions are to be checked prior to construction and any discrepancies are to be identified to the Architect.

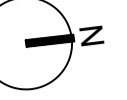

Copyright reserved.



All works are subject to statutory approval and as such the layout shown is subject to change following consultation with the necessary authorities.

The drawings have been prepared for our client, TS SA Property Holdings, are approximate only and have been based upon survey model & drawings provided by Malcolm Hughes Land Surveyors Limited March 2024.

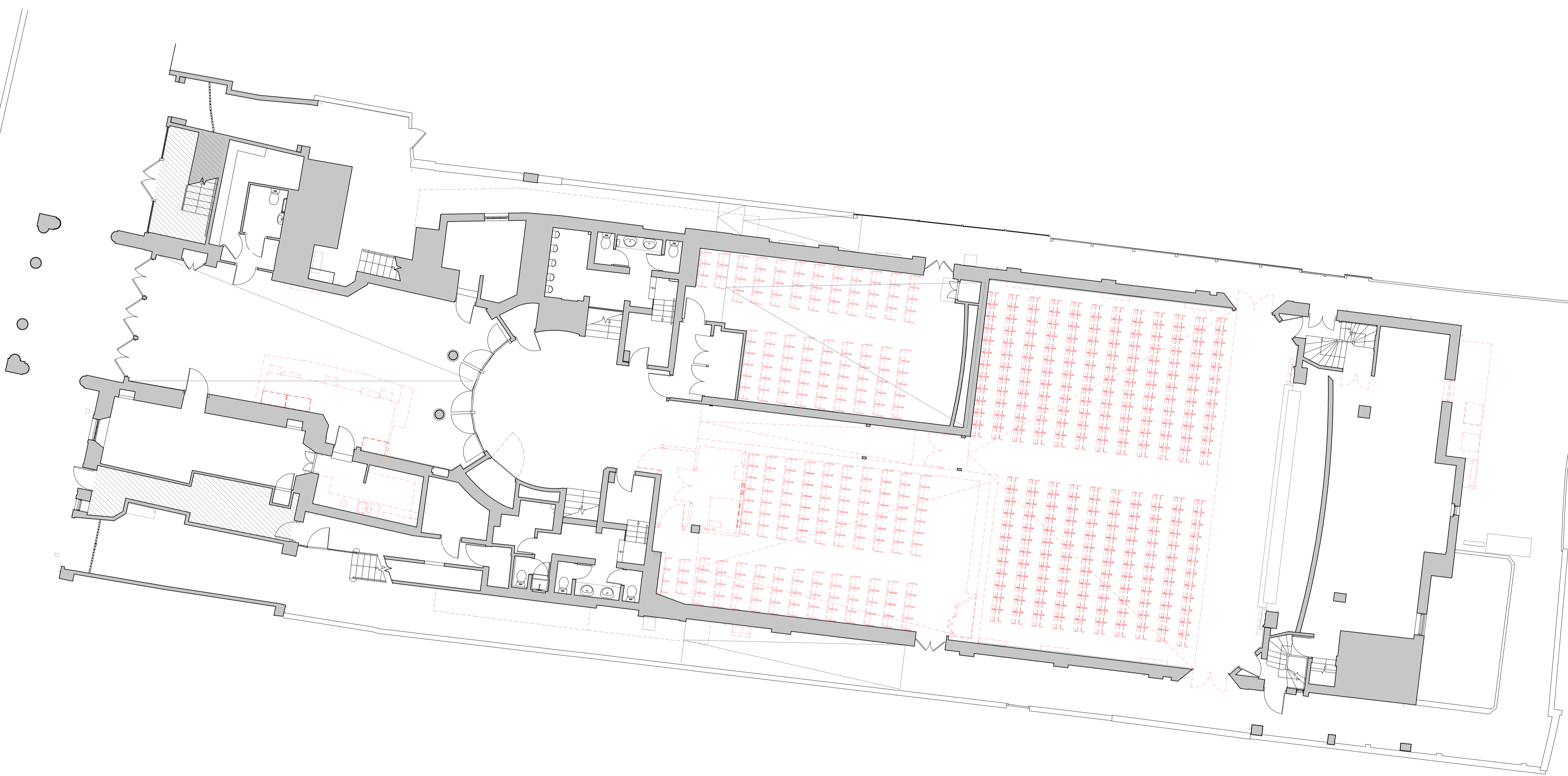
Following strip-out & down-takings, further surveys are to be undertaken upon retained elements to establish existing build-ups and site dimensions/ depth. Note that proposals may vary to suit existing site circumstances.



KEY

-  Existing
-  Extent of area not included within application.
-  Downtakings

P01 First Issue VK JS 27/03/2024

Revisions

Status

**PLANNING**

Client

TS SA Property Holdings

Project

The New Picture House  
117 North Street  
St Andrews

Title

Downtakings Ground Floor Plan

Scale	Size	Date	Drawn	Checked
1:100	A1	13/03/2024	VK	JS



Drawing No. 230166-3DR-ZZ-00-DR-A-08018 Rev. P01

