

GROUND FLOOR PLAN

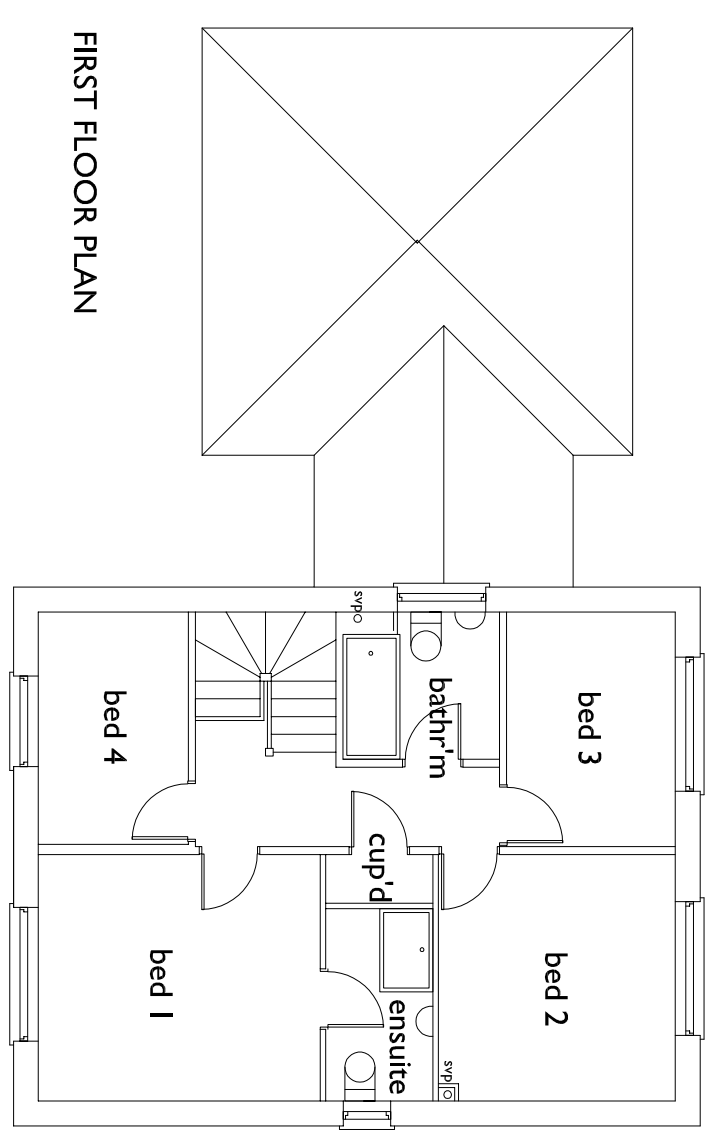

FIRST FLOOR PLAN

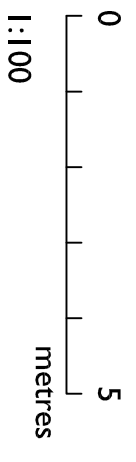

A Ref. 29.03.24 Date
Drainage added. Revision

Do not scale from this drawing. All measurements to be checked on site. Any discrepancies, contact the issuer.

 <p>Lara Turner Architectural Services</p>		<p>Rose Cottage High Street Rattlesden Bury St Edmunds Suffolk IP30 0RX</p>	<p>Lara Turner Architectural Services © tel: 01 440 737428 e-mail: enquiries@ltaarchitectural.co.uk</p>
---	--	---	---

<p>DETAIL: FLOOR PLANS EXISTING</p>		<p>PROJECT: EXTENSIONS - 5 CRESMEDOW WAY, ELMSWELL IP30 9GL</p>	
<p>Scale: 1:100@A3</p>	<p>Date: January 2024</p>	<p>JOB No. CWKPI123</p>	<p>DRG No. 01A</p>