

© This drawing and design are copyright.
 Do not scale from this drawing. Use only figured dimensions. If in doubt, ask.
 All dimensions are to be checked on site.
 Any discrepancies should be reported immediately to the Architect.

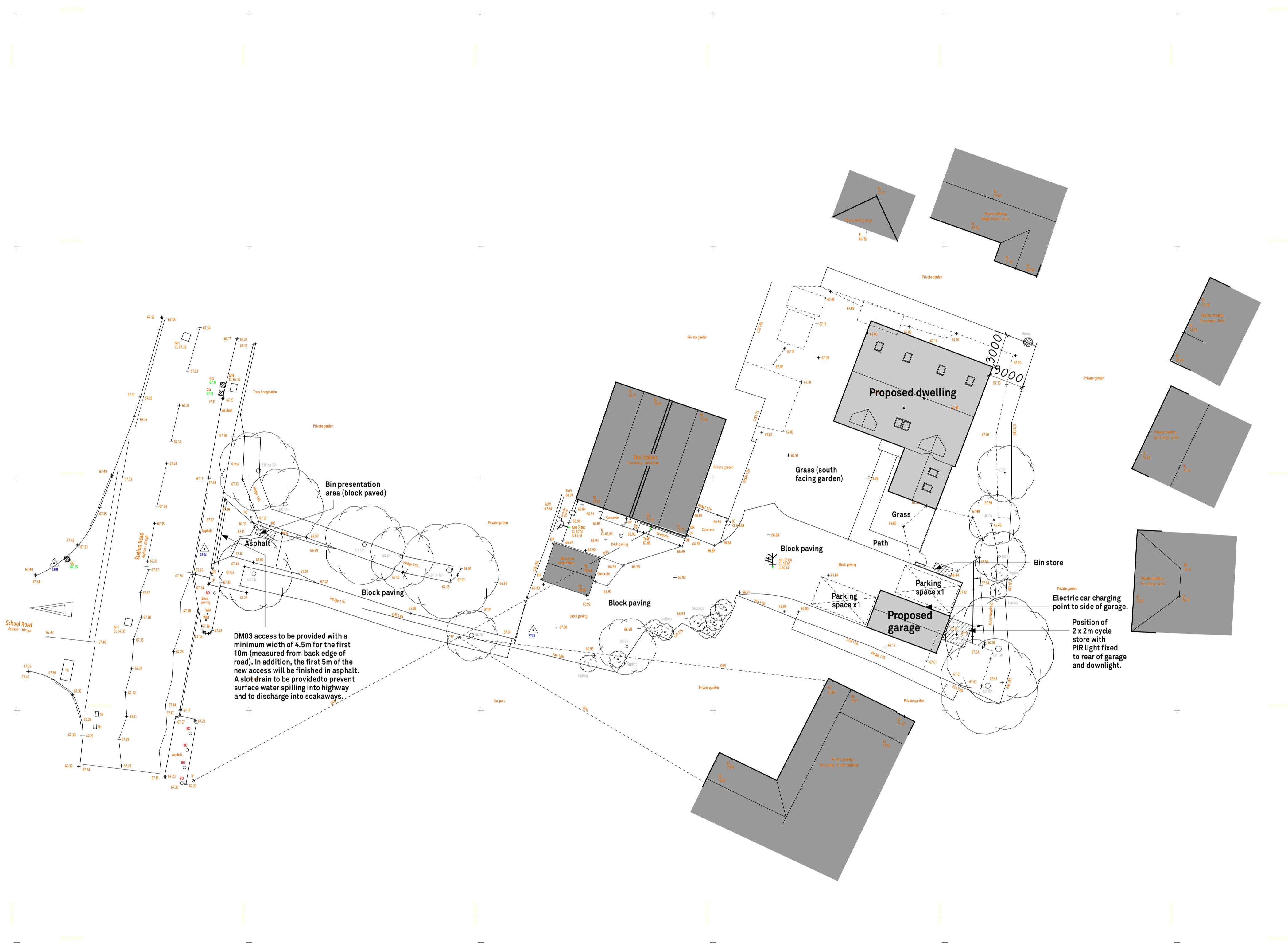

Proposed cycle shelter: Autopa 2x2m SG1 variant of the Stratford shelter.

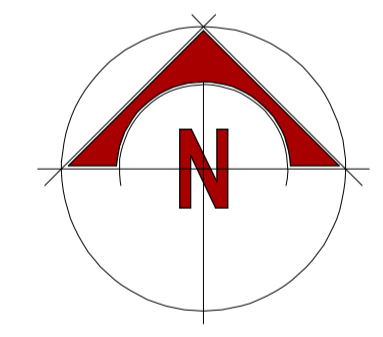

DATE	REV.	DESCRIPTION	DRAWN

PatrickAllen&Associates
Architects
 architects@patrickallen.org.uk
 www.patrickallen.org.uk
 +44 (0)1473 820660

Project
Proposed new dwelling at: Land adj. The Stables, Station Road, Elmswell, BSE IP30 9HA

Client
Mr & Mrs Sylvester

Drawing Title
Site Plan As Proposed

Drawing Status
Planning

Scale	Paper Size	Date	Drawn
1:200	A1	Feb 2024	AC

Drawing Number
4514-02C