

- Notes
1. ALL LEVELS AND DIMENSIONS ARE SHOWN IN METRES UNLESS NOTED OTHERWISE.
 2. DO NOT SCALE FROM THIS DRAWING. ONLY FIGURED DIMENSIONS AND LEVELS TO BE USED.
 3. THE DRAWING IS BASED ON TOPOGRAPHICAL SURVEY FROM SEVERN PARTNERSHIP MADE AVAILABLE ON 07/09/2023 (VERSION P09).
 4. TEMPORARY LIGHTING TO BE DESIGNED AT GRIP 6.
 5. WATER AND POWER SUPPLIES APPLIED FOR, SEPTIC TANK TO TOILETS.
 6. ALL EXTERNAL LIGHTING TO FACE DOWNWARDS DIRECTIONS TO PREVENT SPILLAGE. CIVIL ENGINEERING WORKING AREAS TO ACHIEVE A TEMPORARY LIGHTING LUX LEVELS ON AVERAGE 50lux. PEDESTRIAN WALKING ROUTES 35lux LEVELS. TEMPORARY WORKS TO BE DESIGNED AT GRIP 6.
 7. A LIGHTING PLAN WILL BE INCLUDED IN THE DETAILED CEMP FOR AGREEMENT WITH NETWORK RAIL AND THE RELEVANT PLANNING AUTHORITY. THE LIGHTING SCHEME WILL COMPLY WITH THE INSTITUTE OF LIGHTING PROFESSIONALS GUIDANCE NOTES FOR THE REDUCTION OF OBTRUSIVE LIGHT GN01 (2011) AND THE PROVISIONS OF BS 5489. CODE OF PRACTICE FOR THE DESIGN OF ROAD LIGHTING (BSI, 2013A), TO BE PROVIDED AT GRIP 6.
 8. COMPOUND TO HAVE DESTRUCTIVE SEARCH CARRIED OUT BY ECOLOGIST PRIOR TO SETUP.
 9. TEMPORARY WORKS TO BE DESIGNED AT GRIP 6.

| LEGEND | |
|--------|----------------------------------|
| | STEELGUARD FENCE |
| | TIMBER HOARDING |
| | SILT FENCING |
| | HERAS BOUNDARY FENCE |
| | AMPHIBIAN FENCE |
| | MAGNETIC SAFETY BARRIER (VORTOK) |
| | ACCESS/EGRESS GATE |
| | PEDESTRIAN ROUTE |
| | HAUL ROAD |
| | SITE ROAD |
| | RRAP |
| | STOCK PILE |
| | LAYDOWN AREA |
| | MOBILE PLANT AREA |
| | PLANT PASSING POINT |
| | REFUELLING AREA |
| | WASTE SEGREGATION/STORAGE AREA |
| | EV CHARGING BAY |
| | TREE / HEDGE PROTECTION AREA |
| | BADGER SETT BUFFER ZONE |
| | HARDSTANDING |
| | HOARDING LIGHTING |
| | INDICATIVE PV LIGHTING |
| | COMPOUND AREA BOUNDARY |

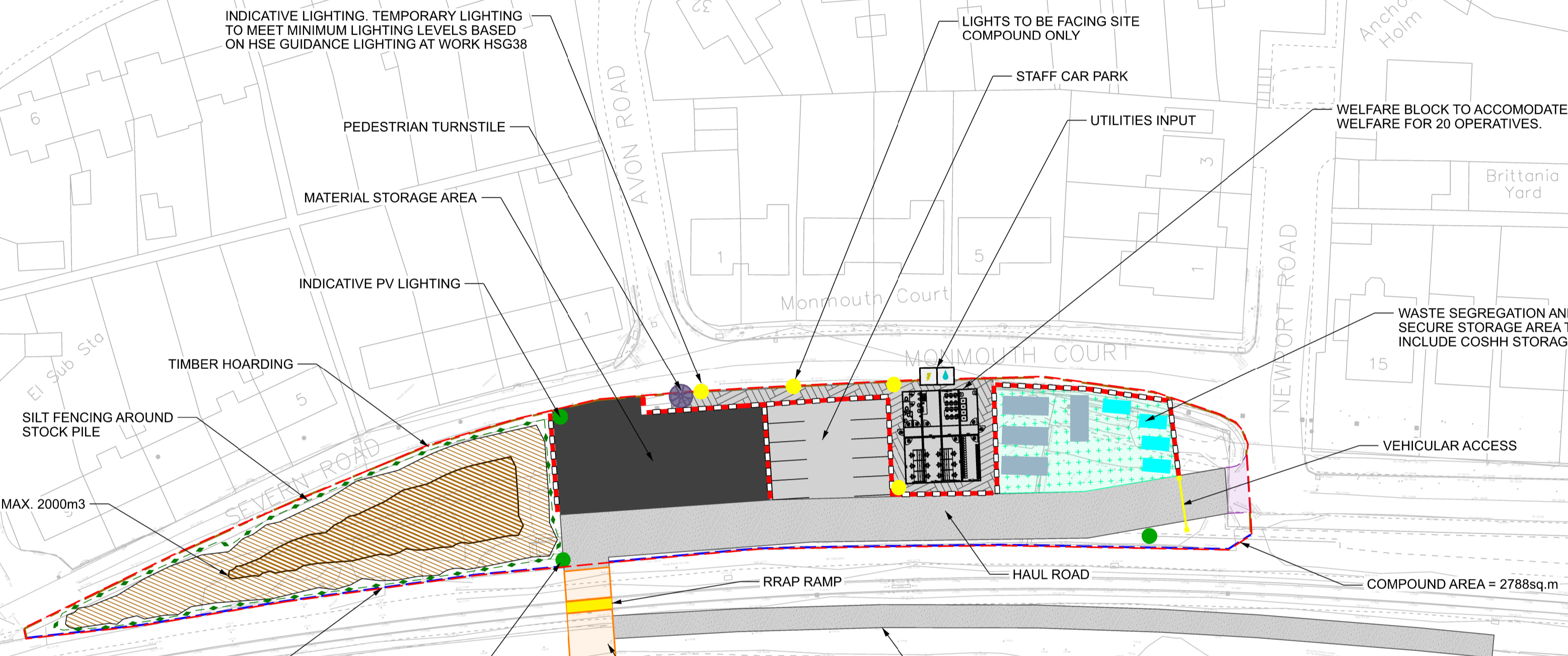

| | | | | | |
|---------------------|----------|------------------------------------|-------|------|------|
| P01 | 11/04/24 | First Issue for DCO requirement 15 | DR | DS | MN |
| Rev | Status | Description of Revisions | Drawn | Chkd | Appr |
| Fit for Information | | | | | S2 |

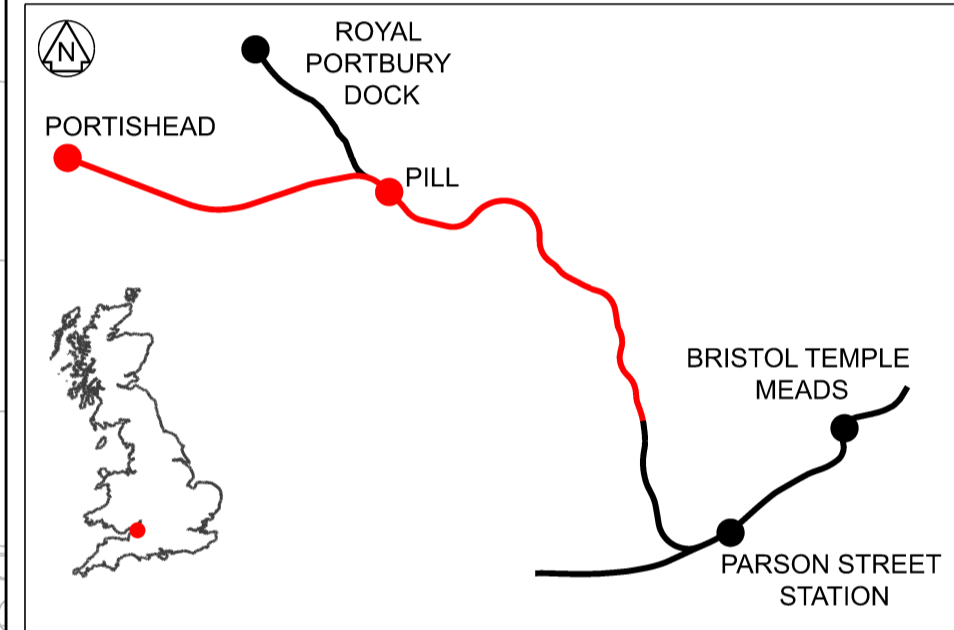

| | | |
|-----------------------------------------------|-------------------------|---------------------|
| Authorised | Signed | Date |
| | Electronically Signed | |
| Contractor(s) VolkerFitzpatrick Ltd | | |
| Location PORTISHEAD BRANCH | | |
| Type | CAD Drawing | Sub-type |
| Role | Rail Engineering | Sub-Role General |
| Zone Western Region | | |
| Phasing | Project Stage GRIP 5 | |

Region
Western and Wales

Contract No.
140569

Contract Title
Metrowest Phase 1b

Drawing Title
**TEMPORARY COMPOUND
MONMOUTH ROAD**

| | | |
|-----------------------|-------------|---------------------------------------|
| Designed | Signed | Date |
| Drawn | D.Richards | 10/04/24 |
| Checked | D.Schofield | 10/04/24 |
| Approved | M.Niles | 11/04/24 |
| Scale(s) | 1:500 | ELR & Mileage 120.0617 to 130.0638 |
| Alternative Reference | Sheet | |

FOR DCO APPROVAL ONLY

OS map data reproduced by permission of Ordnance Survey on behalf of HMSO. © Crown copyright 2023. All rights reserved. Ordnance Survey licence number 0100040892.