

This drawing is the property of Simon Middlecote Architecture Ltd. Copyright is reserved by them and the drawing is issued on the condition that it is not copied, reproduced, retained or disclosed to any unauthorised person, wholly or in part without the written consent of Simon Middlecote Architecture Ltd. All dimensions to be verified on site, do not scale drawing.

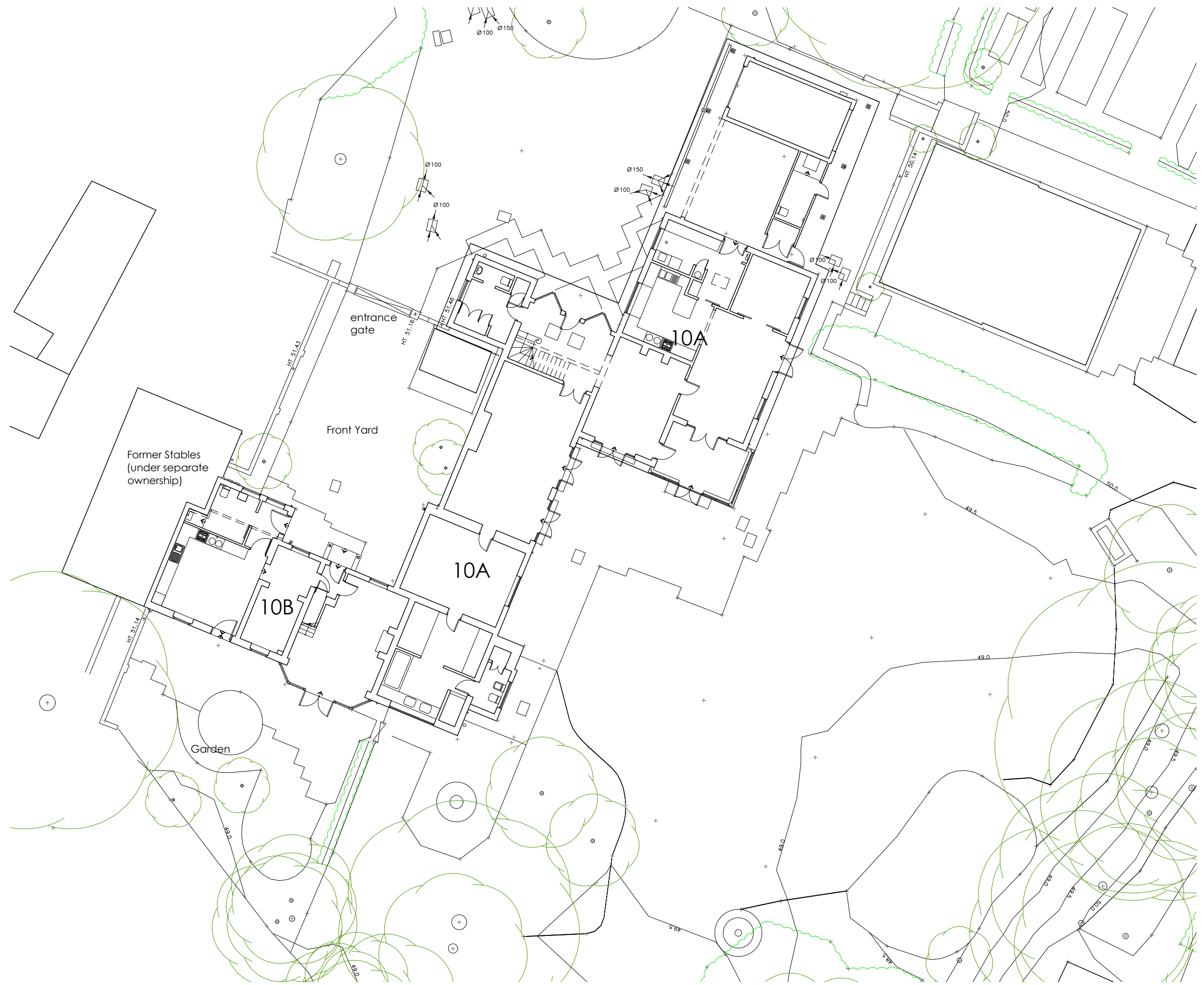

site plan 1:200

Hatching shows shared access with 10A Kneeton Road

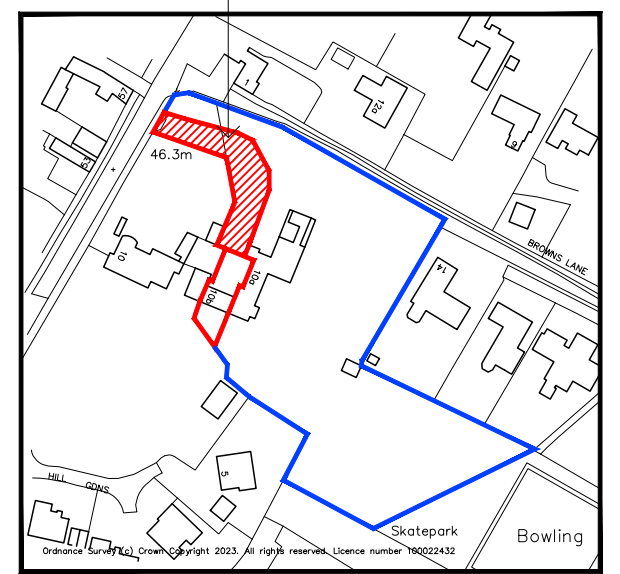

location plan 1:2500

B	18.04.2024	Red line amended	SM
A	20.03.2024	10A plan updated.	SM
Rev	Date	Description	By

Simon Middlecote Architecture Ltd
 7 Mountsorrel Drive
 West Bridgford
 Nottingham
 NG2 6LJ
 T - 07742 301320
 E - info@simonmiddlecote.co.uk

Client:
 Project Title:
 10B Kneeton Road
 East Bridgford

Drawing Title:
 Location Plan and Site Plan as existing

Project No: 23017	Dwg No: (02)02	Revision: B	Scale: 1:2500/1:200
Drawn: SM	Date: 31.12.2023	Status: SURVEY	