

Member Schedule	
Ref.	Section
New beam	225x275dp grade B Oak
New post	150x150 grade B Oak (ex 200x200 to form wider head to post)

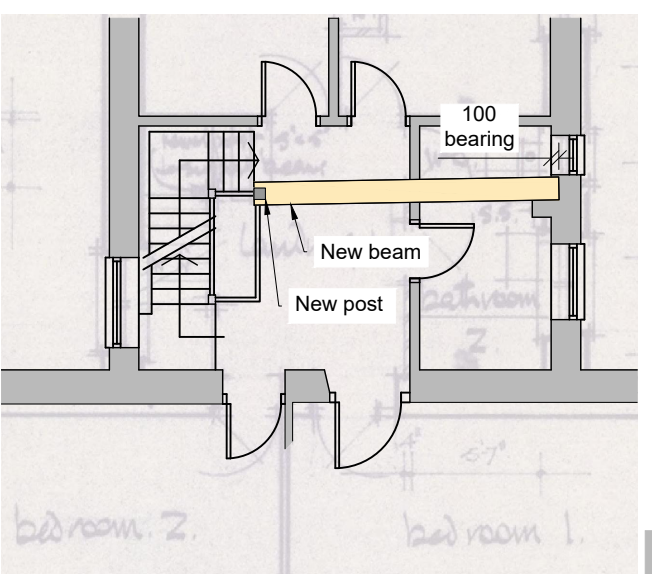
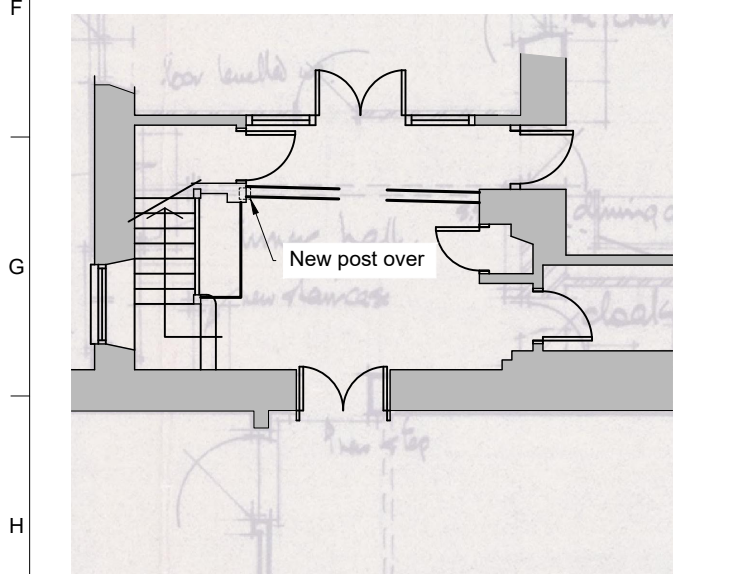
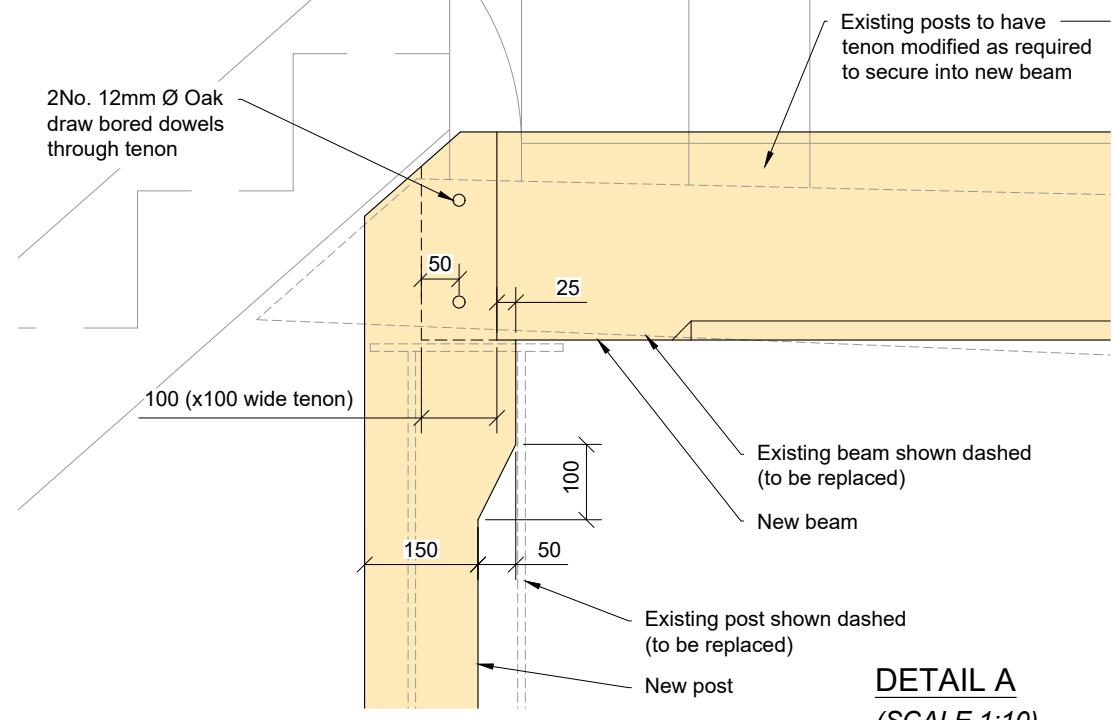

**PART GROUND FLOOR LAYOUT (structure over)**  
(SCALE 1:100)

**PART 1st FLOOR LAYOUT (structure over)**  
(SCALE 1:100)

**NOTE**  
This is a marked up copy of the Architect's drawing. We do not verify the Architect's notes and dimensions as being correct and the contractor must refer to the current Architectural drawing for this information, and check dimensions on site. JCP Engineers accepts no liability for any information of this nature taken from this drawing.

**RISK SCHEDULE**

- Temporary support - there is a risk of injury due to collapse of unsupported or inadequately supported load/structure. The contractor must consider and provide temporary works designed by a suitably qualified person.
- There are no other specific health and safety risks as a direct result of our design apart from common construction issues that are to be assessed by the contractor.

**3rd Angle**

**GENERAL NOTES:**

- This drawing is the copyright of the consultant and must not be used or reproduced, stored in a retrieval system, or transmitted in any form or by any means, electronic, mechanical, photocopy, recording or otherwise without the written consent of the intellectual copyright owner, application for which can be made to JCP Engineers, Unit 7, Boscombe Centre, Mills Way, Amesbury, Wiltshire, SP4 7SD.
- Drawings must not be scaled. Only written dimensions should be used - where no dimensions are given the matter shall be referred to the engineer.
- Should dimensions or details on these drawings conflict, request clarification from the engineer.
- Where this drawing relates to existing or completed construction the contractor shall check that there is no conflict between actual building dimensions and dimensions on the drawings.
- In the event of conflicting information between this drawing and others, this must be reported immediately to the engineer.
- The contractor is responsible for checking the accuracy of all site dimensions, levels and setting out of the work before work commences on site.
- Materials and workmanship are to comply in all respects with current British Standard specifications, codes of practice, and Building Regulations.
- This drawing is to read in conjunction with all relevant architectural, specialists' and other consultants' relevant specifications and drawings.
- The contractor shall provide all necessary bracing and safeguards to ensure the stability of the structure and all associated parts at all times during construction. The design, installation and maintenance of all necessary temporary works is the responsibility of the contractor.
- The works detailed on this drawing may be subject to a Planning or Building Regulations application, and/or the Party Wall Act. Should this be the case all works undertaken prior to obtaining the relevant approvals are at the Contractor's/Client's risk.
- Setting out to is to be in accordance with the Architect's drawings.
- It is the Client's responsibility to ensure that they have engaged the services of a competent person to act in the role of principal designer in accordance with the 2015 CDM regulations, prior to works commencing.

REV.	DESCRIPTION	BY	DATE
A	Detail and beam size amended	sdh	04/04/24
P1	PRELIMINARY ISSUE	sdh	02/04/24

**REVISIONS**

**SUBJECT TO BUILDING CONTROL APPROVAL.**

**JCP**  
Unit 7, Boscombe Centre, 01980 677722  
Mills Way, Amesbury, eng@jcpengineers.co.uk  
Wiltshire, SP4 7SD www.jcpengineers.co.uk

PROJECT TITLE:  
**Brick House**  
Eversley

DRAWING TITLE:  
**Structural Arrangement**

DRAWN	DATE	CHECKED	DATE	APPROVED	DATE
sdh	April '24	sdh	April '24		

DRAWING NO:	SHEET SIZE:	SCALE:	REVISION:
16703-100-01	A3		A