

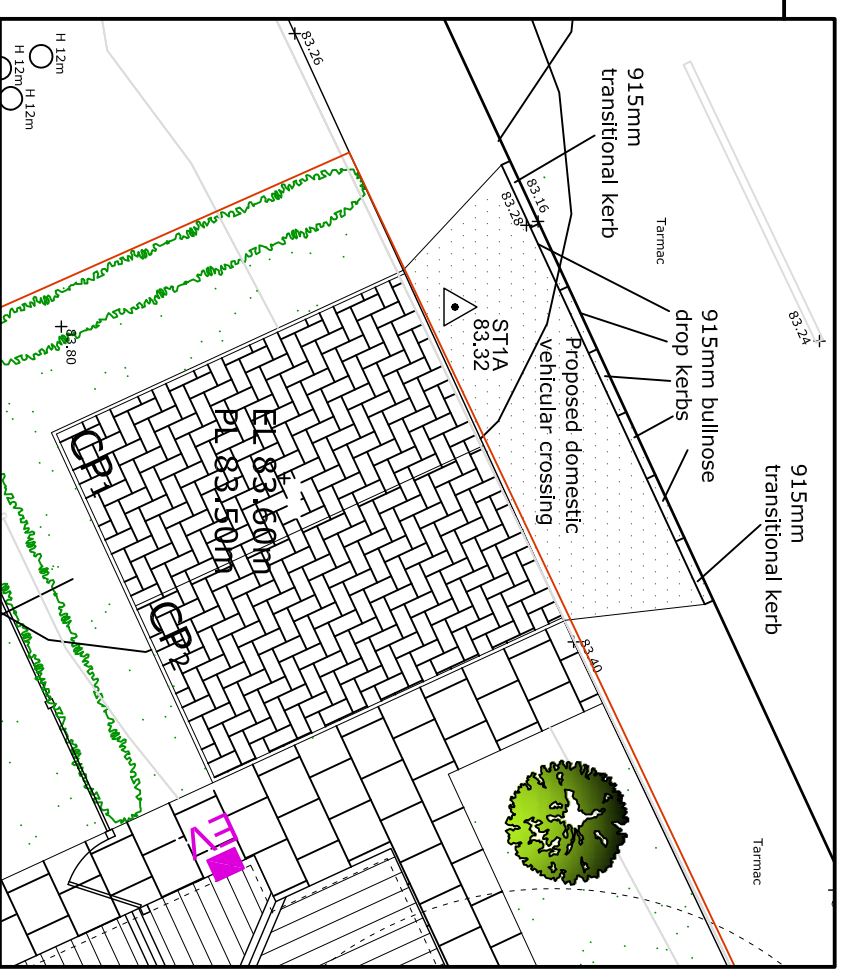

Proposed Site Plan 1:200



Site Plan Extract 1:100

Vehicular crossing to be formed with 20mm medium textured bitumen wearing course (6mm nominal size crushed igneous rock or hardstone), 60mm dense bitumen macadam base course (20mm nominal size CL903 crushed rock), 200mm thick layer of Type 1 crushed rock sub base (CL 803 crushed rock) Crossing to be laid to 1:12 cross fall to highway Full height kerbs - 125mm x 255mm PCC bull nosed set 100mm above highway junction on 150mm x 300mm ST4 concrete bed and 150mm ST4 concrete backing. Dropped Kerbs - 125mm x 150mm PCC bull nosed set 20mm above highway junction on 150mm x 300mm ST4 concrete bed and 150mm ST4 concrete backing.

Title:		Proposed Domestic Vehicular Access Land off Maple Close, Stockport, SK2 6HJ	
Client:		Mr. M. Abbasi	
Scale:		1:100, 1:200 @A3	
Drawing number:		1170-04	
Date:	Drawn by:	Revision:	
26/02/24	SB		

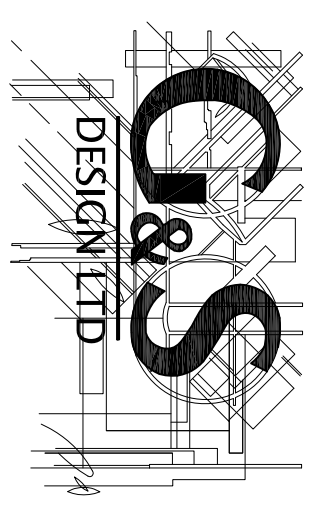

C&S
DESIGN LTD

2 Lady Anne Court, Wheelock Street,
Middlewich, Cheshire CW10 9AG