

**DO'S**

- The arboriculturist should, wherever possible, ensure that the tree is protected from any potential damage to the tree or its roots during the construction process.
- The arboriculturist should ensure that the tree is protected from any potential damage to the tree or its roots during the construction process.

**TREE ROOTS**

**TREES ROOTS**

It is important to ensure that the tree is protected from any potential damage to the tree or its roots during the construction process.

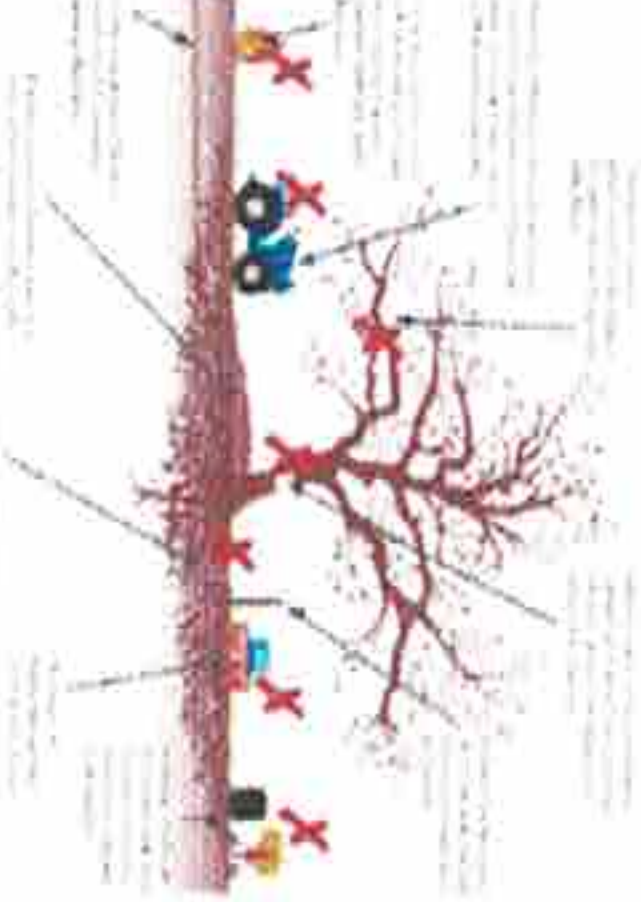
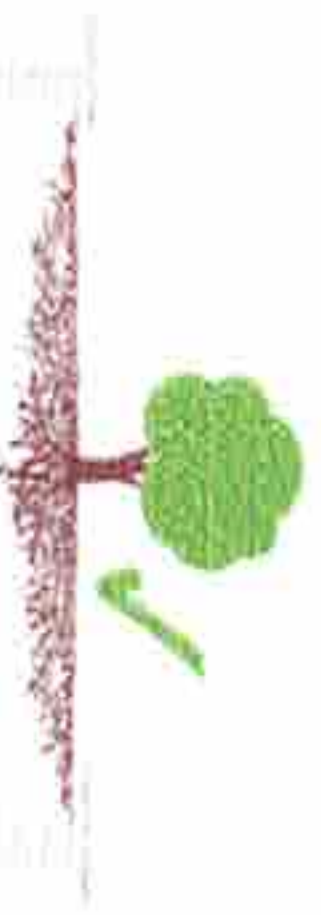

**RESULTS OF BREACHING THE CEZ**

- Soil Compaction:  Soil compaction can cause root damage and reduce the tree's ability to absorb water and nutrients.
- Excavation:  Excavation can cause root damage and reduce the tree's ability to absorb water and nutrients.
- Trenching:  Trenching can cause root damage and reduce the tree's ability to absorb water and nutrients.
- Chemical Spill:  Chemical spills can cause root damage and reduce the tree's ability to absorb water and nutrients.
- Fire:  Fire can cause root damage and reduce the tree's ability to absorb water and nutrients.

01423 322 371 | info@barnesassociates.co.uk | www.barnesassociates.co.uk

**NOTES** - Where works to trees are proposed on site, or to overhanging vegetation to enable construction, this shall be undertaken by qualified tree surgeon in accordance with the requirements of BS3998:2010, prior to the installation of Protective Fencing. Retained trees and vegetation, either within the site or on adjacent land, shall be protected where necessary during works by 2300mm high mesh panel (Heras type) fencing secured to a scaffold tubing framework or supported on a suitable base pinned into the ground and connected by none tamper fixings.

Protective fencing shall be erected outside the canopy drip-line or beyond the minimum Root Protection Area (RPA) distance wherever possible. The tree works & fencing works shall be carried out prior to any demolition, groundworks, construction works.

Laminated, waterproof A4 signs shall be fixed to the fence posts at 10m intervals bearing the words 'CONSTRUCTION EXCLUSION ZONE - NO STORAGE OR OPERATIONS WITHIN FENCED AREA' as per the example on the plan.

**PROTECTION OF CONSTRUCTION EXCLUSION ZONE**

Inside the exclusion area of the fencing, the following prohibitions shall apply:

- No mechanical excavation whatsoever.
- No excavation by any other means without arboricultural site monitoring.
- No hand digging without a written Method Statement approved in writing by the Project Arborist.
- No lowering of levels for any purpose (except removal of grass sward using hand tools).
- No construction of a sealed hard surface - except where agreed with the Project Arborist.
- No storage of plant or materials.
- No storage or handling of any chemical, including cement washings.
- No vehicular access.
- No fire lighting. In addition to the above, further precautions are necessary adjacent to trees:

- A 10m separation distance shall be observed between any tree and substances injurious to tree health, including fuel, oil, bitumen, cement (including cement washings), builders' sand, concrete mixing and other chemicals.
  - No fire shall be lit such that flames come within 5m of tree foliage; this shall be taken to mean a fire separation distance of 20m from any tree's canopy.
- ALL WORKS AFFECTING TREES SHALL BE SUBJECT TO THE REQUIREMENTS OF BS5837:2012.**

**Sequence for tree Protection during Development.**

Phase	Key Elements to be Applied	Phase Sign-off & Approval
<b>PHASE 1</b> CONSTRUCTION START	<ul style="list-style-type: none"> <li>• Tree Protection Fencing (TPF) installed</li> <li>• Root Protection Area (RPA) established</li> <li>• Construction Exclusion Zone (CEZ) established</li> </ul>	Project Arborist
<b>PHASE 2</b> CONSTRUCTION PROGRESS	<ul style="list-style-type: none"> <li>• Regular site monitoring</li> <li>• Tree Protection Fencing (TPF) maintained</li> <li>• Root Protection Area (RPA) maintained</li> <li>• Construction Exclusion Zone (CEZ) maintained</li> </ul>	Project Arborist
<b>PHASE 3</b> FINAL EXCAVATION STAGE	<ul style="list-style-type: none"> <li>• Final site monitoring</li> <li>• Tree Protection Fencing (TPF) removed</li> <li>• Root Protection Area (RPA) removed</li> <li>• Construction Exclusion Zone (CEZ) removed</li> </ul>	Project Arborist
<b>PHASE 4</b> POST DEVELOPMENT STAGE	<ul style="list-style-type: none"> <li>• Final site monitoring</li> <li>• Tree Protection Fencing (TPF) removed</li> <li>• Root Protection Area (RPA) removed</li> <li>• Construction Exclusion Zone (CEZ) removed</li> </ul>	Project Arborist



**Tree Protection Fencing Type TPF 3**

**Tree Protection Methods**

Construction 1 to be shown: Zone (C1, C2)

Construction 2 to be shown: Zone (C1, C2)

Construction 3 to be shown: Zone (C1, C2)

Construction 4 to be shown: Zone (C1, C2)

Construction 5 to be shown: Zone (C1, C2)

Construction 6 to be shown: Zone (C1, C2)

Construction 7 to be shown: Zone (C1, C2)

Construction 8 to be shown: Zone (C1, C2)

Construction 9 to be shown: Zone (C1, C2)

Construction 10 to be shown: Zone (C1, C2)

Construction 11 to be shown: Zone (C1, C2)

Construction 12 to be shown: Zone (C1, C2)

Construction 13 to be shown: Zone (C1, C2)

Construction 14 to be shown: Zone (C1, C2)

Construction 15 to be shown: Zone (C1, C2)

Construction 16 to be shown: Zone (C1, C2)

Construction 17 to be shown: Zone (C1, C2)

Construction 18 to be shown: Zone (C1, C2)

Construction 19 to be shown: Zone (C1, C2)

Construction 20 to be shown: Zone (C1, C2)

Construction 21 to be shown: Zone (C1, C2)

Construction 22 to be shown: Zone (C1, C2)

Construction 23 to be shown: Zone (C1, C2)

Construction 24 to be shown: Zone (C1, C2)

Construction 25 to be shown: Zone (C1, C2)

Construction 26 to be shown: Zone (C1, C2)

Construction 27 to be shown: Zone (C1, C2)

Construction 28 to be shown: Zone (C1, C2)

Construction 29 to be shown: Zone (C1, C2)

Construction 30 to be shown: Zone (C1, C2)

Construction 31 to be shown: Zone (C1, C2)

Construction 32 to be shown: Zone (C1, C2)

Construction 33 to be shown: Zone (C1, C2)

Construction 34 to be shown: Zone (C1, C2)

Construction 35 to be shown: Zone (C1, C2)

Construction 36 to be shown: Zone (C1, C2)

Construction 37 to be shown: Zone (C1, C2)

Construction 38 to be shown: Zone (C1, C2)

Construction 39 to be shown: Zone (C1, C2)

Construction 40 to be shown: Zone (C1, C2)

Construction 41 to be shown: Zone (C1, C2)

Construction 42 to be shown: Zone (C1, C2)

Construction 43 to be shown: Zone (C1, C2)

Construction 44 to be shown: Zone (C1, C2)

Construction 45 to be shown: Zone (C1, C2)

Construction 46 to be shown: Zone (C1, C2)

Construction 47 to be shown: Zone (C1, C2)

Construction 48 to be shown: Zone (C1, C2)

Construction 49 to be shown: Zone (C1, C2)

Construction 50 to be shown: Zone (C1, C2)

Construction 51 to be shown: Zone (C1, C2)

Construction 52 to be shown: Zone (C1, C2)

Construction 53 to be shown: Zone (C1, C2)

Construction 54 to be shown: Zone (C1, C2)

Construction 55 to be shown: Zone (C1, C2)

Construction 56 to be shown: Zone (C1, C2)

Construction 57 to be shown: Zone (C1, C2)

Construction 58 to be shown: Zone (C1, C2)

Construction 59 to be shown: Zone (C1, C2)

Construction 60 to be shown: Zone (C1, C2)

Construction 61 to be shown: Zone (C1, C2)

Construction 62 to be shown: Zone (C1, C2)

Construction 63 to be shown: Zone (C1, C2)

Construction 64 to be shown: Zone (C1, C2)

Construction 65 to be shown: Zone (C1, C2)

Construction 66 to be shown: Zone (C1, C2)

Construction 67 to be shown: Zone (C1, C2)

Construction 68 to be shown: Zone (C1, C2)

Construction 69 to be shown: Zone (C1, C2)

Construction 70 to be shown: Zone (C1, C2)

Construction 71 to be shown: Zone (C1, C2)

Construction 72 to be shown: Zone (C1, C2)

Construction 73 to be shown: Zone (C1, C2)

Construction 74 to be shown: Zone (C1, C2)

Construction 75 to be shown: Zone (C1, C2)

Construction 76 to be shown: Zone (C1, C2)

Construction 77 to be shown: Zone (C1, C2)

Construction 78 to be shown: Zone (C1, C2)

Construction 79 to be shown: Zone (C1, C2)

Construction 80 to be shown: Zone (C1, C2)

Construction 81 to be shown: Zone (C1, C2)

Construction 82 to be shown: Zone (C1, C2)

Construction 83 to be shown: Zone (C1, C2)

Construction 84 to be shown: Zone (C1, C2)

Construction 85 to be shown: Zone (C1, C2)

Construction 86 to be shown: Zone (C1, C2)

Construction 87 to be shown: Zone (C1, C2)

Construction 88 to be shown: Zone (C1, C2)

Construction 89 to be shown: Zone (C1, C2)

Construction 90 to be shown: Zone (C1, C2)

Construction 91 to be shown: Zone (C1, C2)

Construction 92 to be shown: Zone (C1, C2)

Construction 93 to be shown: Zone (C1, C2)

Construction 94 to be shown: Zone (C1, C2)

Construction 95 to be shown: Zone (C1, C2)

Construction 96 to be shown: Zone (C1, C2)

Construction 97 to be shown: Zone (C1, C2)

Construction 98 to be shown: Zone (C1, C2)

Construction 99 to be shown: Zone (C1, C2)

Construction 100 to be shown: Zone (C1, C2)

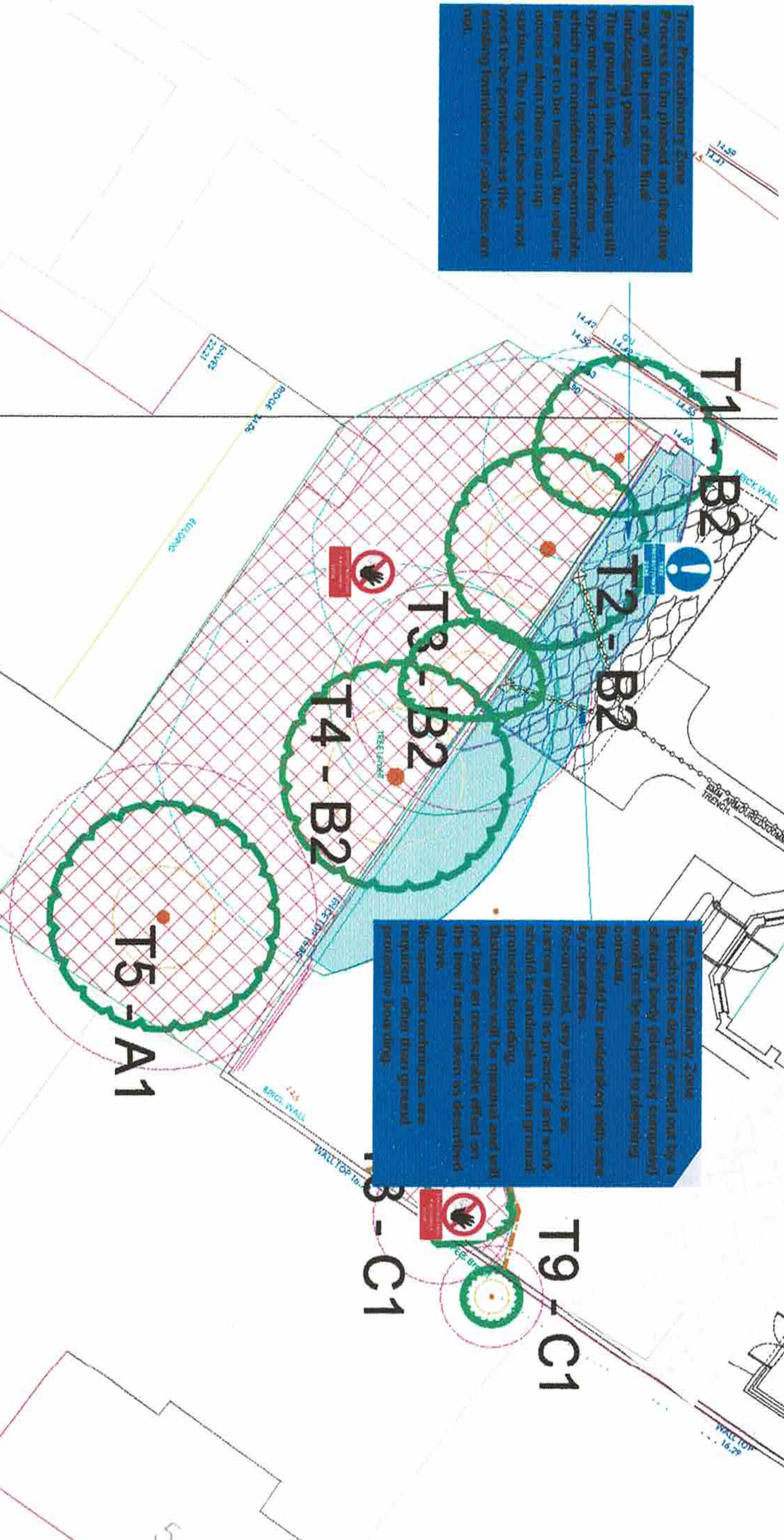

**Tree Protection Fencing Type TPF 3**

**Tree Protection Methods**

Construction 1 to be shown: Zone (C1, C2)

Construction 2 to be shown: Zone (C1, C2)

Construction 3 to be shown: Zone (C1, C2)

Construction 4 to be shown: Zone (C1, C2)

Construction 5 to be shown: Zone (C1, C2)

Construction 6 to be shown: Zone (C1, C2)

Construction 7 to be shown: Zone (C1, C2)

Construction 8 to be shown: Zone (C1, C2)

Construction 9 to be shown: Zone (C1, C2)

Construction 10 to be shown: Zone (C1, C2)

Construction 11 to be shown: Zone (C1, C2)

Construction 12 to be shown: Zone (C1, C2)

Construction 13 to be shown: Zone (C1, C2)

Construction 14 to be shown: Zone (C1, C2)

Construction 15 to be shown: Zone (C1, C2)

Construction 16 to be shown: Zone (C1, C2)

Construction 17 to be shown: Zone (C1, C2)

Construction 18 to be shown: Zone (C1, C2)

Construction 19 to be shown: Zone (C1, C2)

Construction 20 to be shown: Zone (C1, C2)

Construction 21 to be shown: Zone (C1, C2)

Construction 22 to be shown: Zone (C1, C2)

Construction 23 to be shown: Zone (C1, C2)

Construction 24 to be shown: Zone (C1, C2)

Construction 25 to be shown: Zone (C1, C2)

Construction 26 to be shown: Zone (C1, C2)

Construction 27 to be shown: Zone (C1, C2)

Construction 28 to be shown: Zone (C1, C2)

Construction 29 to be shown: Zone (C1, C2)

Construction 30 to be shown: Zone (C1, C2)

Construction 31 to be shown: Zone (C1, C2)

Construction 32 to be shown: Zone (C1, C2)

Construction 33 to be shown: Zone (C1, C2)

Construction 34 to be shown: Zone (C1, C2)

Construction 35 to be shown: Zone (C1, C2)

Construction 36 to be shown: Zone (C1, C2)

Construction 37 to be shown: Zone (C1, C2)

Construction 38 to be shown: Zone (C1, C2)

Construction 39 to be shown: Zone (C1, C2)

Construction 40 to be shown: Zone (C1, C2)

Construction 41 to be shown: Zone (C1, C2)

Construction 42 to be shown: Zone (C1, C2)

Construction 43 to be shown: Zone (C1, C2)

Construction 44 to be shown: Zone (C1, C2)

Construction 45 to be shown: Zone (C1, C2)

Construction 46 to be shown: Zone (C1, C2)

Construction 47 to be shown: Zone (C1, C2)

Construction 48 to be shown: Zone (C1, C2)

Construction 49 to be shown: Zone (C1, C2)

Construction 50 to be shown: Zone (C1, C2)

Construction 51 to be shown: Zone (C1, C2)

Construction 52 to be shown: Zone (C1, C2)

Construction 53 to be shown: Zone (C1, C2)

Construction 54 to be shown: Zone (C1, C2)

Construction 55 to be shown: Zone (C1, C2)

Construction 56 to be shown: Zone (C1, C2)

Construction 57 to be shown: Zone (C1, C2)

Construction 58 to be shown: Zone (C1, C2)

Construction 59 to be shown: Zone (C1, C2)

Construction 60 to be shown: Zone (C1, C2)

Construction 61 to be shown: Zone (C1, C2)

Construction 62 to be shown: Zone (C1, C2)

Construction 63 to be shown: Zone (C1, C2)

Construction 64 to be shown: Zone (C1, C2)

Construction 65 to be shown: Zone (C1, C2)

Construction 66 to be shown: Zone (C1, C2)

Construction 67 to be shown: Zone (C1, C2)

Construction 68 to be shown: Zone (C1, C2)

Construction 69 to be shown: Zone (C1, C2)

Construction 70 to be shown: Zone (C1, C2)

Construction 71 to be shown: Zone (C1, C2)

Construction 72 to be shown: Zone (C1, C2)

Construction 73 to be shown: Zone (C1, C2)

Construction 74 to be shown: Zone (C1, C2)

Construction 75 to be shown: Zone (C1, C2)

Construction 76 to be shown: Zone (C1, C2)

Construction 77 to be shown: Zone (C1, C2)

Construction 78 to be shown: Zone (C1, C2)

Construction 79 to be shown: Zone (C1, C2)

Construction 80 to be shown: Zone (C1, C2)

Construction 81 to be shown: Zone (C1, C2)

Construction 82 to be shown: Zone (C1, C2)

Construction 83 to be shown: Zone (C1, C2)

Construction 84 to be shown: Zone (C1, C2)

Construction 85 to be shown: Zone (C1, C2)

Construction 86 to be shown: Zone (C1, C2)

Construction 87 to be shown: Zone (C1, C2)

Construction 88 to be shown: Zone (C1, C2)

Construction 89 to be shown: Zone (C1, C2)

Construction 90 to be shown: Zone (C1, C2)

Construction 91 to be shown: Zone (C1, C2)

Construction 92 to be shown: Zone (C1, C2)

Construction 93 to be shown: Zone (C1, C2)

Construction 94 to be shown: Zone (C1, C2)

Construction 95 to be shown: Zone (C1, C2)

Construction 96 to be shown: Zone (C1, C2)

Construction 97 to be shown: Zone (C1, C2)

Construction 98 to be shown: Zone (C1, C2)

Construction 99 to be shown: Zone (C1, C2)

Construction 100 to be shown: Zone (C1, C2)