



FLAT ROOF LIGHT
VELUX or similar
slim line aluminium
roof light

To be double glazed + to meet 'U' value of
min. 2.0W/m sq.K. All roof lights to be A-A
fire rated.
Fully thermally broken construction.
Double up rafters on the side of opening,
supporting double trimmers above & below
opening.
Bolt together with M12 bolts at 450 c/s.
Fixed in accordance with the
manufacturers instructions.

- New internal walls
- New external walls
- Walls to be demolished
- New doors/windows
- Proposed work shaded

NEIGHBOURS HOUSE
3 Rushmoor Close

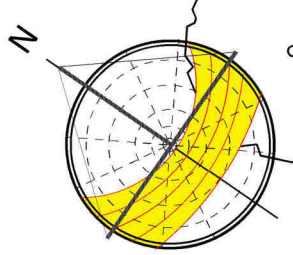
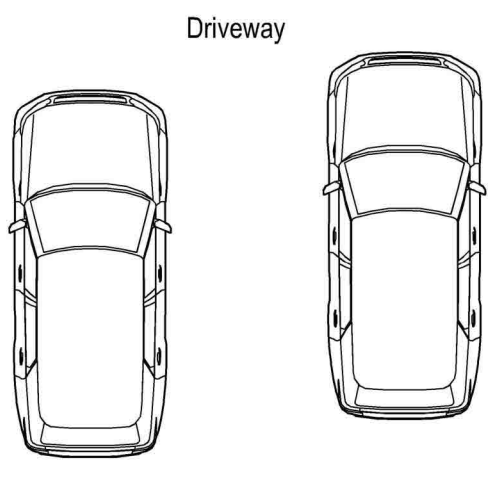
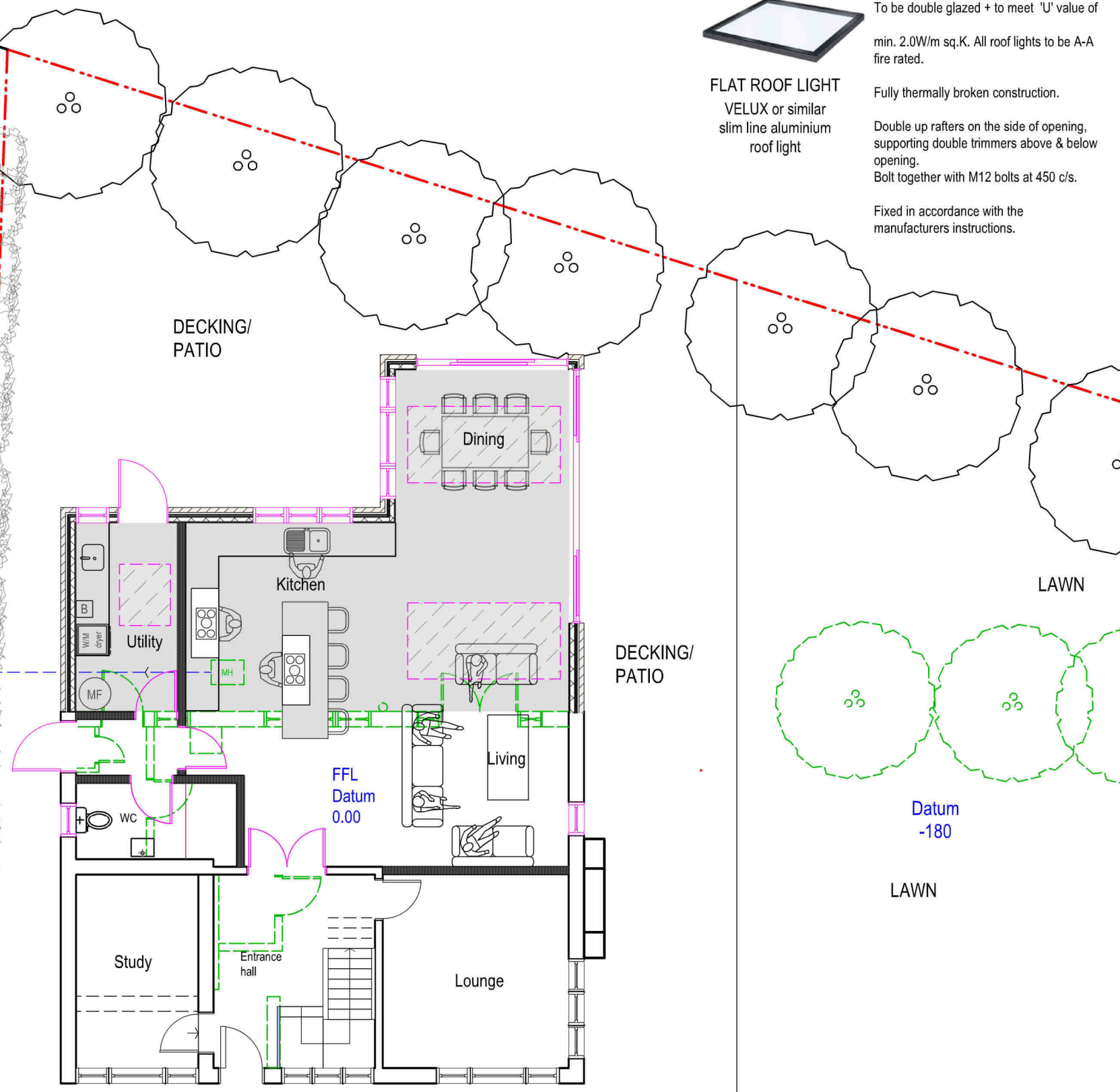

13 **PROP GF PLAN**
Scale: 1:100

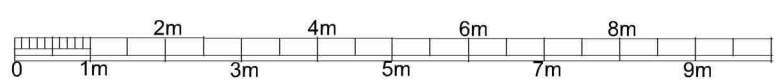

scale - 1 : 100 @ A3

NEIGHBOURS HOUSE
5 Rushmoor Close

Purpose - Householder planning application

All dimensions to be checked on site. All omissions & discrepancies to be reported to the designer. © SSK architects owns the copyright of this drawing which must not be reproduced in whole or part without the written permission.	PROJECT: 4 Rushmoor Close, WD3 1NA	DATE: 10/03/2024
	DWG NO: PROP GF	REVISION: 13

PROPOSED