

Notes

THIS DRAWING IS COPYRIGHT ©.

ALL DIMENSIONS TO BE CHECKED ON SITE BEFORE WORK COMMENCES. DISCREPANCIES TO BE REPORTED TO STUDIO MARSHALL.

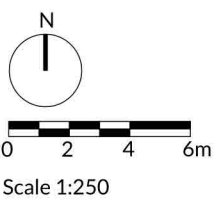
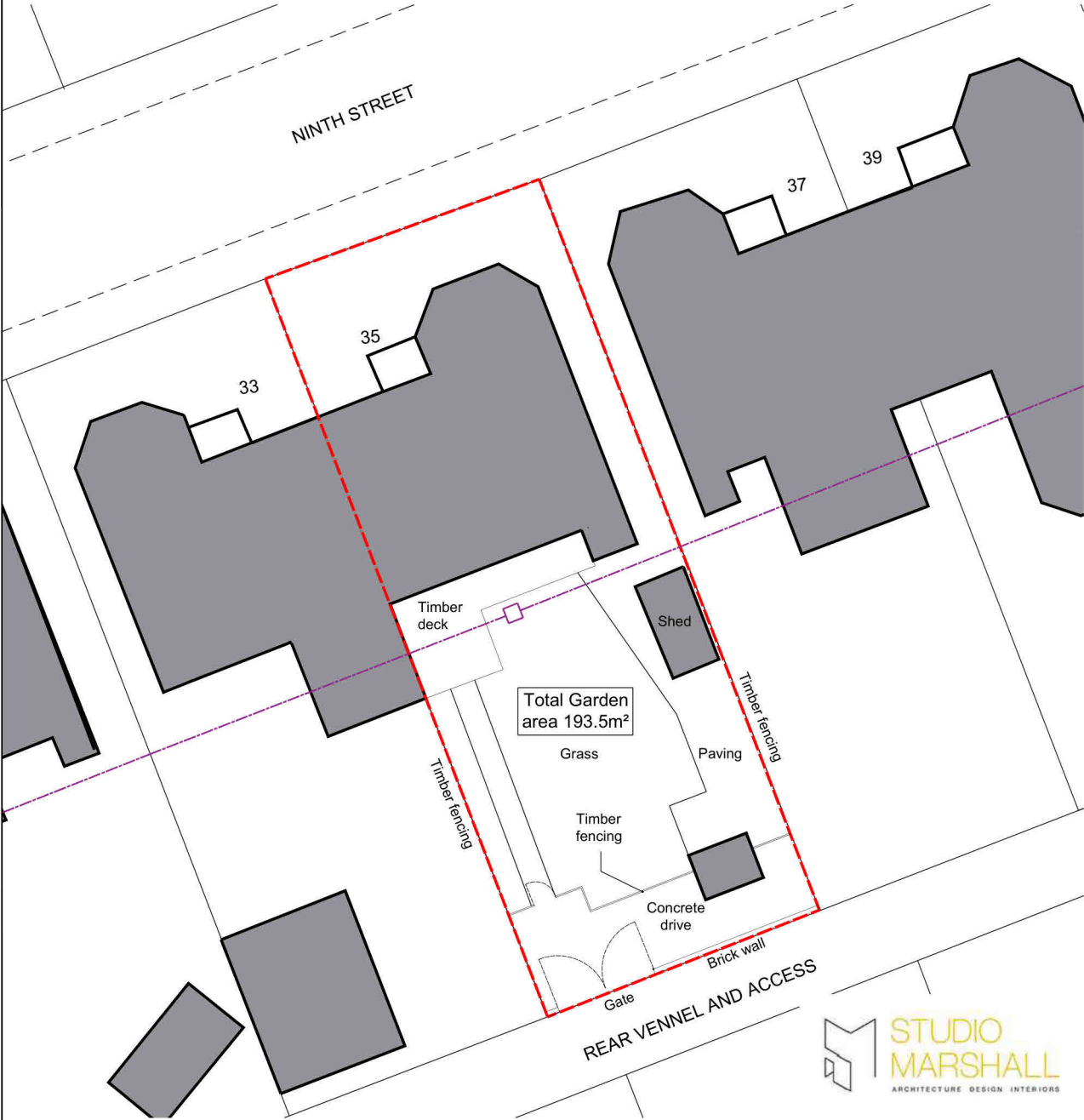

This copy has been made by or with the authority of Midlothian Council pursuant to Section 47 of the Designs and Patents Act 1988. Unless that Act provides a relevant exception to copyright, the copy must not be copied without the prior permission of the copyright owner.



Project Name and Address

Ms I Woods  
Proposed Rear Extension

35 Ninth Street,  
Newtongrange

Drawing Title	Drawing number
Existing Site Plan	24001_L_002
Date	
Scale	
	1:250