

PROPOSED

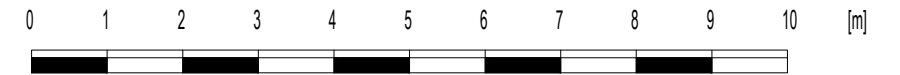
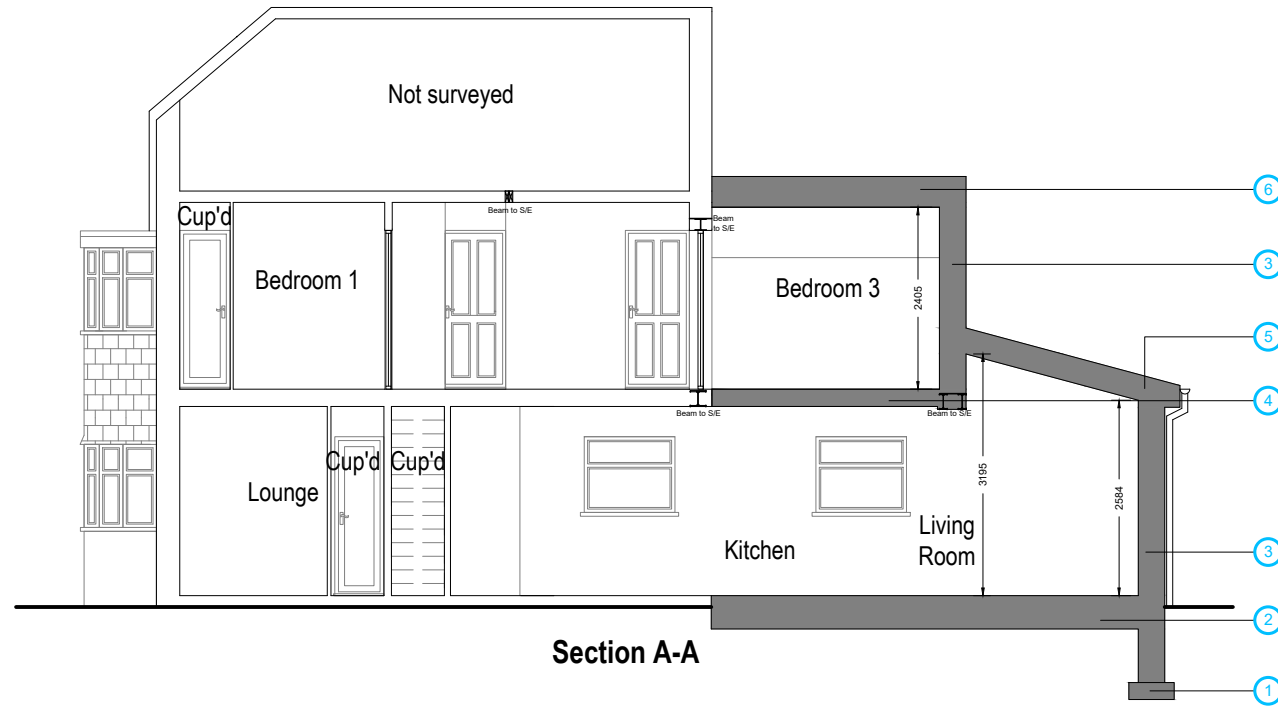

Note to Contractor: Contractor is recommended to carry out an intrusive site investigation prior to commencing works on site to ensure all details designed for this project are appropriate. Contractor to cross reference with Structural Calculations package for suitability, to assess site levels and confirm any design assumptions within the calculations package prior to works commencing on site. If the Contractor requires any additional information, please send a Request For Information to hello@planituk.co.uk before ordering materials and starting the works - requests will be acknowledged and responded to as soon as possible. Please ensure that the drawings have been submitted to Building Control for a Full Plans submission and the compliance report has been discharged before starting works on site.

Drawn by:

DK

Client:

D Iacovou

Project:

9 Charmouth Rd, Welling DA16 1RH

Drawing Title:

SECTION A-A

Date:

10.04.2024

Scale @A3:

1:100

Issue:

BUILDING REGULATIONS

No.:

22-1512

Rev:

04

Page:

D07

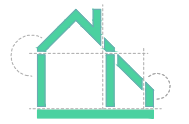

Plan It
Architectural Services

www.planituk.co.uk