

Allow for warm deck built up with single ply system on 18mm thick WBP plywood on 150mm thick KINGSPAN THERMAROOF insulation fixed plywood base onto tilting fillets on 150mm x 50mm C16 Joists at 450mm c/c allow for trimming around roof lights see engineers specification as these dimension may change. Allow for soft wood fascia and soffits.

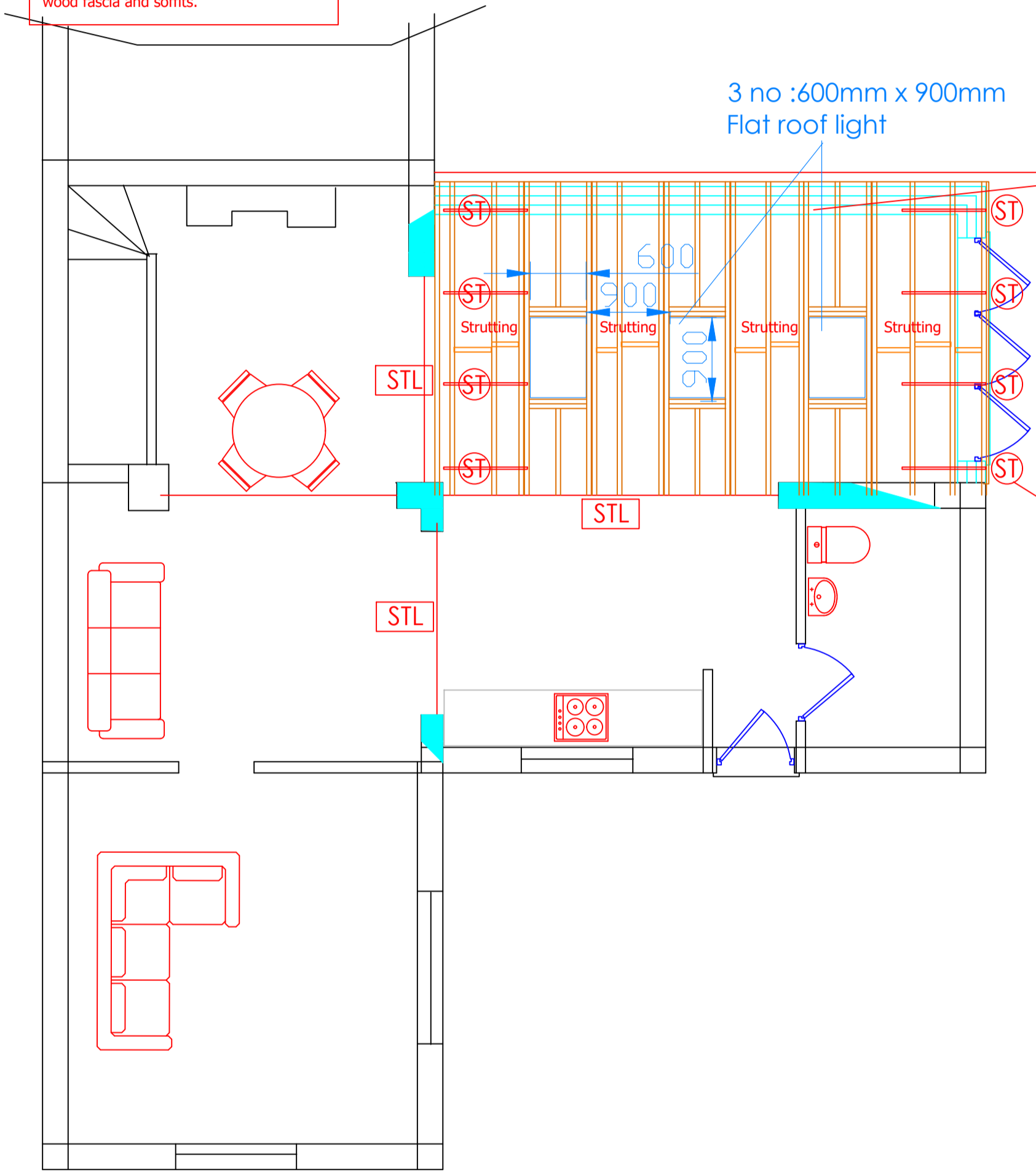

A1 - Allow for strapping to wall plate and at ceiling level, allow for 30mm x 5mm galvanized straps carried down min 600mm and fixed to walling.

A1 - Allow for horizontal strapping to ceiling joists carried over 3no supported on noggins

All steels must be encased to give min 30min fire protection for sizes see engineers specification and detailing

ST DENOTES STRAPPING AS PART A - Allow for horizontal strapping where joist or rafters run 90 degrees to walling, allow for 30mm x 5mm galv straps at floor and ceiling level carried over 3no: trusses supported on soft wood noggins

STL Denotes steel over see engineers detail and specification. All steel must be encased in plaster board to min 30mins protection

Simon Gee owns the copyright © of this drawing which is not to be copied, reproduced or disclosed to a third party without written permission of Simon Gee

Client: Mr J. Dymock
Address: Milne Croft Cottage
40 Green Lane
Lambley
Nottingham

Project: Proposed Kitchen Extension
Title: Roof Plan

Drawn by: Simon Gee Designs
Date: 20:03:2024
Job No. PL-GL-2024-04
Scale: 1:50 @ A1