

**Existing Roof Plan Extract**

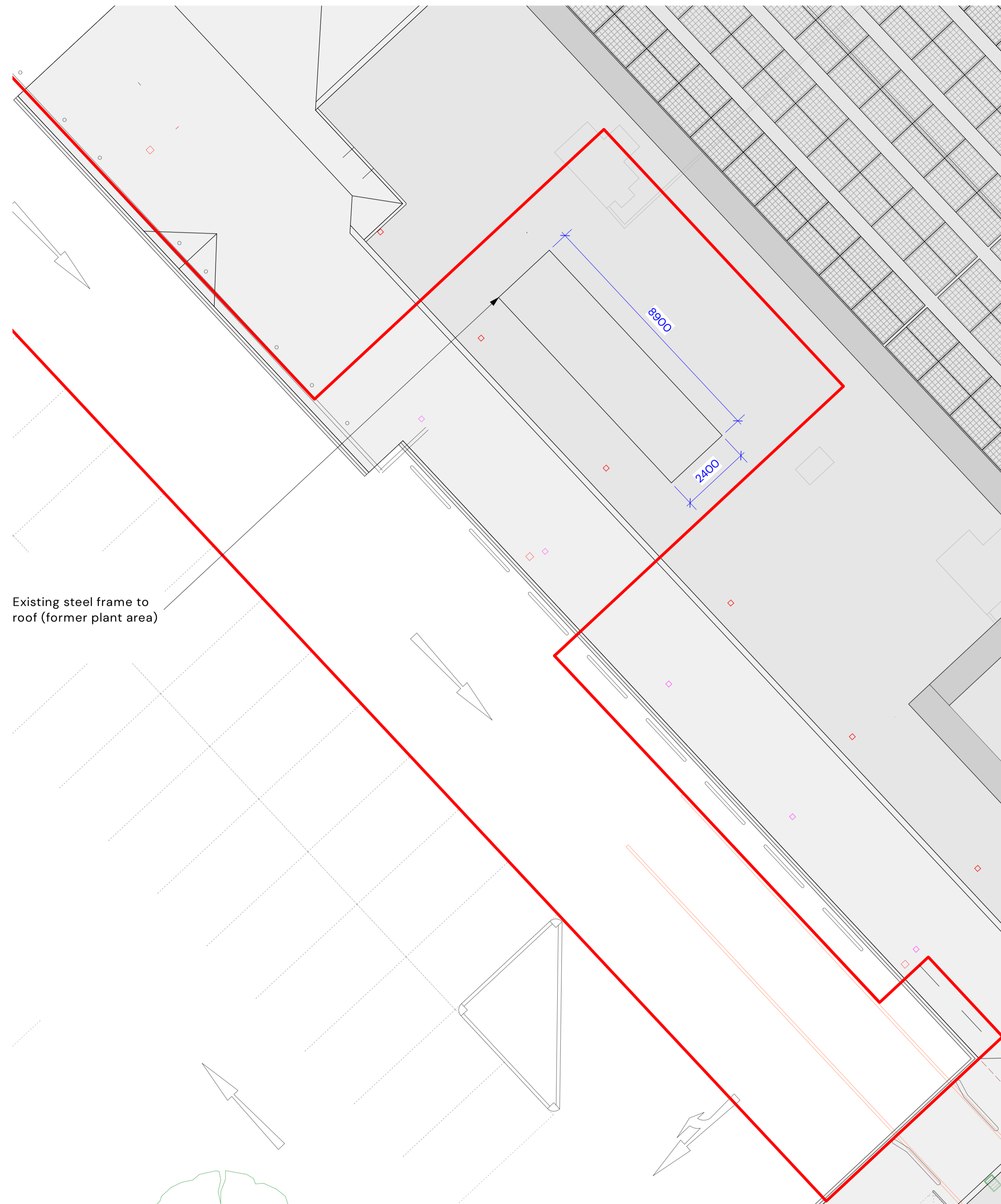

**NOTES:**  
 Refer to K2 drawing for plant compound details.  
 This drawing is based on record information only. Actual features on site may differ from those shown on this drawing.

**KEY:**  
 Application boundary

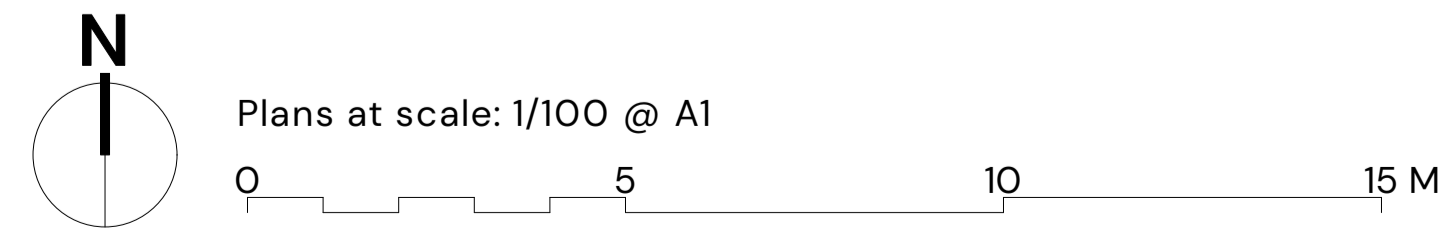

**Proposed Roof Plan Extract**

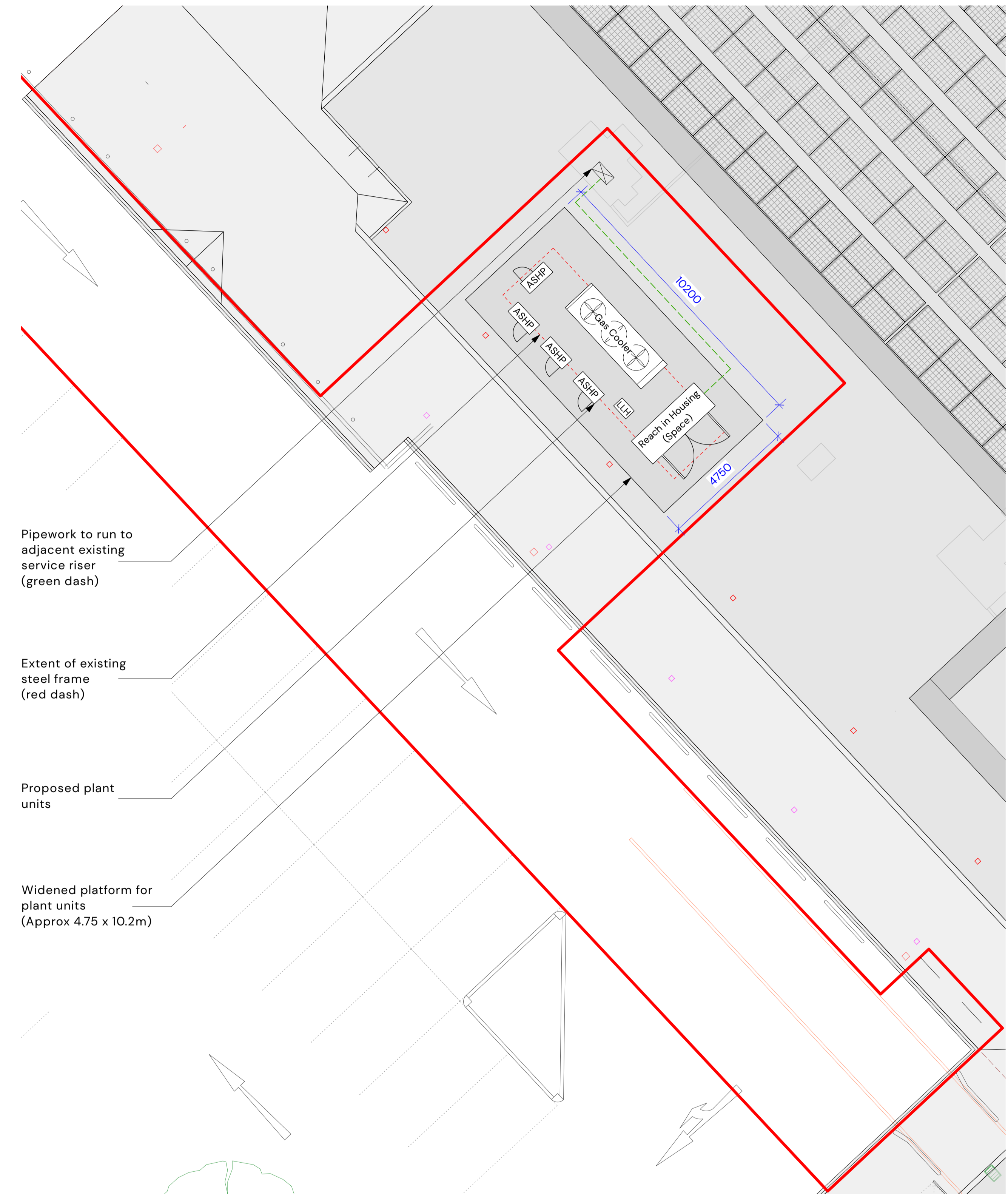

Rev	Date	By	Ap	Note
P02	11/04/2024	JS	GS	Application area extended to cover revised plant proposals at ground level. Units at ground level rearranged in line with latest refrigeration plant proposals.
P01	08/03/2024	DG	JS	Drawing issue.

	<b>Kendall Kingscott</b> Glentworth Court, Lime Kiln Close, Stoke Gifford, Bristol, BS34 8SR +44 (0)117 931 2062 www.kendallkingscott.co.uk	Project #35 Aldi Portishead, Wyndham Way Client ALDI Stores Ltd	Date 07/03/2024 Scale 1:100 Filename 240117 Portishead Plant PF MASTER.rwx	Drawn DG Checked JS Purpose/Status PLANNING Paper Size ISO A1	Drawing Title <b>Plant Compound Roof Plan</b> Project Number/Drawing Number 240117-1200 Check all dimensions and levels on site	Revision <b>P02</b> © Copyright
		<small>Only to be used on the site for which designed. The electronic transmission of designs/information contained in this drawing is carried out entirely at the User's risk and Kendall Kingscott Ltd. will have no liability for any errors or inaccuracies arising therefrom. The production of amended or updated information from the said design/information by the User is entirely the responsibility of the User and Kendall Kingscott Ltd. shall have no responsibility in respect thereof whatsoever.</small>				