

Plan, not to scale showing

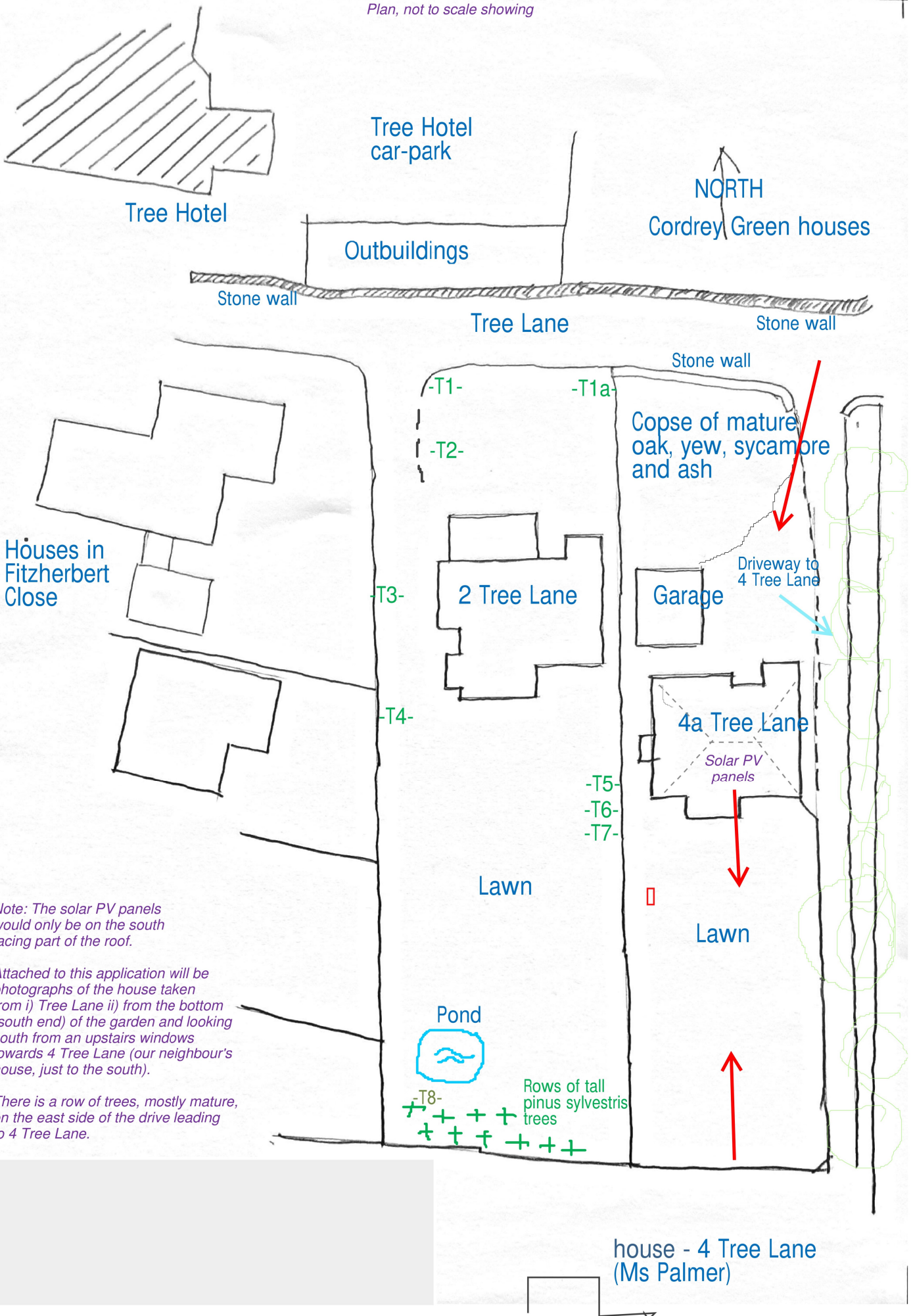

NORTH
Cordrey Green houses

Tree Hotel
car-park
Outbuildings

Stone wall
Tree Lane
Stone wall

Houses in Fitzherbert Close

-T1-
-T1a-
-T2-

Copse of mature oak, yew, sycamore and ash

Driveway to 4 Tree Lane

2 Tree Lane

Garage

-T3-

4a Tree Lane
Solar PV panels

-T4-

-T5-
-T6-
-T7-

Lawn

Lawn

Note: The solar PV panels would only be on the south facing part of the roof.

Attached to this application will be photographs of the house taken from i) Tree Lane ii) from the bottom (south end) of the garden and looking south from an upstairs windows towards 4 Tree Lane (our neighbour's house, just to the south).

There is a row of trees, mostly mature, on the east side of the drive leading to 4 Tree Lane.

Pond

-T8-
Rows of tall pinus sylvestris trees

house - 4 Tree Lane (Ms Palmer)