

NOTES
 © SIDLEYS - THE COPYRIGHT OF ALL OR PART OF THIS DRAWING RESTS WITH SIDLEYS CHARTERED SURVEYORS.
 ALL DIMENSIONS SHALL BE CHECKED BY THE PARTY TO WHOM THE DRAWING HAS BEEN ISSUED. ANY DISCREPANCIES SHALL BE BROUGHT TO THE ATTENTION OF SIDLEYS.
 DO NOT SCALE FROM THIS DRAWING.
 THIS DRAWING HAS BEEN REPRODUCED FROM INFORMATION PROVIDED BY MIDLAND SURVEY LTD AND HAS NOT BEEN SUBJECT OF A MEASURED SURVEY BY SIDLEYS CHARTERED SURVEYORS.

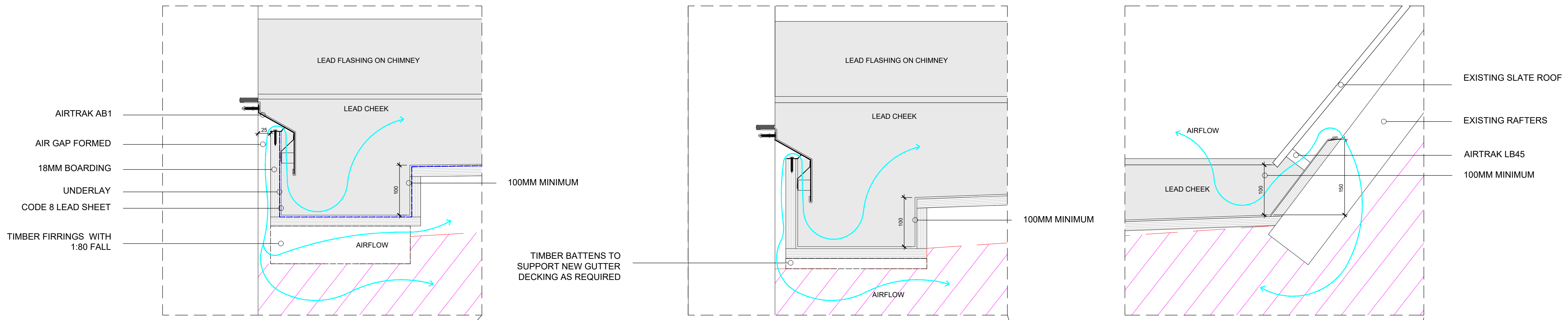

KEY

- EXISTING ROOF STRUCTURE - NOT SURVEYED
- EXISTING ROOF LEVEL

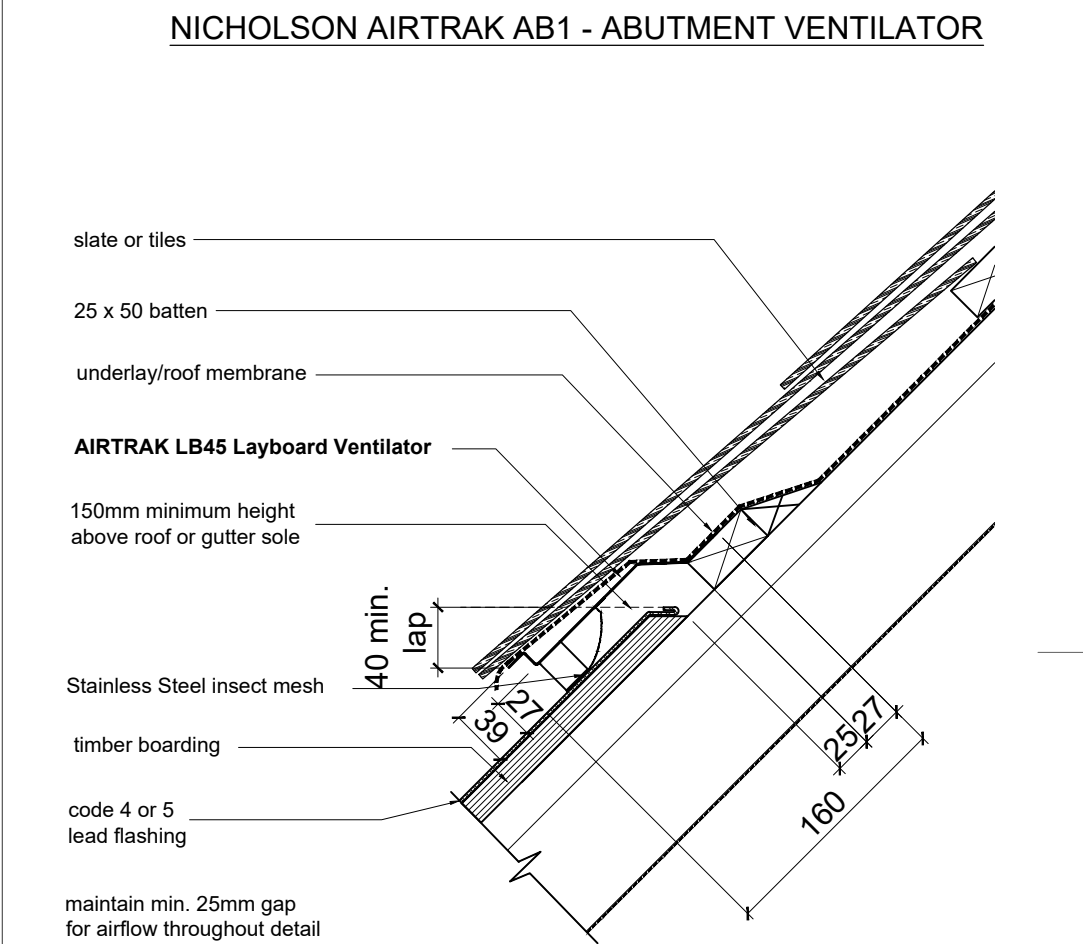
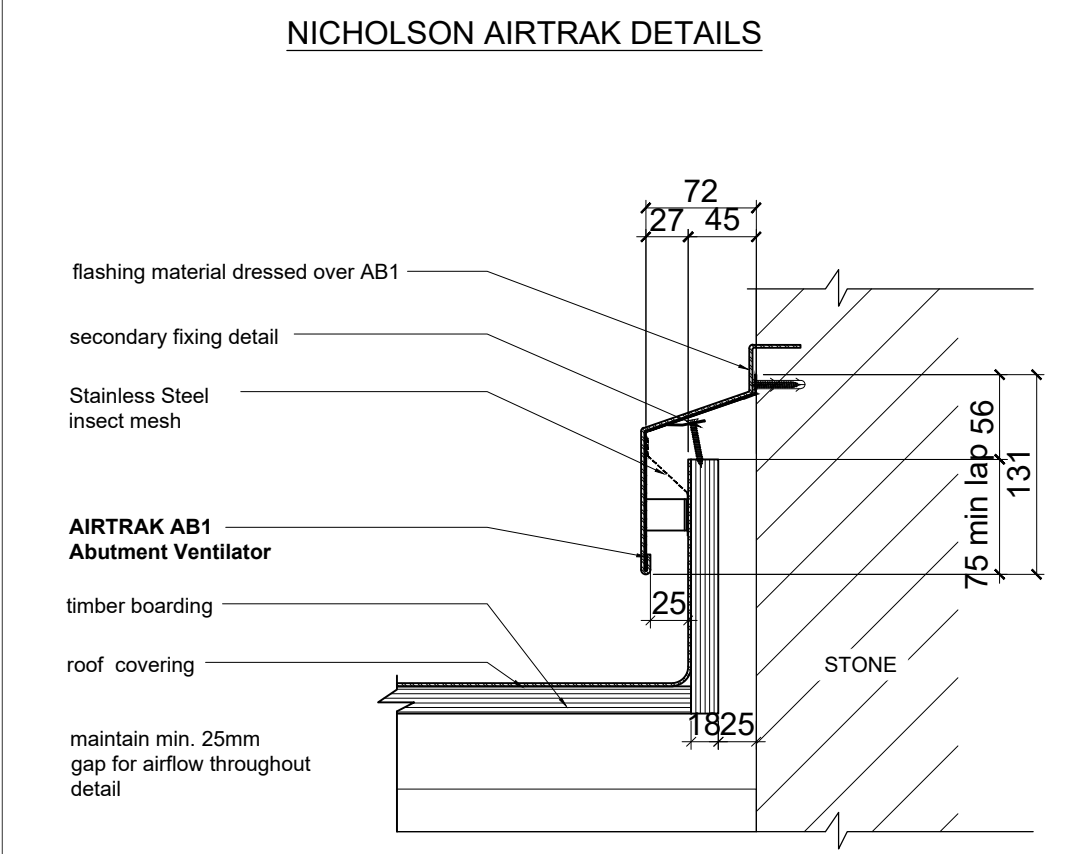

Notes:
 Code 8 Lead to be fitted by specialist Lead Contractor fully in accordance with Lead Contractors Association (LCA) & Lead Sheet Association (LSA) guidance.

PRELIMINARY

Revision Date Details

BRASENOSE COLLEGE

STAIRS III, IV, V & VI - BRASENOSE COLLEGE, OXFORD

EMERGENCY ROOF WORKS - TYPICAL DETAILS & STRATEGY

Sidleys
 CHARTERED SURVEYORS
 6 KING EDWARD STREET, OXFORD, OX1 4JL
 (01865) 726016 www.sidleys.co.uk

Date:	Drawn by:	Checked by:	Job No:	Drawing No:
JAN 2024	PT	DT	6-0897	03-P

