

SITE AND LOCATION PLAN

SCALE 1:1250

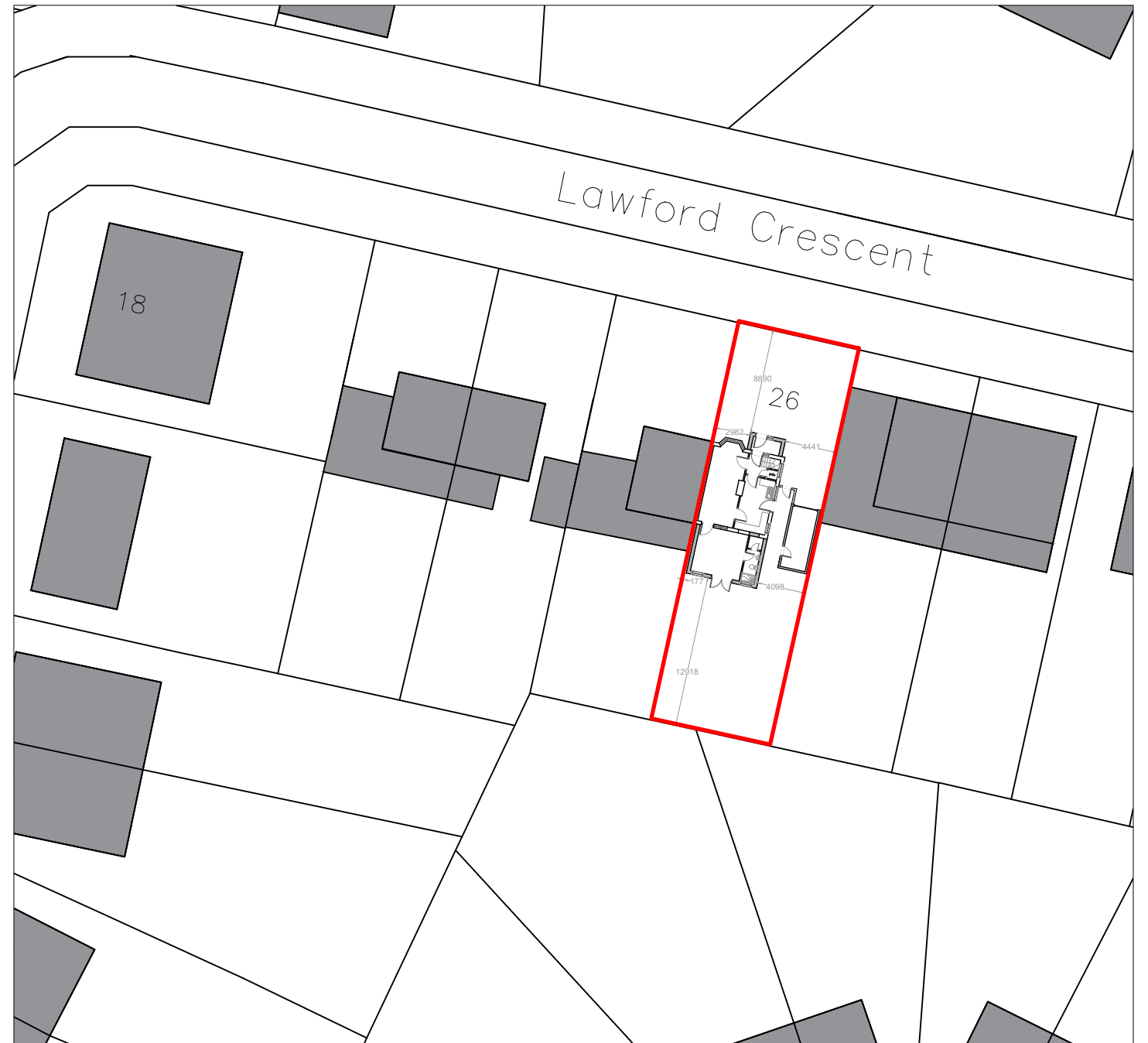

PROPOSED SITE PLAN

SCALE 1:500

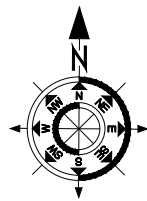

Rev	Description	Date
P1	Issued for Planning	10.04.24
P2	Revised drawings - HDC comments	20.04.24

Ref.	Revision	Date	By	MA ARCHITECTURE BA (Hons) Dip Arch		Project: Demolition of dining room and erection of a single storey rear extension and front porch extension at: 26 Lawford Crescent, Yateley, Hampshire, GU46 6JU		
				<small>ADDRESS 7 Chive Court, Farnborough Hampshire, GU14 9XE CONTACT Email: manmeet_auluck@hotmail.co.uk www.manmeetauluck.com 07766748725</small>		Scale: 1:1250 & 1:500 @ A3	Date: 10/04/2024	Drawn by: MA
						Client: Dawn Thorley	Job number: 0005	Drawing number: 1/5

ALL DIMENSIONS TO BE CHECKED ON SITE
ONLY TO BE SCALED FOR PLANNING